

| PLOT-A   |            |           |           |           |           |           |           |           |           |           |            |         |
|----------|------------|-----------|-----------|-----------|-----------|-----------|-----------|-----------|-----------|-----------|------------|---------|
| BLDG.NO. | GROUND FL. | 1st.FLOOR | 2nd.FLOOR | 3rd.FLOOR | 4th.FLOOR | 5th.FLOOR | 6th.FLOOR | 7th.FLOOR | 8th.FLOOR | 9th.FLOOR | 10th.FLOOR | TOTAL   |
| A        | 144.40     | 189.30    | 189.30    | 189.30    | 189.30    | 189.30    | 189.30    | 189.30    | 156.84    | 189.30    | 189.30     | 2004.94 |
| B        | 97.16      | 198.01    | 198.01    | 198.01    | 198.01    | 198.01    | 198.01    | 198.01    |           |           |            | 1483.23 |
| TOTAL    |            |           |           |           |           |           |           |           |           |           |            | 3488.17 |

| TOTAL PLOT AREA CALCULATION |                 |
|-----------------------------|-----------------|
| PLOT AREA                   | 9240.47 sq.mt.  |
| ROAD AREA                   | 3148.23 sq.mt.  |
| PRI. SCH. & PLAY GROUND     | 3943.48 sq.mt.  |
| GARDEN                      | 2318.00 sq.mt.  |
| TOTAL                       | 18650.18 sq.mt. |

| TOTAL R.G. AREA CALCULATION |                |
|-----------------------------|----------------|
| 1 R.G. AREA                 | 533.11 sq.mt.  |
| 2 R.G. AREA                 | 595.71 sq.mt.  |
| PROPOSED R.G. AREA          | 1128.82 sq.mt. |
| PHYSICAL R.G. REQUIRED      | 1670.06 sq.mt. |

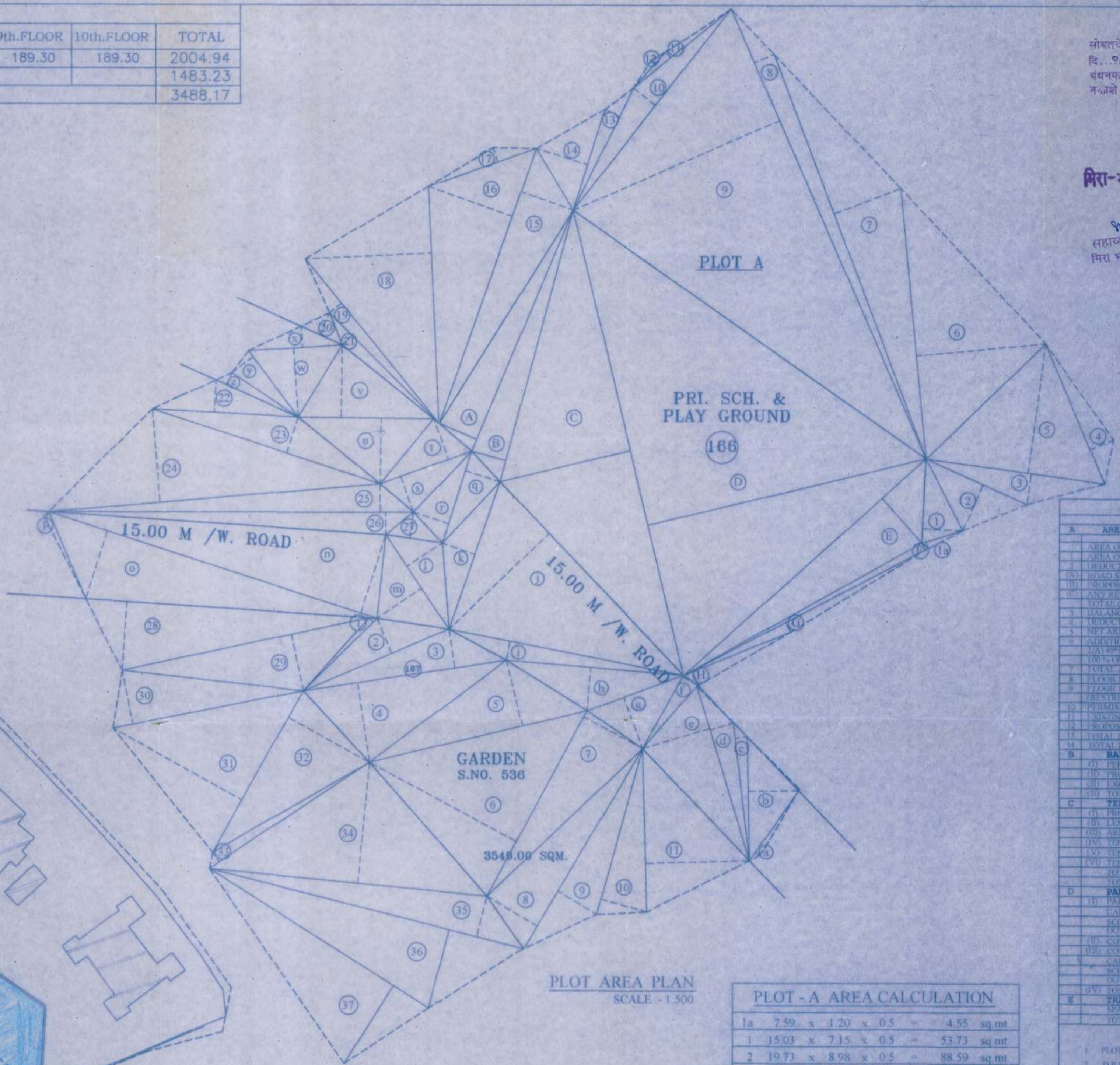
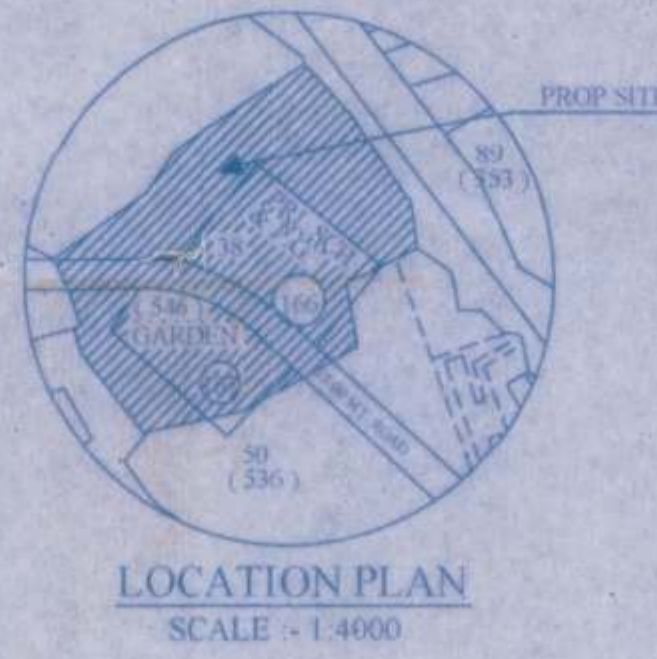

| AREA CALCULATION (ROAD) |                                     |
|-------------------------|-------------------------------------|
| a                       | 15.30 x 0.99 x 0.5 = 7.57 sq.mt.    |
| b                       | 22.15 x 8.98 x 0.5 = 99.45 sq.mt.   |
| c                       | 24.82 x 2.19 x 0.5 = 27.18 sq.mt.   |
| d                       | 32.66 x 4.36 x 0.5 = 71.20 sq.mt.   |
| e                       | 32.66 x 12.51 x 0.5 = 204.29 sq.mt. |
| f                       | 15.06 x 3.09 x 0.5 = 23.27 sq.mt.   |
| g                       | 18.46 x 9.82 x 0.5 = 90.64 sq.mt.   |
| h                       | 31.88 x 7.78 x 0.5 = 124.01 sq.mt.  |
| i                       | 42.84 x 3.44 x 0.5 = 73.68 sq.mt.   |
| j                       | 47.65 x 24.74 x 0.5 = 589.43 sq.mt. |
| k                       | 27.79 x 6.17 x 0.5 = 85.73 sq.mt.   |
| l                       | 20.23 x 7.55 x 0.5 = 76.37 sq.mt.   |
| m                       | 20.23 x 9.63 x 0.5 = 97.40 sq.mt.   |
| n                       | 61.64 x 14.69 x 0.5 = 452.25 sq.mt. |
| o                       | 61.64 x 12.69 x 0.5 = 391.10 sq.mt. |
| p                       | 16.84 x 1.05 x 0.5 = 8.84 sq.mt.    |
| q                       | 17.16 x 6.51 x 0.5 = 55.85 sq.mt.   |
| r                       | 17.16 x 6.54 x 0.5 = 56.11 sq.mt.   |
| s                       | 17.32 x 6.75 x 0.5 = 58.45 sq.mt.   |
| t                       | 17.32 x 7.66 x 0.5 = 66.33 sq.mt.   |
| u                       | 24.28 x 11.68 x 0.5 = 141.80 sq.mt. |
| v                       | 24.28 x 12.99 x 0.5 = 157.70 sq.mt. |
| w                       | 16.75 x 12.35 x 0.5 = 103.43 sq.mt. |
| x                       | 16.75 x 3.78 x 0.5 = 31.65 sq.mt.   |
| y                       | 14.73 x 4.79 x 0.5 = 35.28 sq.mt.   |
| z                       | 16.07 x 2.33 x 0.5 = 18.72 sq.mt.   |
| TOTAL                   | = 3148.23 sq.mt.                    |

| PRI. SCH. & PLAY GROUND AREA CALCULATION |                                      |
|--|--------------------------------------|
| A  | 46.64 x 7.29 x 0.5 = 170.00 sq.mt.   |
| B  | 50.13 x 6.33 x 0.5 = 158.66 sq.mt.   |
| C  | 85.24 x 23.95 x 0.5 = 1020.75 sq.mt. |
| D  | 85.24 x 51.07 x 0.5 = 2176.60 sq.mt. |
| E  | 38.02 x 10.69 x 0.5 = 310.11 sq.mt.  |
| F  | 49.21 x 1.33 x 0.5 = 32.72 sq.mt.    |
| G  | 49.21 x 1.94 x 0.5 = 47.73 sq.mt.    |
| H  | 20.62 x 2.61 x 0.5 = 26.91 sq.mt.    |
| TOTAL                                    | = 3943.48 sq.mt.                     |

| AREA CALCULATION (GARDEN) |                                     |
|---------------------------|-------------------------------------|
| 1                         | 18.42 x 1.04 x 0.5 = 9.58 sq.mt.    |
| 2                         | 28.22 x 6.76 x 0.5 = 95.38 sq.mt.   |
| 3                         | 36.67 x 7.01 x 0.5 = 128.53 sq.mt.  |
| 4                         | 36.67 x 14.50 x 0.5 = 266.85 sq.mt. |
| 5                         | 39.96 x 12.16 x 0.5 = 242.95 sq.mt. |
| 6                         | 37.70 x 29.79 x 0.5 = 561.54 sq.mt. |
| 7                         | 37.70 x 12.02 x 0.5 = 226.58 sq.mt. |
| 8                         | 41.63 x 10.41 x 0.5 = 216.68 sq.mt. |
| 9                         | 41.63 x 8.08 x 0.5 = 168.18 sq.mt.  |
| 10                        | 30.76 x 8.36 x 0.5 = 131.65 sq.mt.  |
| 11                        | 29.18 x 18.58 x 0.5 = 271.08 sq.mt. |
| TOTAL                     | = 2318.00 sq.mt.                    |

| PLOT - A AREA CALCULATION |                                      |
|---------------------------|--------------------------------------|
| 1a                        | 7.59 x 1.20 x 0.5 = 4.55 sq.mt.      |
| 1                         | 15.03 x 7.15 x 0.5 = 53.73 sq.mt.    |
| 2                         | 19.73 x 8.98 x 0.5 = 88.59 sq.mt.    |
| 3                         | 32.21 x 5.55 x 0.5 = 89.38 sq.mt.    |
| 4                         | 27.10 x 4.50 x 0.5 = 60.97 sq.mt.    |
| 5                         | 32.21 x 23.28 x 0.5 = 374.92 sq.mt.  |
| 6                         | 48.37 x 23.20 x 0.5 = 561.09 sq.mt.  |
| 7                         | 77.03 x 12.76 x 0.5 = 491.45 sq.mt.  |
| 8                         | 87.42 x 3.77 x 0.5 = 164.78 sq.mt.   |
| 9                         | 87.42 x 40.25 x 0.5 = 1759.32 sq.mt. |
| 10                        | 45.73 x 5.00 x 0.5 = 114.32 sq.mt.   |
| 11                        | 22.46 x 1.32 x 0.5 = 14.82 sq.mt.    |
| 12                        | 8.66 x 0.95 x 0.5 = 4.11 sq.mt.      |
| 13                        | 24.35 x 2.89 x 0.5 = 35.18 sq.mt.    |
| 14                        | 18.88 x 9.61 x 0.5 = 90.72 sq.mt.    |
| 15                        | 52.00 x 9.89 x 0.5 = 257.14 sq.mt.   |
| 16                        | 52.00 x 15.86 x 0.5 = 412.36 sq.mt.  |
| 17                        | 20.40 x 2.72 x 0.5 = 27.74 sq.mt.    |
| 18                        | 42.26 x 22.60 x 0.5 = 477.54 sq.mt.  |
| 19                        | 37.85 x 2.72 x 0.5 = 51.47 sq.mt.    |
| 20                        | 8.09 x 4.27 x 0.5 = 17.27 sq.mt.     |
| 21                        | 27.76 x 2.40 x 0.5 = 33.31 sq.mt.    |
| 22                        | 26.09 x 5.76 x 0.5 = 75.14 sq.mt.    |
| 23                        | 42.88 x 6.71 x 0.5 = 143.86 sq.mt.   |
| 24                        | 59.47 x 16.71 x 0.5 = 496.87 sq.mt.  |
| 25                        | 65.20 x 5.04 x 0.5 = 164.30 sq.mt.   |
| 26                        | 65.20 x 3.99 x 0.5 = 130.07 sq.mt.   |
| 27                        | 10.18 x 4.66 x 0.5 = 23.72 sq.mt.    |
| 28                        | 50.74 x 12.29 x 0.5 = 311.80 sq.mt.  |
| 29                        | 45.15 x 10.30 x 0.5 = 232.52 sq.mt.  |
| 30                        | 34.73 x 9.84 x 0.5 = 170.87 sq.mt.   |
| 31                        | 33.16 x 26.51 x 0.5 = 439.53 sq.mt.  |
| 32                        | 33.16 x 16.59 x 0.5 = 275.06 sq.mt.  |
| 33                        | 34.21 x 2.06 x 0.5 = 35.34 sq.mt.    |
| 34                        | 49.82 x 21.69 x 0.5 = 540.30 sq.mt.  |
| 35                        | 57.89 x 7.48 x 0.5 = 216.50 sq.mt.   |
| 36                        | 57.89 x 14.44 x 0.5 = 417.96 sq.mt.  |
| 37                        | 46.40 x 16.46 x 0.5 = 381.87 sq.mt.  |
| TOTAL                     | = 9240.47 sq.mt.                     |

सोबतचे पत्र क्र. निमावना/नर/... ०३१०७१०२०११  
 दि. ०३/१०/२०११ मधील अटी शर्ती  
 बंधनकारक राहून मूळ/सुधारित बोधकाय  
 मजगते (प्रारंभ पत्रासह) मंजूर.  
**मिरा-भाईंदर महानगरपालिका,**  
 सहायक निगर रचनाकार  
 मिरा भाईंदर महानगर पालिका



| FORM I |   |
|--------|---|
| A      | AREA STATEMENT                          |
| 1      | AREA OF PLOT                            |
| 2      | ROAD AREA                               |
| 3      | PRI. SCH. & PLAY GROUND                 |
| 4      | GARDEN                                  |
| 5      | TOTAL                                   |
| B      | BALCONY AREA STATEMENT                  |
| 1      | PERMISSIBLE BALCONY AREA PER FLOOR      |
| 2      | EXCESS BALCONY AREA PER FLOOR           |
| 3      | TOTAL EXCESS BALCONY AREA FOR ALL FLOOR |
| C      | TENEMENT STATEMENT                      |
| 1      | PERMISSIBLE TENEMENTS                   |
| 2      | EXCESS TENEMENTS                        |
| 3      | TOTAL EXCESS TENEMENTS                  |
| D      | PARKING STATEMENT                       |
| 1      | PARKING REQUIRED BY REGULATORS FOR      |
| 2      | SCOOTER / MOTOR CYCLE                   |
| 3      | OUT SIDERS (VISITORS)                   |
| 4      | CAR                                     |
| 5      | COVERED GARAGES PERMISSIBLE             |
| 6      | COVERED GARAGES PROPOSED                |
| 7      | TOTAL PARKING PROVIDED                  |
| 8      | EXCESS PARKING PROVIDED                 |
| 9      | TOTAL EXCESS PARKING PROVIDED           |

| FORM II  |            |
|--|------------|
| CONTENTS OF SHEET  |            |
| BLOCK PLAN, PLOT AREA CALC., PLOT AREA CALC., LOCATION PLAN, ROAD AREA CALC., PRI. SCH. & PLAY GROUND AREA CALC., GARDEN AREA CALC.  |            |
| REVISION   | DATE       |
| DESCRIPTION  | SIGNATURE  |
| CERTIFICATE OF AREA  |            |
| I hereby certify that the area shown in the block plan, plot area calculation, road area calculation, primary school and play ground area calculation and garden area calculation is correct and true. |            |
| SIGNATURE OF THE SURVEYOR  |            |
| SIGNATURE OF THE ARCHITECT   |            |
| SIGNATURE OF THE OWNER   |            |
| DATE   | SCALE      |
| DRWN BY  | CHECKED BY |
| ANISH & ASSOCIATES ARCHITECTS & ENGINEERS  |            |
| SHOP NO: 102, BHAYANDAR ROAD, BHAYANDAR [W]  |            |
| TEL: 2818992   |            |