

CONTENTS OF SHEETS

GR./ST.+POD/ST.(PT.)+2ND+17TH+18TH(PT.) FLOOR (TYPE - A & B)

PARKING PLANS.

STAMP OF APPROVAL OF PLAN

Plans are approved Subject to conditions Prescribed in Permit No. V.P.S.11/4032/17... TMCTD-DPT/1.9.61/16... 21/10/2016

Deputy Engineer (TDD)

Executive Engineer (TDD)

Thane Municipal Corporation The City of Thane

सावधान

मकानां बांधकाम न करणे वसेल विवेकास निमित्त नियमावलीनुसार आवश्यक त्या धरकनण्या न घेता बांधकाम वापर करणे, नगराष्ट प्रादेशिक व नगर रचना अधिनियमाचे कलम १२ अन्वये दंडात्मक गुन्हा आहे. त्यासाठी जास्तीत जास्त रक्कम वसूल करणे गरजेचे आहे.



STAMP OF RECEIPT OF PLAN

CERTIFICATE OF AREA

CERTIFIED THAT I HAVE SURVEYED THAT PLOT UNDER REFERENCE ON AND THAT THE DIMENSIONS OF SIDES, ETC. OF THE PLOT STATED ON THE PLAN ARE AS MEASURED ON SITE AND THE AREA SO WORKED OUT IS SQUARE METERS AND TAILLES WITH THE AREA STATED IN THE DOCUMENT OF OWNERSHIP TOWN PLANNING SCHEME RECORDS.

ARCHITECTS SIGNATURE

DESCRIPTION

PROPOSED LAYOUT ON PLOT BEARING :- S.NO-18/1, 18/2,17/18 AT VILLEGE,-PADLE, THANE

NAME & SIGNATURE OF OWNERS/POAH

FOR

M/S. ARIHANT SUPERSTRUCTURES LTD.

ARCHITECT

Anjagwanani  
**10 FOLDS**

ARCHITECTS & CONSULTANTS  
B-101, DEV CORPORA, OPP. CADBURY SIGNAL,  
THANE (W) 400 601. TEL. : 022-41008682 / 83 / 84  
EMAIL : 10FOLDSARCHITECTS@GMAIL.COM

SCALE DATE JOB NO. NORTH  
DRAWN BY CHECKED PATH

PODIUM CALCULATION

ADDITION:

1	15.35	X	7.71	X	0.5	X	1	=	59.13	SQMT
2	37.13	X	5.96	X	0.5	X	1	=	110.65	SQMT
3	37.13	X	10.48	X	0.5	X	1	=	194.56	SQMT
4	23.71	X	14.95	X	0.5	X	1	=	177.23	SQMT
5	18.39	X	9.21	X	0.5	X	1	=	84.69	SQMT
6	22.85	X	11.32	X	0.5	X	1	=	129.33	SQMT
7	24.46	X	12.81	X	0.5	X	1	=	156.67	SQMT
8	24.46	X	5.45	X	0.5	X	1	=	66.65	SQMT
9	24.19	X	7.04	X	0.5	X	1	=	85.15	SQMT
10	22.10	X	4.09	X	0.5	X	1	=	45.19	SQMT
11	3.76	X	2.21	X	1	X	1	=	8.31	SQMT
12	1.10	X	0.60	X	1	X	1	=	0.66	SQMT
13	20.97	X	3.27	X	0.5	X	1	=	34.29	SQMT
14	20.97	X	4.86	X	0.5	X	1	=	50.96	SQMT
15	27.38	X	9.96	X	0.5	X	1	=	136.35	SQMT
16	15.15	X	5.59	X	0.5	X	1	=	42.34	SQMT
17	30.66	X	3.15	X	0.5	X	1	=	48.29	SQMT
18	34.86	X	5.47	X	0.5	X	1	=	95.34	SQMT
19	36.98	X	20.33	X	0.5	X	1	=	375.90	SQMT
20	12.71	X	0.45	X	1	X	1	=	5.72	SQMT
21	36.98	X	6.16	X	0.5	X	1	=	113.90	SQMT
22	33.92	X	3.76	X	0.5	X	1	=	63.77	SQMT
23	5.74	X	1.14	X	0.5	X	1	=	3.27	SQMT
24	1.17	X	0.45	X	1	X	1	=	0.53	SQMT
25	6.34	X	1.58	X	0.5	X	1	=	5.01	SQMT
26	6.92	X	0.89	X	0.5	X	1	=	3.08	SQMT
27	1.10	X	0.58	X	0.5	X	1	=	0.32	SQMT
28	28.72	X	6.70	X	0.5	X	1	=	96.21	SQMT
29	28.72	X	1.82	X	0.5	X	1	=	26.14	SQMT
30	29.23	X	1.36	X	0.5	X	1	=	19.88	SQMT
31	31.30	X	11.41	X	0.5	X	1	=	178.57	SQMT
32	12.80	X	2.64	X	0.5	X	1	=	16.90	SQMT
33	8.84	X	2.02	X	0.67	X	1	=	11.96	SQMT
<b>TOTAL PARKING AREA</b>									<b>2446.95</b>	<b>SQMT</b>

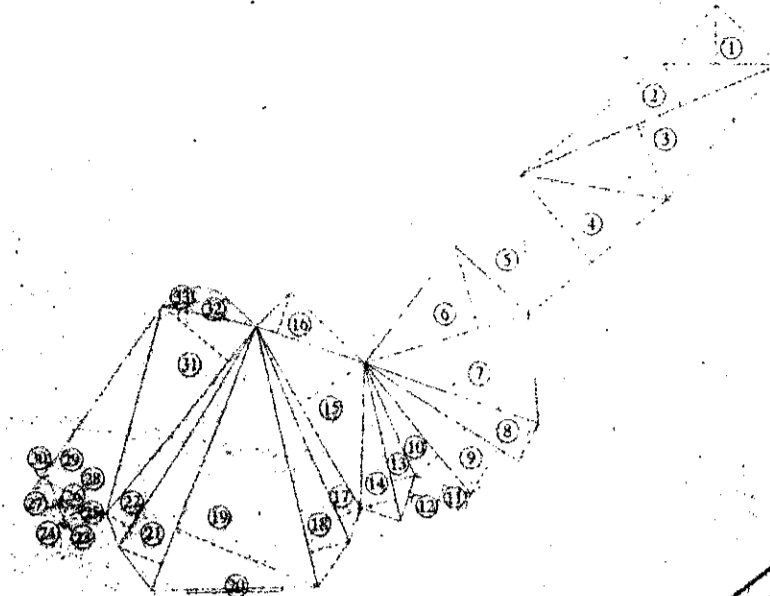

PODIUM AREA DIAGRAM  
SCALE - 1:1000

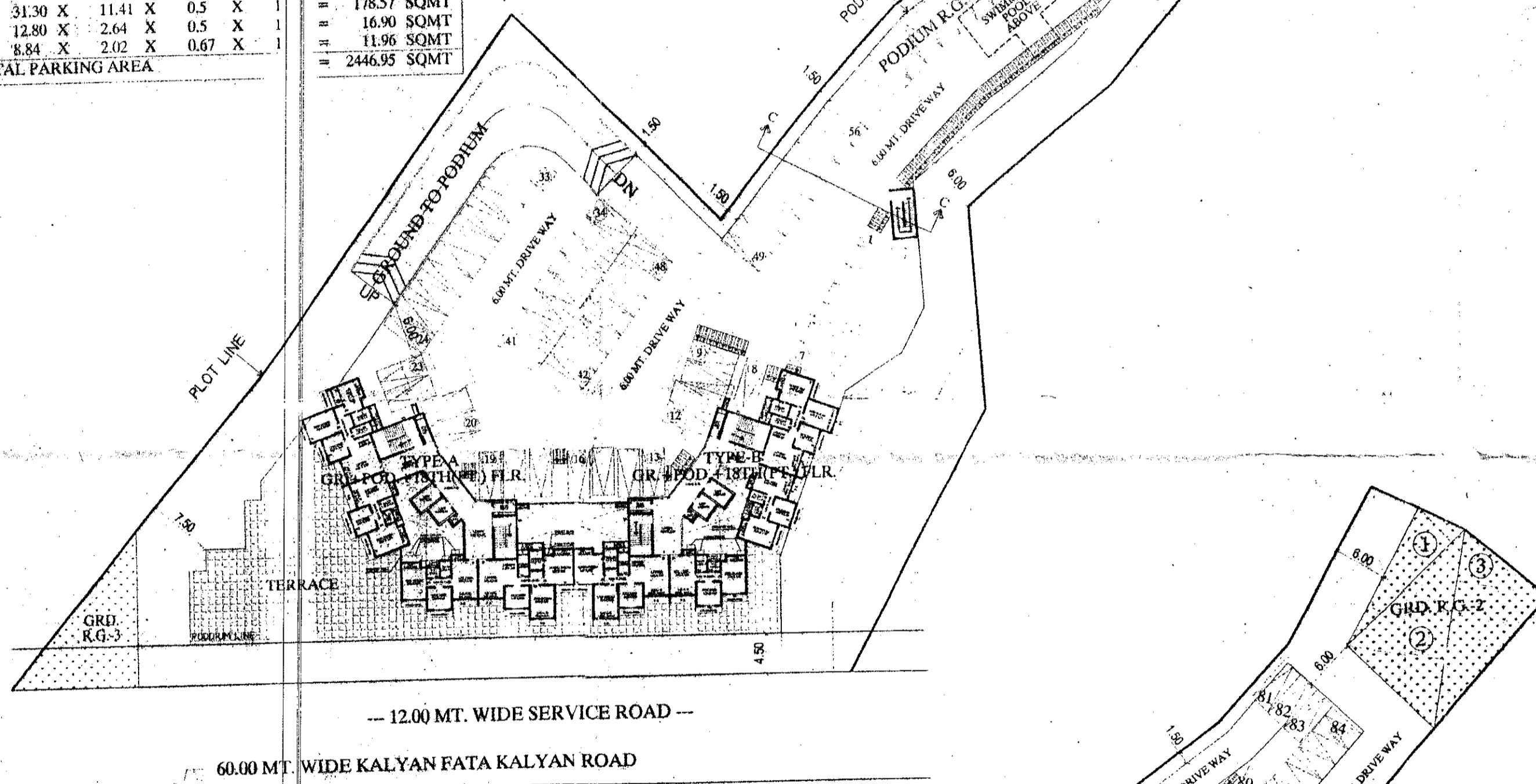

1ST FLOOR & PODIUM FLOOR PLAN (PARKING)  
SCALE - 1:500  
PARKING PROVIDED ON PODIUM FLOOR = 74 NOS.

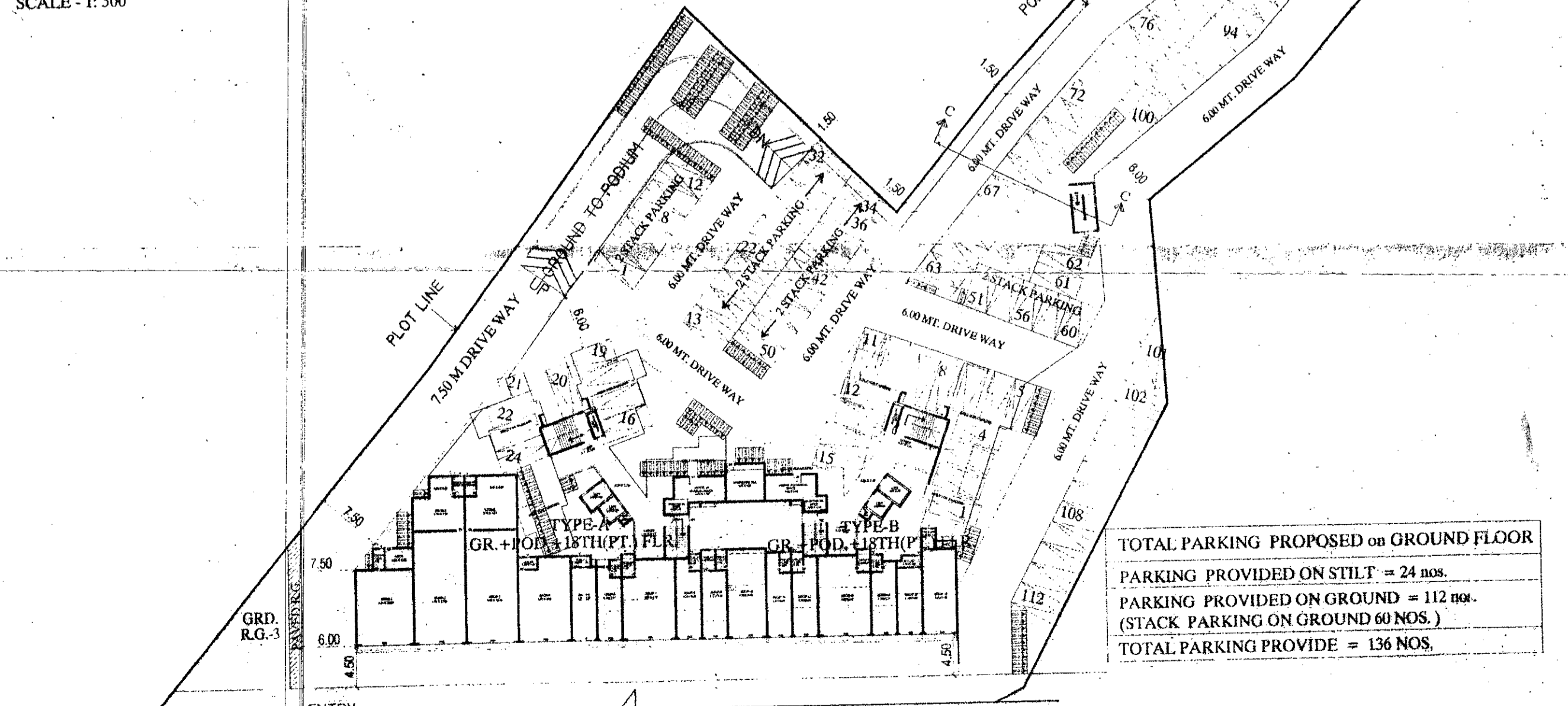

GROUND FLOOR (PARKING FLOOR PLAN)  
SCALE - 1:500

TOTAL PARKING PROPOSED ON GROUND FLOOR  
PARKING PROVIDED ON STILT = 24 NOS.  
PARKING PROVIDED ON GROUND = 112 NOS.  
(STACK PARKING ON GROUND 60 NOS.)  
TOTAL PARKING PROVIDE = 136 NOS.