

PLOT AREA CALCULATION

1	1/2 x 92.88 x 62.03 x 1NO	= 2880.67 SQ.MT.
2	1/2 x 64.30 x 19.39 x 1NO	= 623.39 SQ.MT.
3	1/2 x 94.80 x 4.28 x 1NO	= 208.51 SQ.MT.
4	1/2 x 94.80 x 0.78 x 1NO	= 36.97 SQ.MT.
5	1/2 x 0.90 x 0.32 x 1NO	= 0.14 SQ.MT.
6	1/2 x 131.40 x 38.60 x 1NO	= 2539.98 SQ.MT.
7	1/2 x 131.40 x 49.50 x 1NO	= 3252.15 SQ.MT.
8	1/2 x 60.39 x 12.54 x 1NO	= 508.06 SQ.MT.
9	1/2 x 15.17 x 0.90 x 1NO	= 4.56 SQ.MT.
10	1/2 x 14.84 x 2.78 x 1NO	= 20.23 SQ.MT.
11	1/2 x 189.09 x 76.00 x 1NO	= 6959.86 SQ.MT.
12	1/2 x 189.37 x 60.17 x 1NO	= 5717.43 SQ.MT.
13	1/2 x 108.80 x 64.07 x 1NO	= 3480.00 SQ.MT.
14	1/2 x 91.52 x 23.05 x 1NO	= 857.16 SQ.MT.
15	1/2 x 28.49 x 12.30 x 1NO	= 174.79 SQ.MT.
16	1/2 x 81.04 x 2.19 x 1NO	= 88.74 SQ.MT.
17	1/2 x 28.49 x 13.38 x 1NO	= 150.60 SQ.MT.
18	1/2 x 188.87 x 7.75 x 1NO	= 730.71 SQ.MT.
19	1/2 x 152.84 x 49.40 x 1NO	= 3775.15 SQ.MT.
20	1/2 x 157.14 x 14.08 x 1NO	= 1106.27 SQ.MT.
21	1/2 x 10.87 x 8.43 x 1NO	= 45.92 SQ.MT.
22	1/2 x 10.87 x 8.43 x 1NO	= 45.92 SQ.MT.
TOTAL ADDITION		= 38516.35 SQ.MT.

SETBACK AREA CALCULATION

1	1/2 x 93.28 x 6.11 x 1NO	= 284.91 SQ.MT.
2	1/2 x 123.05 x 4.09 x 1NO	= 251.85 SQ.MT.
3	1/2 x 23.32 x 0.91 x 1NO	= 10.61 SQ.MT.
4	1/2 x 23.32 x 1.24 x 1NO	= 14.45 SQ.MT.
5	1/2 x 23.34 x 0.33 x 1NO	= 3.85 SQ.MT.
6	1/2 x 50.10 x 4.66 x 1NO	= 116.73 SQ.MT.
7	1/2 x 22.53 x 4.48 x 1NO	= 50.46 SQ.MT.
8	1/2 x 5.07 x 0.04 x 1NO	= 0.82 SQ.MT.
9	1/2 x 7.09 x 3.91 x 1NO	= 13.86 SQ.MT.
10	1/2 x 8.89 x 2.19 x 1NO	= 9.73 SQ.MT.
11	1/2 x 5.68 x 1.81 x 1NO	= 4.35 SQ.MT.
12	1/2 x 4.85 x 2.63 x 1NO	= 6.38 SQ.MT.
13	1/2 x 4.49 x 1.51 x 1NO	= 3.39 SQ.MT.
14	1/2 x 3.98 x 0.40 x 1NO	= 0.79 SQ.MT.
TOTAL ADDITION		= 779.98 SQ.MT.

SETBACK AREA DIAGRAM
SCALE - 1:500

MCGM AREA CALCULATION

1)	1/2 x 28.63 x 13.06 x 1NO	= 173.89 SQ.MT.
2)	1/2 x 28.63 x 13.36 x 1NO	= 177.88 SQ.MT.
3)	1/2 x 78.46 x 21.06 x 1NO	= 829.63 SQ.MT.
4)	1/2 x 78.46 x 20.53 x 1NO	= 784.85 SQ.MT.
5)	1/2 x 81.36 x 8.08 x 1NO	= 328.82 SQ.MT.
6)	1/2 x 81.36 x 8.27 x 1NO	= 340.00 SQ.MT.
TOTAL ADDITION		= 2368.82 SQ.MT.

MHADA AREA CALCULATION

1)	1/2 x 61.86 x 22.41 x 1NO	= 694.28 SQ.MT.
2)	1/2 x 69.03 x 7.21 x 1NO	= 248.85 SQ.MT.
3)	1/2 x 69.71 x 0.24 x 1NO	= 8.69 SQ.MT.
4)	1/2 x 18.13 x 8.11 x 1NO	= 62.58 SQ.MT.
5)	1/2 x 15.09 x 4.50 x 1NO	= 33.96 SQ.MT.
6)	1/2 x 17.06 x 2.79 x 1NO	= 23.80 SQ.MT.
7)	1/2 x 18.82 x 11.99 x 1NO	= 110.00 SQ.MT.
8)	1/2 x 13.33 x 8.73 x 1NO	= 36.19 SQ.MT.
9)	1/2 x 12.83 x 1.33 x 1NO	= 4.90 SQ.MT.
TOTAL ADDITION		= 1038.12 SQ.MT.

LOCATION PLAN
SCALE - 1:2500

MCGM AREA DIAGRAM
SCALE - 1:500

MHADA AREA DIAGRAM
SCALE - 1:500

SUBDIVISION

PLOT	AREA (SQ.MT.)
A	MHADA 1938.12
B	MCGM 2368.82
C	38516.35
TOTAL	42823.29

PLOT AREA DIAGRAM
SCALE - 1:500

REQUIRED R.G. AREA 25% ON NET PLOT
25% OF 38516.35 = 9629.09 SQ.MT.
PROVIDED R.G. AREA = 9629.09 SQ.MT.

SUMMARY OF R.G. AREA CALCULATION

REQUIRED R.G. AREA	9629.09	SQ.MT.
R.G. ON GROUND	6340.80	SQ.MT.
RG AREA - 1	3288.29	SQ.MT.
RG AREA - 2	6340.80	SQ.MT.
TOTAL PROVIDED R.G.	9629.09	SQ.MT.

CLUB HOUSE AREA STATEMENT IN SQ.MT.

25% R.G. AREA REQUIRED	9629.09
PRO. R.G. AREA	6340.80
PROVIDED R.G. AREA	9629.09
10% CLUB HOUSE ON GROUND FLR.	328.83
5% ON 1ST FLOOR	164.41
TOTAL 15% CLUB HOUSE ON R.G.	493.24
25% R.G. AREA REQUIRED	9629.09
PRO. R.G. AREA	6340.80
PROVIDED R.G. AREA	9629.09

100' SANCTIONED R.L.

100' GANPATRAO KADAM MARG

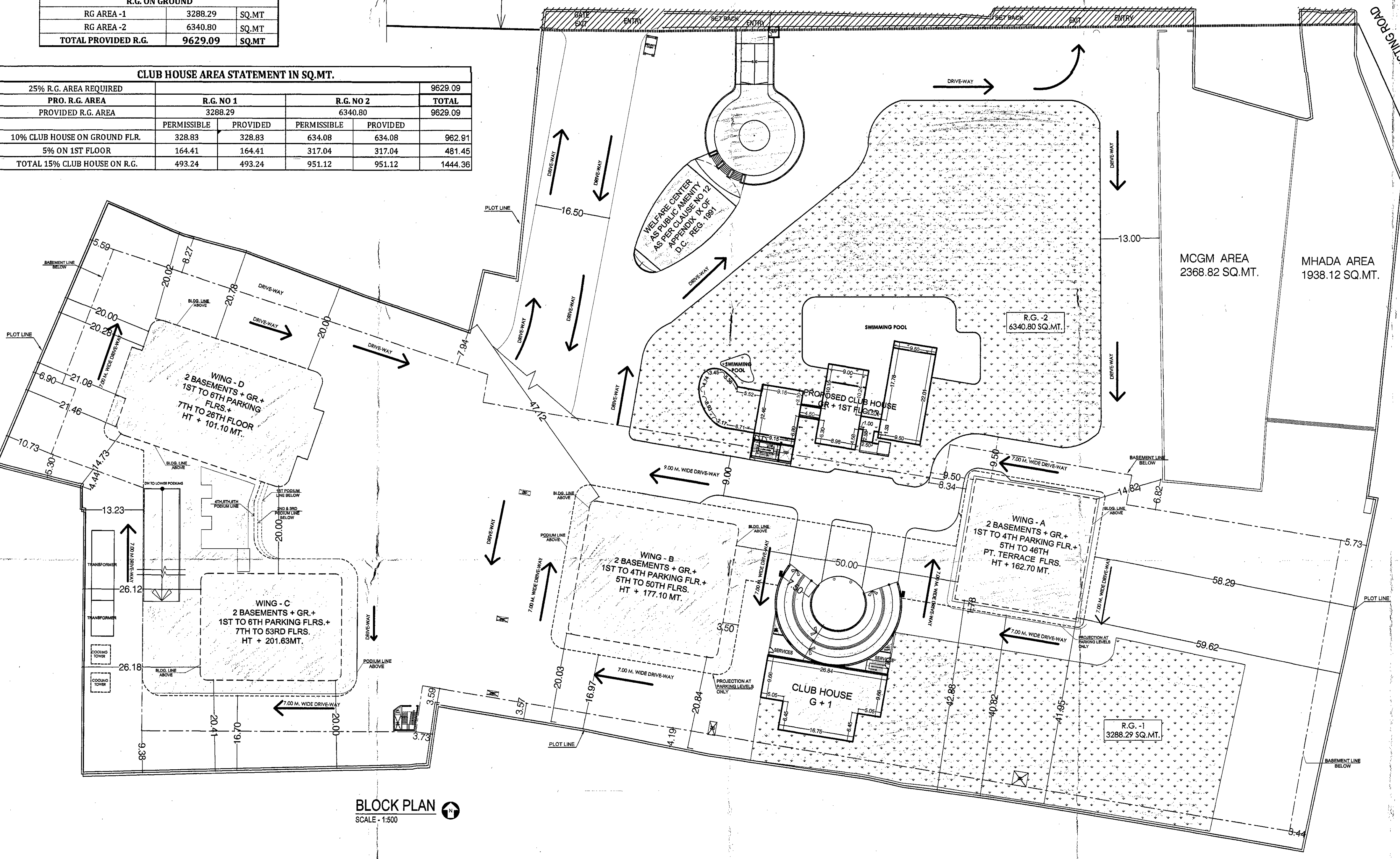

REFUGEE AREA STATEMENT (WING - A)

FLOOR	REQUIRED	PROVIDED
7TH FL.	138.04	138.04
14TH FL.	137.75	137.75
23RD FL.	137.32	137.32
30TH FL.	137.96	137.96
37TH FL.	123.95	123.95

REFUGEE AREA STATEMENT (WING - B)

FLOOR	REQUIRED	PROVIDED
7TH FL.	185.35	185.35
14TH FL.	185.35	185.35
23RD FL.	185.35	185.35
30TH FL.	185.27	185.27
37TH FL.	187.09	187.09
46TH FL.	87.19	87.19

REFUGEE AREA STATEMENT (WING - C)

FLOOR	REQUIRED	PROVIDED
8TH FL.	140.26	140.26
15TH FL.	140.25	140.25
24TH FL.	140.44	140.44
31ST FL.	138.45	138.45
40TH FL.	139.84	139.84
47TH FL.	107.69	107.69

REFUGEE AREA STATEMENT (WING - D)

FLOOR	REQUIRED	PROVIDED
8TH FLOOR	126.13	126.13
15TH FLOOR	141.58	141.58
24TH FLOOR	38.96	38.96

BUILT UP AREA SUMMARY RESIDENTIAL WING - A

NO. OF FLOORS	NET BUA AREA	GROSS BUA AREA
2nd BASEMENT	-	-
1st BASEMENT	-	-
GROUND FLOOR	5.52	7.45
1st PARKING FLOOR	-	-
2nd PARKING FLOOR	-	-
3rd PARKING FLOOR	-	-
4th PARKING FLOOR	-	-
5th SERVICE FLOOR	-	-
6th FLOOR	379.56	512.41
7th FLOOR (PART REFUGE)	278.90	376.51
8th FLOOR	379.56	512.41
9th FLOOR	379.56	512.41
10th FLOOR	379.56	512.41
11th FLOOR	379.56	512.41
12th FLOOR	379.56	512.41
13th FLOOR	379.56	512.41
14th FLOOR (PART REFUGE)	278.96	376.60
15th FLOOR	379.56	512.41
16th FLOOR	379.56	512.41
17th FLOOR	379.56	512.41
18th FLOOR	379.56	512.41
19th SERVICE FLOOR	-	-
20th FIRE CHECK FLOOR	-	-
21st FLOOR	377.72	509.92
22nd FLOOR	377.72	509.92
23rd FLOOR (PART REFUGE)	277.30	374.35
24th FLOOR	377.72	509.92
25th FLOOR	377.72	509.92
26th FLOOR	377.72	509.92
27th FLOOR	377.72	509.92
28th FLOOR	377.72	509.92
29th FLOOR	377.72	509.92
30th FLOOR (PART REFUGE)	276.56	373.36
31st FLOOR	377.62	509.79
32nd FLOOR	377.62	509.79
33rd FLOOR	377.62	509.79
34th FLOOR	377.62	509.79
35th FLOOR	377.62	509.79
36th FLOOR	377.62	509.79
37th FLOOR (PART REFUGE)	277.21	369.92
38th FLOOR	377.62	509.79
39th SERVICE FLOOR	0.00	0.00
40th FIRE CHECK FLOOR	0.00	0.00
41st FLOOR	377.65	509.83
42nd LOWER DUPLEX FLOOR	377.64	509.81
43rd UPPER DUPLEX FLOOR	373.07	503.64
44th LOWER DUPLEX FLOOR	377.64	509.81
45th UPPER DUPLEX FLOOR	373.19	503.80
46th FT. TERRACE FLOOR	38.58	52.08
TOTAL AREA	13162.50	17769.37

BUILT UP AREA SUMMARY RESIDENTIAL WING - B

NO. OF FLOORS	NET BUA AREA	GROSS BUA AREA
2nd BASEMENT	-	-
1st BASEMENT	-	-
GROUND FLOOR	8.67	11.70
1st PARKING FLOOR	-	-
2nd PARKING FLOOR	-	-
3rd PARKING FLOOR	-	-
4th PARKING FLOOR	-	-
5th FLOOR (SERVICE FLOOR)	-	-
6th FLOOR	598.50	686.47
7th FLOOR (PART REFUGE)	381.35	514.62
8th FLOOR	598.50	686.47
9th FLOOR	598.50	686.47
10th FLOOR	598.50	686.47
11th FLOOR	598.50	686.47
12th FLOOR	598.50	686.47
13th FLOOR	598.50	686.47
14th FLOOR (PART REFUGE)	381.35	514.62
15th FLOOR	598.50	686.47
16th FLOOR	598.50	686.47
17th FLOOR	598.50	686.47
18th FLOOR	598.50	686.47
19th FLOOR (SERVICE FLOOR)	-	-
20th FLOOR (FIRE CHECK FLR.)	-	-
21st FLOOR	598.50	686.47
22nd FLOOR	598.50	686.47
23rd FLOOR (PART REFUGE)	381.47	514.99
24th FLOOR	598.50	686.47
25th FLOOR	598.50	686.47
26th FLOOR	598.50	686.47
27th FLOOR	598.50	686.47
28th FLOOR	598.50	686.47
29th FLOOR	598.50	686.47
30th FLOOR (PART REFUGE)	381.30	514.76
31st FLOOR	598.50	686.47
32nd FLOOR	598.50	686.47
33rd FLOOR	598.50	686.47
34th FLOOR	598.50	686.47
35th FLOOR	598.50	686.47
36th FLOOR	598.50	686.47
37th FLOOR (PART REFUGE)	379.96	512.94
38th FLOOR	598.73	686.79
39th FLOOR (SERVICE FLOOR)	-	-
40th FLOOR (FIRE CHECK FLOOR)	-	-
41st FLOOR	507.82	685.56
42nd FLOOR	507.63	685.30
43rd FLOOR	507.63	685.30
44th LOWER DUPLEX FLOOR	301.75	677.36
45th UPPER DUPLEX FLOOR	484.17	653.63
46th LOWER FLOOR	444.98	603.42
47th UPPER DUPLEX FLOOR	483.04	652.10
48th LOWER DUPLEX FLOOR	501.76	677.38
49th UPPER DUPLEX FLOOR	483.30	652.46
50th UPPER DUPLEX FLOOR	146.61	197.93
TOTAL AREA	19706.04	26603.15

BUILT UP AREA SUMMARY RESIDENTIAL WING - C

NO. OF FLOORS	NET BUA AREA	GROSS BUA AREA
2nd BASEMENT	-	-
1st BASEMENT	-	-
GROUND FLOOR	-	-
1st PARKING FLOOR	-	-
2nd PARKING FLOOR	-	-
3rd PARKING FLOOR	-	-
4th PARKING FLOOR	-	-
5th PARKING FLOOR	-	-
6th PARKING FLOOR	-	-
7th SERVICE FLOOR	-	-
8th FLOOR (PART REFUGE)	287.55	388.19
9th FLOOR	384.98	519.72
10th FLOOR	384.98	519.72
11th FLOOR	384.98	519.72
12th FLOOR	384.98	519.72
13th FLOOR	384.98	519.72
14th FLOOR	384.98	519.72
15th FLOOR (PART REFUGE)	287.55	388.19
16th FLOOR	384.98	519.72
17th FLOOR	384.98	519.72
18th SERVICE FLOOR	0.00	0.00
19th FIRE CHECK FLOOR	0.00	0.00
20th FLOOR	384.98	519.72
21st FLOOR	384.98	519.72
22nd FLOOR	384.98	519.72
23rd FLOOR	384.98	519.72
24th FLOOR (PART REFUGE)	287.47	388.00
25th FLOOR	384.98	519.72
26th FLOOR	384.98	519.72
27th FLOOR	384.98	519.72
28th FLOOR	384.98	519.72
29th FLOOR	384.98	519.72
30th FLOOR	384.98	519.72
31st FLOOR (PART REFUGE)	290.82	392.61
32nd LOWER DUPLEX FLOOR	381.69	515.28
33rd UPPER DUPLEX FLOOR	381.69	515.28
34th LOWER DUPLEX FLOOR	381.69	515.28
35th UPPER DUPLEX FLOOR	371.21	501.14
36th SERVICE FLOOR	0.00	0.00
37th FIRE CHECK FLOOR	0.00	0.00
38th FLOOR	384.98	519.72
39th FLOOR (PART REFUGE)	288.19	388.19
40th FLOOR (PART REFUGE)	288.19	388.19
41st FLOOR	381.69	515.28
42nd LOWER DUPLEX FLOOR	377.70	501.80
43rd UPPER DUPLEX FLOOR	381.69	515.28
44th LOWER DUPLEX FLOOR	377.70	501.80
45th UPPER DUPLEX FLOOR	381.69	515.28
46th FLOOR	388.80	524.88
47th FLOOR (PART REFUGE)	302.03	417.19
48th FLOOR (HOUSE FLOOR L1)	388.80	524.88
49th FLOOR (HOUSE FLOOR L2)	378.27	506.82
50th FLOOR (HOUSE FLOOR L3)	381.69	515.28
51st FLOOR (HOUSE FLOOR L4)	377.27	502.56
52nd FLOOR (HOUSE FLOOR L5)	387.09	524.88
53rd FLOOR (HOUSE FLOOR L6)	381.69	515.28
TOTAL	16289.39	20660.18

TOTAL WELFARE CENTER AS PUBLIC AMENITY AREA STATEMENT

WING	FLOOR	SQ.MT
REQUIRED AREA (38516.35 X 8%)	GROUND FLOOR	1925.82
WING - D	8TH FLOOR	288.87
WING - A	2ND FLOOR	83.89
WING - D	9TH FLOOR	307.74
WING - D	10TH FLOOR	311.38
WING - D	11TH FLOOR	311.38
WING - D	12TH FLOOR	311.38
PROPOSED AREA		1828.82

RESIDENTIAL PARKING STATEMENT

AREA	PARK. REQD.	NO OF FLATS	PERM. PARK.
BELOW 35.00 SQ.MT.	1 FOR 4 FLATS	-	-
35.00 TO 45.00 SQ.MT.	1 FOR 2 FLATS	-	-
45.00 TO 70.00 SQ.MT.	1 FOR 1 FLAT	-	-
ABOVE 70.00 SQ.MT.	2 FOR 1 FLAT	334	668
TOTAL			334
25% FOR VISITORS PARKING			167
TOTAL PARKING REQUIRED			835
ADD 25% EXTRA AS PERMISSIBLE UNDER D.C.R. 36			208
TOTAL PERMISSIBLE PARKING			1043
TOTAL PARKING PROVIDED			1043

RESIDENTIAL PARKING STATEMENT

NO. OF FLOORS

PROPOSED LAYOUT

← GANPATRAO KADAM MARG →

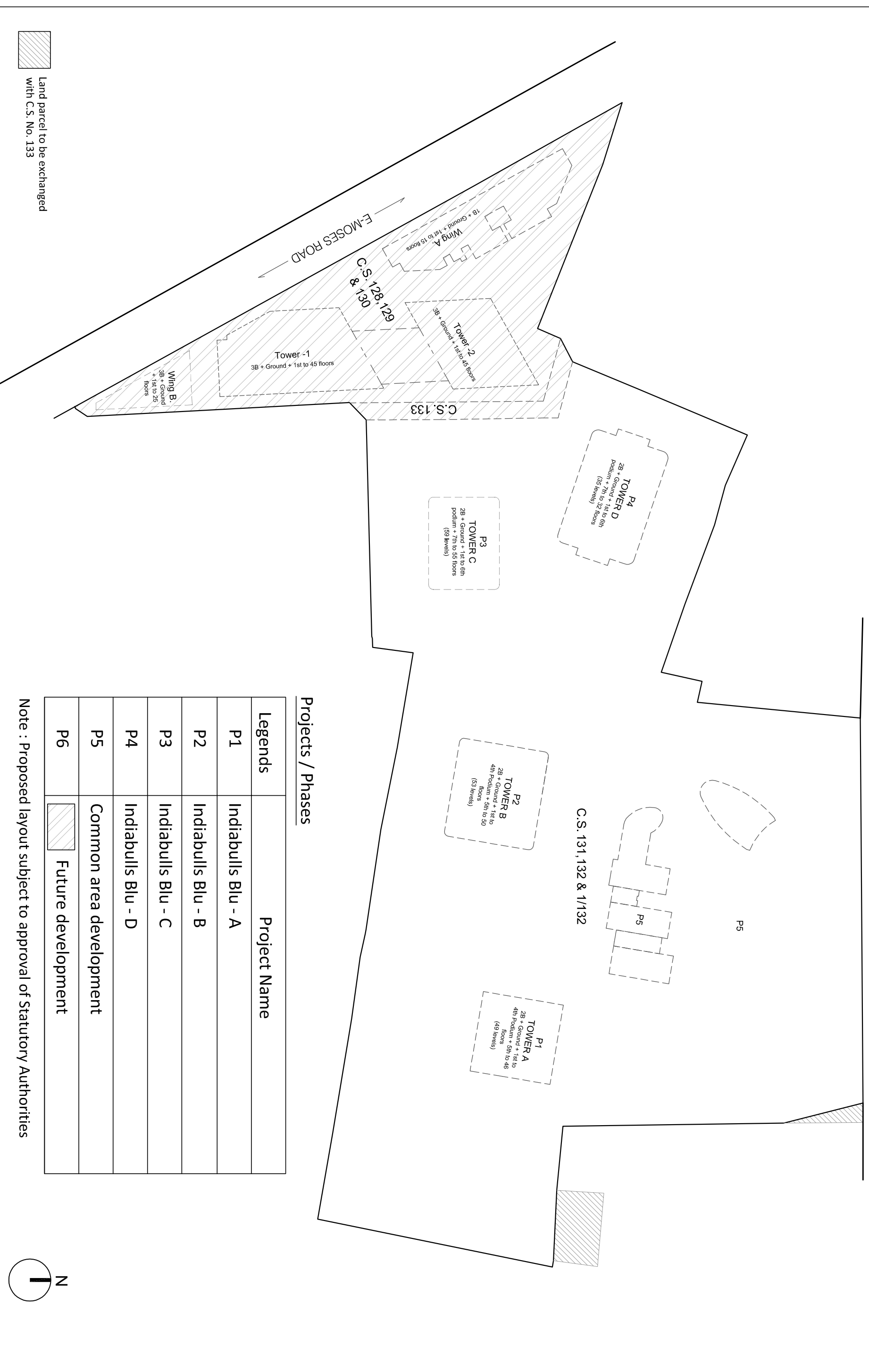

Projects / Phases

Legends	Project Name
P1	Indiabulls Blu - A
P2	Indiabulls Blu - B
P3	Indiabulls Blu - C
P4	Indiabulls Blu - D
P5	Common area development
P6	Future development

Note : Proposed layout subject to approval of Statutory Authorities

Land parcel to be exchanged with C.S. No. 133

