

बांधकाम नकाशे मंजूरी
 रंगाने दुर्लक्षी दाखविल्याप्रमाणे व बांधकाम प्रारंभ
 प्रमाणपत्र क्र. कडोमपा / तरवि / बांध / कनि - २०१६ - १०१४३
 दिनांक २६/०७/२०१६
 दिवेल्या अडिगमाणे,



नगर एकाधिकार
 कल्याण डोंदिवली नगरपालिका

PROFORMA - I

A. AREA STATEMENT		AREA (IN SQ.MT.)
1	a AREA OF PLOT AS PER 7/12	2120.00
	b AREA OF PLOT AS PER POSSESSION	1989.75
2	DEDUCTION FOR	
	a 15.00 M ROAD SET BACK AREA	-
	b P.S. RESERVATION ANY	-
	c GREEN ZONE ANY	-
	d RESERVATION ANY	-
	TOTAL (a+b+c+d)	-
3	BALANCE AREA PLOT (1b MINUS 2)	1989.75
4	DEDUCTION (IF DEDUCTIBLE)	
	a FOR RECREATIONAL GROUND 15% LESS	-
5	NET AREA PLOT (3 MINUS 4)	1989.75
6	ADDITIONS FOR FLOOR SPACE INDEX	
	2a) ROAD SET BACK AREA	-
	2b) 100% ANY RESERVATION	-
7	TOTAL AREA PLOT (5 PLUS 6)	1989.75
8	FLOOR SPACE INDEX PERMISSIBLE	1.00
9	FLOOR SPACE INDEX CREDIT AVAILABLE BY DEVELOPMENT RIGHTS (RESTRICTED TO 65% OF THE BALANCE AREA VIDE ITEM 3 ABOVE)	
10	PERMISSIBLE FLOOR AREA (62a+6+9) ABOVE	1989.75
11	EXCESS STRUCTURE AREA	-
12	PROPOSED FLOOR AREA	1925.18
13	EXCESS BALCONY AREA TAKEN IN TO F.S.I.	-
14	TOTAL BUILT AREA PROPOSED (11+12+13)	1925.18
15	FLOOR SPACE INDEX CONSUMED	
B BALCONY STATEMENT		
	PERMISSIBLE BALCONY AREA PER FLOOR -	-
	PROPOSED BALCONY AREA PER FLOOR	-
	EXCESS BALCONY AREA PER FLOOR	SHOWN IN TABLE
	TOTAL EXCESS BALCONY AREA ALL FLOORS	-
C TENEMENT STATEMENT		
	PROPOSED AREA (ITEM A-12 ABOVE)	1925.18
	LESS DEDUCTION OF NON-RESIDENTIAL AREA (SHOP ETC.)	-
	AREA AVAILABLE FOR TENEMENTS (1 MINUS II)	1925.18
	TENEMENTS PERMISSIBLE (DENSITY OF TENEMENTS/HECTORE)	56
	TENEMENTS PROPOSED	42 FLAT
	TENEMENTS EXISTING	-
	TOTAL TENEMENTS ON THE PLOT	42 FLAT
	TRANSPORT VEHICLES PARKING	-
i)	SPACE FOR TRANSPORT VEHICLES PARKING REQUIRED REGULATIONS	SHOWN IN TABLE
ii)	TOTAL NON-TRANSPORT VEHICLES PARKING SPACES PROVIDED	-

PROFORMA - II
 CERTIFICATE OF AREA
 CERTIFICATE THAT I HAVE SURVEYED THE PLOT UNDER REFERENCE ON AND THAT THE DIMENSIONS OF THE SIDES ETC. OF THE PLOT STATED ON THE PLAN ARE AS MEASURED ON SITE AND THE AREA SO WORKED OUT TALLIES WITH THE AREA STATED IN THE DOCUMENT OF OWNERSHIP / TOWN PLANNING SCHEME RECORDS.

LEGENDS	NOTES
PLOT LINES SHOWN IN RED	DRAWING IN SCALE
EXISTING STREET SHOWN IN DOTTED YELLOW	ALL DIMENSIONS ARE IN FEET/METER
FUTURE STREET	OUTER WALL & INTERNAL WALLS ARE 6" THK.
PERMISSIBLE BUILDING	
OPEN SPACES	
WORK PROPOSED TO BE DEMOLISHED	
PROPOSED WORK SHOWN IN PINK	
DRAINAGE & SEWERAGE WORK SHOWN IN YELLOW	
SEWERAGE	
RECREATION GROUND SHOWN IN GREEN	
ROADS & SETBACKS SHOWN IN GREEN	
RESERVATION AS PER D.P. COLOUR	

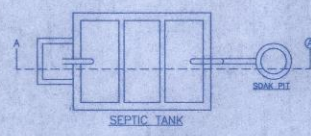
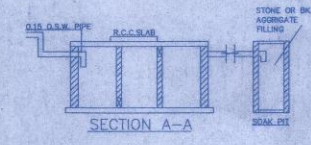
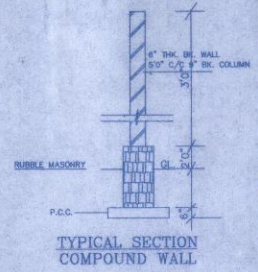

FLAT CARPET AREA IN SQ.MT.	NO. OF FLATS	REQUIRED CAR	PROPOSED CAR
BELOW 35	31	-	-
35 TO 45	11	3	3
45 TO 70	-	-	-
ABOVE 70	-	-	-
COMMERCIAL AREA PER 80 SQ.MT.	0.00	-	-
TOTAL	42	03	03
STILT PARKING			
OPEN PARKING			

DOORS & WINDOWS SCHEDULE		
SIZES IN FT.	AREA IN SQ.MTS.	DESCRIPTION
D 1.00M X 2.15M	2.15	1 W/FLUSHED DOOR
D1 0.90M X 2.15M	1.93	1 W/PANELLED DOOR
D2 0.75M X 2.50M	1.88	1 W/PANELLED DOOR
W 1.80M X 1.20M	2.16	1 W/GLAZED WINDOW
W1 1.50M X 1.20M	1.80	1 W/GLAZED WINDOW
W2 0.90M X 1.20M	1.08	1 W/GLAZED WINDOW
V 0.60M X 0.75M	0.45	GLASS LOUVERES
RS		ROILING SHUTTER

TOTAL BUILTUP AREA STATEMENT							
BLDG TYPE	FLOOR	FLOOR AREA	AREA	NO.OF BLDG	TOTAL BUILTUP AREA	TOTAL EXCESS BALCONY AREA	STAIRCASE & NO OF FLAT & SHOP
A	ST+6	ST.FL- 14.35	1086.25	1	1086.25	-	24 FLAT
		TYP.FL- 178.65					
A1	ST+2	ST.FL- 14.35	371.65	1	371.65	-	8 FLAT
		TYP.FL- 178.65					
B	ST+2	ST.FL- 12.96	467.28	1	467.28	-	10 FLAT
		TYP.FL- 227.16					
TOTAL				03	1925.18	-	42 FLAT

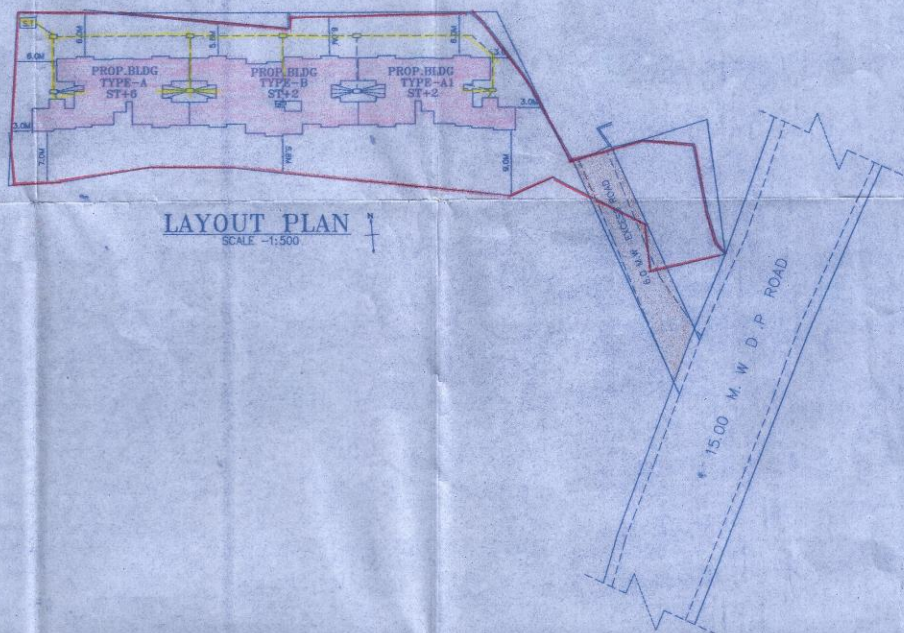

ARCHITECT: **Anil R. Nirgude** SIGNATURE OF OWNERS: **S. Pholir**
 707 01 DRG. NO. PROPOSED BLDG. PLAN ON PLOT BEARING S.NO: 9 H.NO.3/1/2/2A AT VILLAGE :-CHIKANGHAR, TAL:--KALYAN, DIST:--THANE
 AS SHOWN SCALE FOR : SHRI. ANANTA BALARAM BHOR C.A. HOLDER: M/S. JAI MATA DI DEVELOPERS THROUGH 12-06-2016 D A T E MRS:-PODVA SAGAR BHOR & OTHERS.
 ANIL CHD. BY: **VITAN CONSULTANTS ARCHITECTS & ENGINEERS**
 PARESH CAD/DRN B-101, Bindu, Tower, 1st Floor, Opp Lourdes English School, Santoshi Mata Road, Kalyan - 421301

