

AREA CALCULATION OF TRUCK TERMINAL (T)

Survey No. 2019 (P1)		Area	Incentive
T1	30.24 X 13.40 X 0.50	204.66 sq. mt.	2,046.60
T2	38.36 X 30.77 X 0.50	596.17 sq. mt.	5,961.70
T3	33.69 X 13.46 X 0.50	226.28 sq. mt.	2,262.80
Total		1,027.11 sq. mt.	10,271.10
Survey No. 2019B		Area	Incentive
T5	32.72 X 13.59 X 0.50	221.74 sq. mt.	2,217.40
T6	32.72 X 19.42 X 0.50	317.71 sq. mt.	3,177.10
T7	24.41 X 4.74 X 0.50	57.86 sq. mt.	578.60
T8	24.46 X 14.29 X 0.50	174.77 sq. mt.	1,747.70
T9	19.21 X 11.04 X 0.50	106.04 sq. mt.	1,060.40
T10	13.64 X 13.21 X 0.50	90.39 sq. mt.	903.90
T11	35.73 X 23.24 X 0.50	415.85 sq. mt.	4,158.50
T12	38.62 X 9.69 X 0.50	188.09 sq. mt.	1,880.90
Total		1,539.00 sq. mt.	15,390.00

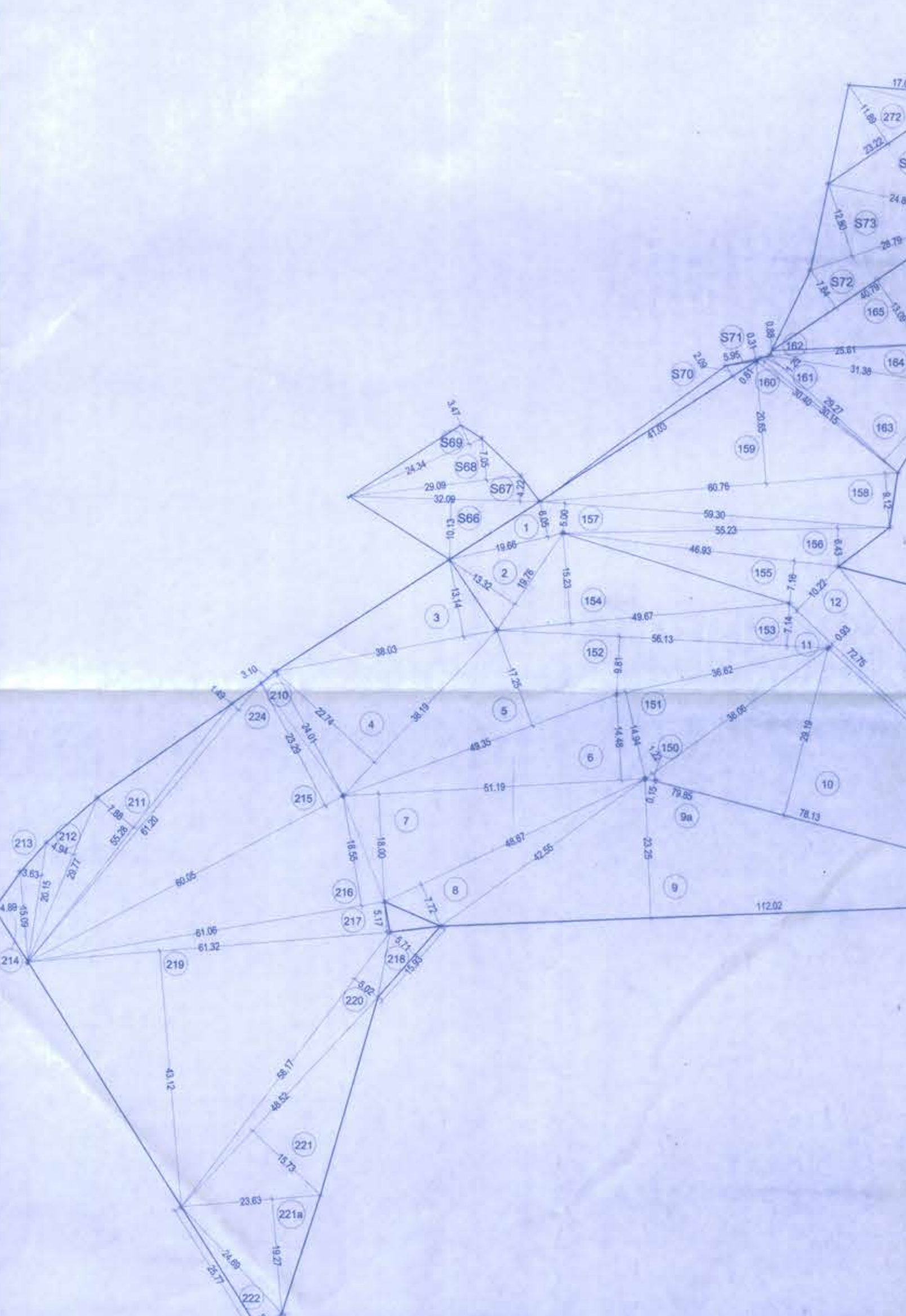
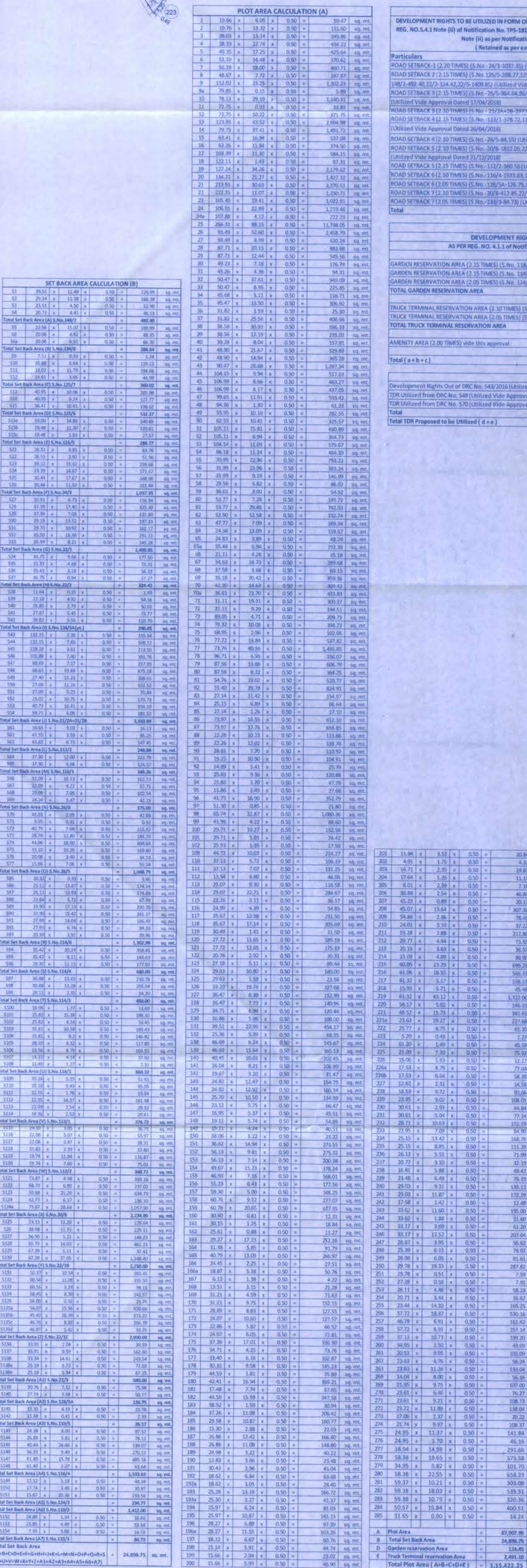
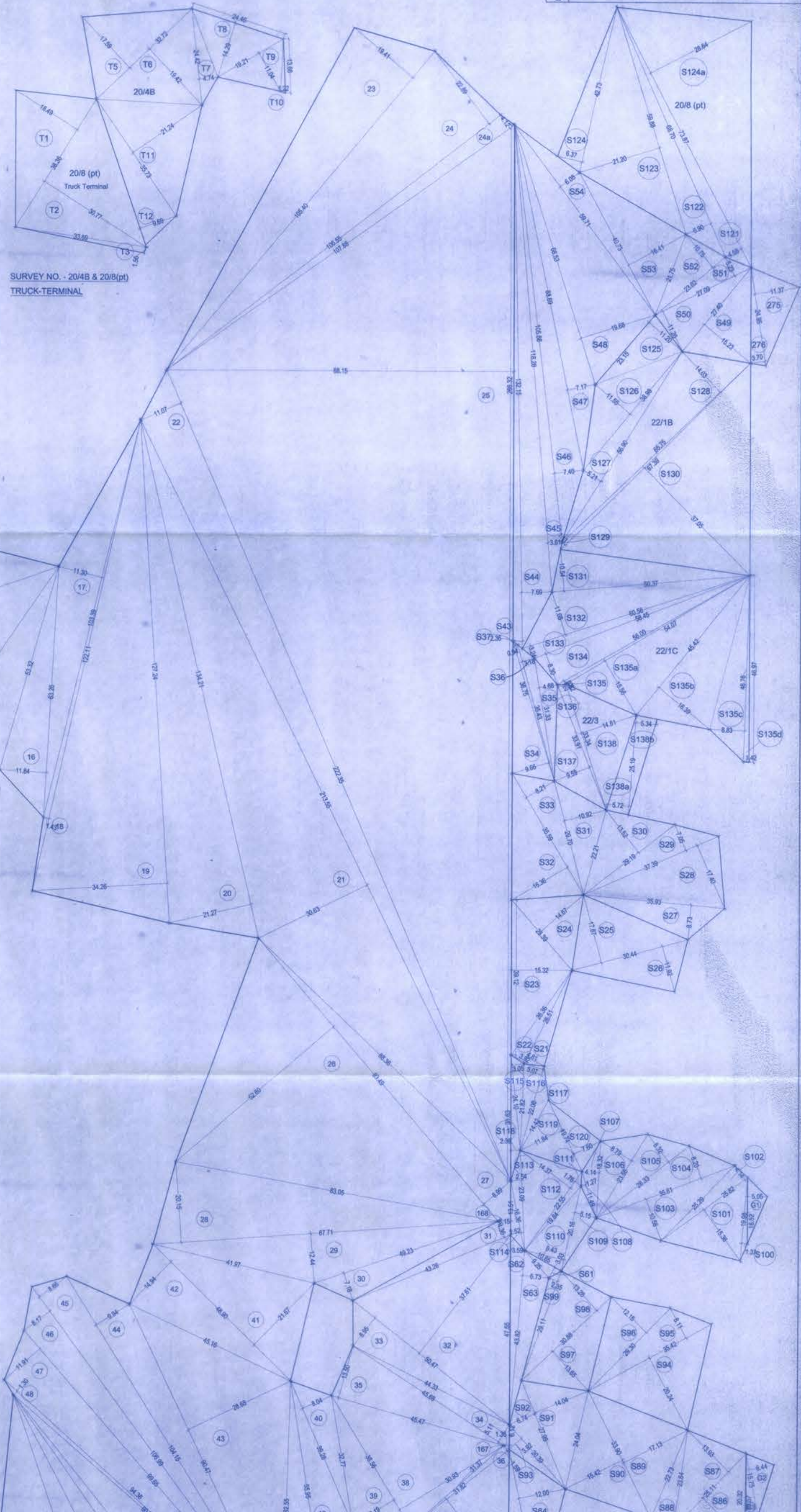

AREA CALCULATION OF TRUCK TERMINAL (T)

Survey No. 2019 (P1)		Area	Incentive
T5	32.72 X 13.59 X 0.50	221.74 sq. mt.	2,217.40
T6	32.72 X 19.42 X 0.50	317.71 sq. mt.	3,177.10
T7	24.41 X 4.74 X 0.50	57.86 sq. mt.	578.60
T8	24.46 X 14.29 X 0.50	174.77 sq. mt.	1,747.70
T9	19.21 X 11.04 X 0.50	106.04 sq. mt.	1,060.40
T10	13.64 X 13.21 X 0.50	90.39 sq. mt.	903.90
T11	35.73 X 23.24 X 0.50	415.85 sq. mt.	4,158.50
T12	38.62 X 9.69 X 0.50	188.09 sq. mt.	1,880.90
Total		1,539.00 sq. mt.	15,390.00

TABLE-1

DEVELOPMENT RIGHTS TO BE UTILIZED IN FORM OF FSI AGAINST ROAD WIDENING AREA OF THE VERY SAID PLOT ON AND UNDER REG. NO. A.1.1 & REG. NO. A.2. WORK (II) OF NOTIFICATION NO. 195-1813/2003/CR-122/MCOER/Admn/Div-12/D/02/12/2021 Read with Clarification on REG. NO. 5.4.1

Note (I) as per Notification No. 195-1813/2003/CR-122/MCOER/Admn/Div-12/D/02/12/2021
Note (II) as per Notification No. 195-1813/2003/CR-122/MCOER/Admn/Div-12/D/02/12/2021 (Retained as per earlier approval vide no. MR/MNP/NT/97/2003-21 Dated - 02/12/2020)

Particulars	Area	Incentive BUA
ROAD SETBACK 1 (2.30 TIMES) (S.No. 26/3-30/3) (Utilized Under Approval Dated 11/09/2018)	1,837.30	18,373.00
ROAD SETBACK 2 (1.15 TIMES) (S.No. 124/5-268/72/13/6-532/37/12/7-605/9/134/5-206/8/134/6-284/6)	1,962.82	19,628.20
ROAD SETBACK 3 (2.15 TIMES) (S.No. 70/5-264/64/30/7/7/5-113/3-24/3-20/3/36/112/2-238/64/116/1-348/36)	4,971.74	49,717.40
ROAD SETBACK 4 (2.10 TIMES) (S.No. 21/7/2A-236-39/90) (Utilized Under Approval Dated 13/04/2018)	289.99	2,899.90
ROAD SETBACK 5 (2.10 TIMES) (S.No. 110/1-128-22/11/4/986/32/114/3-645/10/114/4-586/6/134/6-190/95)	1,680.03	16,800.30
ROAD SETBACK 6 (2.10 TIMES) (S.No. 29/5-48/13) (Utilized Under Approval Dated 26/04/2018)	84.15	841.50
ROAD SETBACK 7 (2.10 TIMES) (S.No. 30/6-30/2/22/28-220/0/20/2/100-01/22/7-48/1-11/2/0-1/3)	6,512.95	65,129.50
ROAD SETBACK 8 (2.15 TIMES) (S.No. 116/4-333/43/110/2-541/0/0) (Utilized Under Approval Dated 12/01/2019)	3,602.56	36,025.60
ROAD SETBACK 9 (2.15 TIMES) (S.No. 129/3A-136-75/13/9-26/17/134/3-394/7/9) (Utilized Under Approval Dated 12/01/2019)	387.60	3,876.00
ROAD SETBACK 10 (2.10 TIMES) (S.No. 20/9-43/2/6/2/1-139/21) (Utilized Under Approval Dated 20/10/2019)	532.71	5,327.10
ROAD SETBACK 11 (2.05 TIMES) (S.No. 138/1-84/7/3) (Utilized Under Approval Dated 23/02/2019)	34.73	347.30
Total	24,896.75	248,967.50

TABLE-2

DEVELOPMENT RIGHTS INCLUDING INCENTIVE AGAINST HANDING OVER OF AMENITY

AS PER REG. NO. 4.1.1 OF NOTIFICATION NO. 195-1813/2003/CR-122/MCOER/Admn/Div-12/D/02/12/2021

Particulars	Area	Incentive BUA
GARDEN RESERVATION AREA (2.15 TIMES) (S.No. 118/4-325/07) (Utilized Under Approval Dated 14/07/2017)	325.07	3,250.70
GARDEN RESERVATION AREA (2.15 TIMES) (S.No. 188/1-41-8/134/3-77) (Utilized Under Approval Dated 26/04/2018)	124.45	1,244.50
GARDEN RESERVATION AREA (2.05 TIMES) (S.No. 12/12-42/5/26-124/3-40/74) (Utilized Under Approval Dated 11/09/2018)	966.23	9,662.30
TOTAL GARDEN RESERVATION AREA	1,415.75	14,157.50
TRUCK TERMINAL RESERVATION AREA (2.10 TIMES) (S.No. 26/3-30/3) (Utilized Under Approval Dated 11/09/2018)	971.30	9,713.00
TRUCK TERMINAL RESERVATION AREA (2.05 TIMES) (S.No. 138/1-84/7/3) (Utilized Under Approval Dated 23/02/2019)	1,530.00	15,300.00
TOTAL TRUCK TERMINAL RESERVATION AREA	2,501.30	25,013.00
AMENITY AREA (2.00 TIMES) (S.No. 138/1-84/7/3) (Utilized Under Approval Dated 23/02/2019)	1,153.87	11,538.70
Total (a+b+c)	6,607.58	66,075.80

TABLE-3

TOTAL TOR PROPOSED TO BE UTILIZED (TABLE-1)

Development Rights Out of DMC No. 545/2016 (Utilized Under Approval Dated 18/07/2017)	6,307.00
TOR Utilized from DMC No. 545/2016 (Utilized Under Approval Dated 18/07/2017)	6,306.00
TOR Utilized from DMC No. 570/2016 (Utilized Under Approval Dated 22/10/2019)	1,937.00
Total	8,243.00
Total TOR Proposed to be Utilized (d+e)	35,846.73

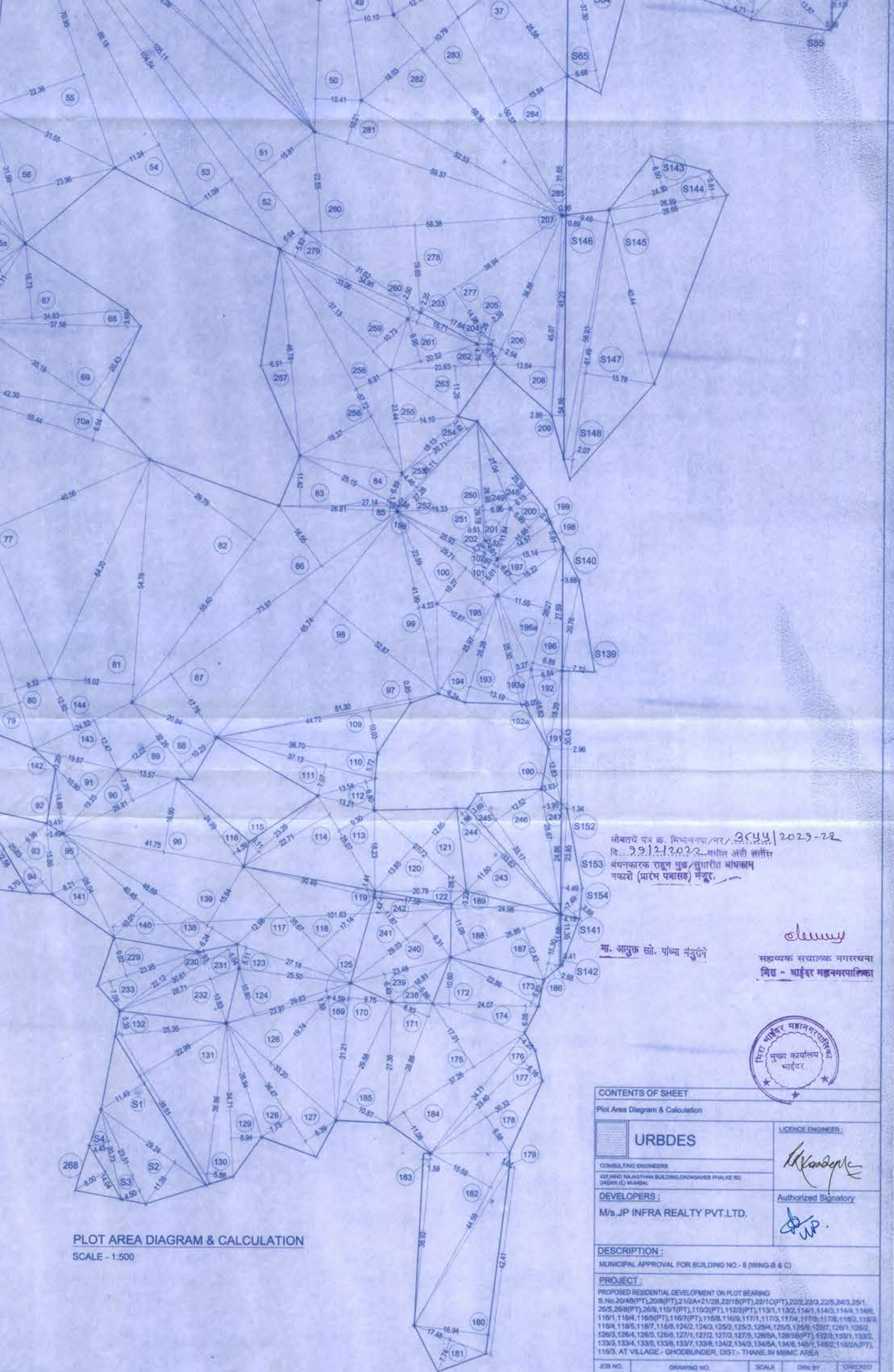

TABLE-4

DEVELOPMENT RIGHTS INCLUDING INCENTIVE AGAINST HANDING OVER OF AMENITY

AS PER REG. NO. 4.1.1 OF NOTIFICATION NO. 195-1813/2003/CR-122/MCOER/Admn/Div-12/D/02/12/2021

Particulars	Area	Incentive BUA
GARDEN RESERVATION AREA (2.15 TIMES) (S.No. 118/4-325/07) (Utilized Under Approval Dated 14/07/2017)	325.07	3,250.70
GARDEN RESERVATION AREA (2.15 TIMES) (S.No. 188/1-41-8/134/3-77) (Utilized Under Approval Dated 26/04/2018)	124.45	1,244.50
GARDEN RESERVATION AREA (2.05 TIMES) (S.No. 12/12-42/5/26-124/3-40/74) (Utilized Under Approval Dated 11/09/2018)	966.23	9,662.30
TOTAL GARDEN RESERVATION AREA	1,415.75	14,157.50
TRUCK TERMINAL RESERVATION AREA (2.10 TIMES) (S.No. 26/3-30/3) (Utilized Under Approval Dated 11/09/2018)	971.30	9,713.00
TRUCK TERMINAL RESERVATION AREA (2.05 TIMES) (S.No. 138/1-84/7/3) (Utilized Under Approval Dated 23/02/2019)	1,530.00	15,300.00
TOTAL TRUCK TERMINAL RESERVATION AREA	2,501.30	25,013.00
AMENITY AREA (2.00 TIMES) (S.No. 138/1-84/7/3) (Utilized Under Approval Dated 23/02/2019)	1,153.87	11,538.70
Total (a+b+c)	6,607.58	66,075.80

TABLE-5

TOTAL TOR PROPOSED TO BE UTILIZED (TABLE-1)

Development Rights Out of DMC No. 545/2016 (Utilized Under Approval Dated 18/07/2017)	6,307.00
TOR Utilized from DMC No. 545/2016 (Utilized Under Approval Dated 18/07/2017)	6,306.00
TOR Utilized from DMC No. 570/2016 (Utilized Under Approval Dated 22/10/2019)	1,937.00
Total	8,243.00
Total TOR Proposed to be Utilized (d+e)	35,846.73

PLOT AREA CALCULATION (B)

S1	35.51 X 11.41 X 0.50	201.90	2,019.00
S2	27.24 X 11.39 X 0.50	153.18	1,531.80
S3	27.24 X 4.26 X 0.50	58.21	582.10
S4	27.24 X 4.26 X 0.50	58.21	582.10
S5	27.24 X 4.26 X 0.50	58.21	582.10
S6	27.24 X 4.26 X 0.50	58.21	582.10
S7	27.24 X 4.26 X 0.50	58.21	582.10
S8	27.24 X 4.26 X 0.50	58.21	582.10
S9	27.24 X 4.26 X 0.50	58.21	582.10
S10	27.24 X 4.26 X 0.50	58.21	582.10
S11	27.24 X 4.26 X 0.50	58.21	582.10
S12	27.24 X 4.26 X 0.50	58.21	582.10
S13	27.24 X 4.26 X 0.50	58.21	582.10
S14	27.24 X 4.26 X 0.50	58.21	582.10
S15	27.24 X 4.26 X 0.50	58.21	582.10
S16	27.24 X 4.26 X 0.50	58.21	582.10
S17	27.24 X 4.26 X 0.50	58.21	582.10
S18	27.24 X 4.26 X 0.50	58.21	582.10
S19	27.24 X 4.26 X 0.50	58.21	582.10
S20	27.24 X 4.26 X 0.50	58.21	582.10
S21	27.24 X 4.26 X 0.50	58.21	582.10
S22	27.24 X 4.26 X 0.50	58.21	582.10
S23	27.24 X 4.26 X 0.50	58.21	582.10
S24	27.24 X 4.26 X 0.50	58.21	582.10
S25	27.24 X 4.26 X 0.50	58.21	582.10
S26	27.24 X 4.26 X 0.50	58.21	582.10
S27	27.24 X 4.26 X 0.50	58.21	582.10
S28	27.24 X 4.26 X 0.50	58.21	582.10
S29	27.24 X 4.26 X 0.50	58.21	582.10
S30	27.24 X 4.26 X 0.50	58.21	582.10
S31	27.24 X 4.26 X 0.50	58.21	582.10
S32	27.24 X 4.26 X 0.50	58.21	582.10
S33	27.24 X 4.26 X 0.50	58.21	582.10
S34	27.24 X 4.26 X 0.50	58.21	582.10
S35	27.24 X 4.26 X 0.50	58.21	582.10
S36	27.24 X 4.26 X 0.50	58.21	582.10
S37	27.24 X 4.26 X 0.50	58.21	582.10
S38	27.24 X 4.26 X 0.50	58.21	582.10
S39	27.24 X 4.26 X 0.50	58.21	582.10
S40	27.24 X 4.26 X 0.50	58.21	582.10
S41	27.24 X 4.26 X 0.50	58.21	582.10
S42	27.24 X 4.26 X 0.50	58.21	582.10
S43	27.24 X 4.26 X 0.50	58.21	582.10
S44	27.24 X 4.26 X 0.50	58.21	582.10
S45	27.24 X 4.26 X 0.50	58.21	582.10
S46	27.24 X 4.26 X 0.50	58.21	582.10
S47	27.24 X 4.26 X 0.50	58.21	582.10
S48	27.24 X 4.26 X 0.50	58.21	582.10
S49	27.24 X 4.26 X 0.50	58.21	582.10
S50	27.24 X 4.26 X 0.50	58.21	582.10
S51	27.24 X 4.26 X 0.50	58.21	582.10
S52	27.24 X 4.26 X 0.50	58.21	582.10
S53	27.24 X 4.26 X 0.50	58.21	582.10
S54	27.24 X 4.26 X 0.50	58.21	582.10
S55	27.24 X 4.26 X 0.50	58.21	582.10
S56	27.24 X 4.26 X 0.50	58.21	582.10
S57	27.24 X 4.26 X 0.50	58.21	582.10
S58	27.24 X 4.26 X 0.50	58.21	582.10
S59	27.24 X 4.26 X 0.50	58.21	582.10
S60	27.24 X 4.26 X 0.50	58.21	582.10
S61	27.24 X 4.26 X 0.50	58.21	582.10
S62	27.24 X 4.26 X 0.50	58.21	582.10
S63	27.24 X 4.26 X 0.50	58.21	582.10
S64	27.24 X 4.26 X 0.50	58.21	582.10
S65	27.24 X 4.26 X 0.50	58.21	582.10
S66	27.24 X 4.26 X 0.50	58.21	582.10
S67	27.24 X 4.26 X 0.50	58.21	582.10
S68	27.24 X 4.26 X 0.50	58.21	582.10
S69	27.24 X 4.26 X 0.50	58.21	582.10
S70	27.24 X 4.26 X 0.50	58.21	582.10
S71	27.24 X 4.26 X 0.50	58.21	582.10
S72	27.24 X 4.26 X 0.50	58.21	582.10
S73	27.24 X 4.26 X 0.50	58.21	582.10
S74	27.24 X 4.26 X 0.50	58.21	582.10
S75	27.24 X 4.26 X 0.50	58.21	582.10
S76	27.24 X 4.26 X 0.50	58.21	582.10
S77	27.24 X 4.26 X 0.50	58.21	582.10
S78	27.24 X 4.26 X 0.50	58.21	582.10
S79	27.24 X 4.26 X 0.50	58.21	582.10
S80	27.24 X 4.26 X 0.50	58.21	582.10
S81	27.24 X 4.26 X 0.50	58.21	582.10
S82	27.24 X 4.26 X 0.50	58.21	582.10
S83	27.24 X 4.26 X 0.50	58.21	582.10
S84	27.24 X 4.26 X 0.50	58.21	582.10
S85	27.24 X 4.26 X 0.50	58.21	582.10
S86	27.24 X 4.26 X 0.50	58.21	582.10
S87	27.24 X 4.26 X 0.50	58.21	582.10
S88	27.24 X 4.26 X 0.50	58.21	582.10
S89	27.24 X 4.26 X 0.50	58.21	582.10
S90	27.24 X 4.26 X 0.50	58.21	582.10
S91	27.24 X 4.26 X 0.50	58.21	582.10
S92	27.24 X 4.26 X 0.50	58.21	582.10
S93	27.24 X 4.26 X 0.50	58.21	582.10
S94	27.24 X 4.26 X 0.50	58.21	582.10
S95	27.24 X 4.26 X 0.50	58.21	582.10
S96	27.24 X 4.26 X 0.50	58.21	582.10
S97	27.24 X 4.26 X 0.50	58.21	582.10
S98	27.24 X 4.26 X 0.50	58.21	582.10
S99	27.24 X 4.26 X 0.50	58.21	582.10
S100	27.24 X 4.26 X 0.50	58.21	582.10
S101	27.24 X 4.26 X 0.50	58.21	582.10
S102	27.24 X 4.26 X 0.50	58.21	582.10
S103	27.24 X 4.26 X 0.50	58.21	582.10
S104	27.24 X 4.26 X 0.50	58.21	582.10
S105	27.24 X 4.26 X 0.50	58.21	582.10
S106	27.24 X 4.26 X 0.50	58.21	582.10
S107	27.24 X 4.26 X 0.50	58.21	582.10
S108	27.24 X 4.26 X 0.50	58.21	582.10
S109	27.24 X 4.26 X 0.50	58.21	582.10
S110	27.24 X 4.26 X 0.50	58.21	582.10
S111	27.24 X 4.26 X 0.50	58.21	582.10
S112	27.24 X 4.26 X 0.50	58.21	582.10
S113	27.24 X 4.26 X 0.50	58.21	582.10
S114	27.24 X 4.26 X 0.50	58.21	582.10
S115	27.24 X 4.26 X 0.50	58.21	582.10
S116	27.24 X 4.26 X 0.50	58.21	582.10
S117	27.24 X 4.26 X 0.50	58.21	582.10
S118	27.24 X 4.26 X 0.50	58.21	582.10
S119	27.24 X 4.26 X 0.50	58.21	582.10
S120	27.24 X 4.26 X 0.50	58.21	582.10
S121</			