

मोबातवे पर क्र. विभाजनवा/नर./५०९/२०२२-२३
दि. २८.११.२०२२... मधील अटी शर्तीस
बंधनकारक राहून मुळ/सुधारीत बांधकाम
नकाशे (प्रारंभ प्रस्ताव) मंजूर.

सहाय्यक सहाय्यक नगररचना
विभाग - भाईर नगरपालिका

मि. आशुत सो. यांच्या मंडळीने

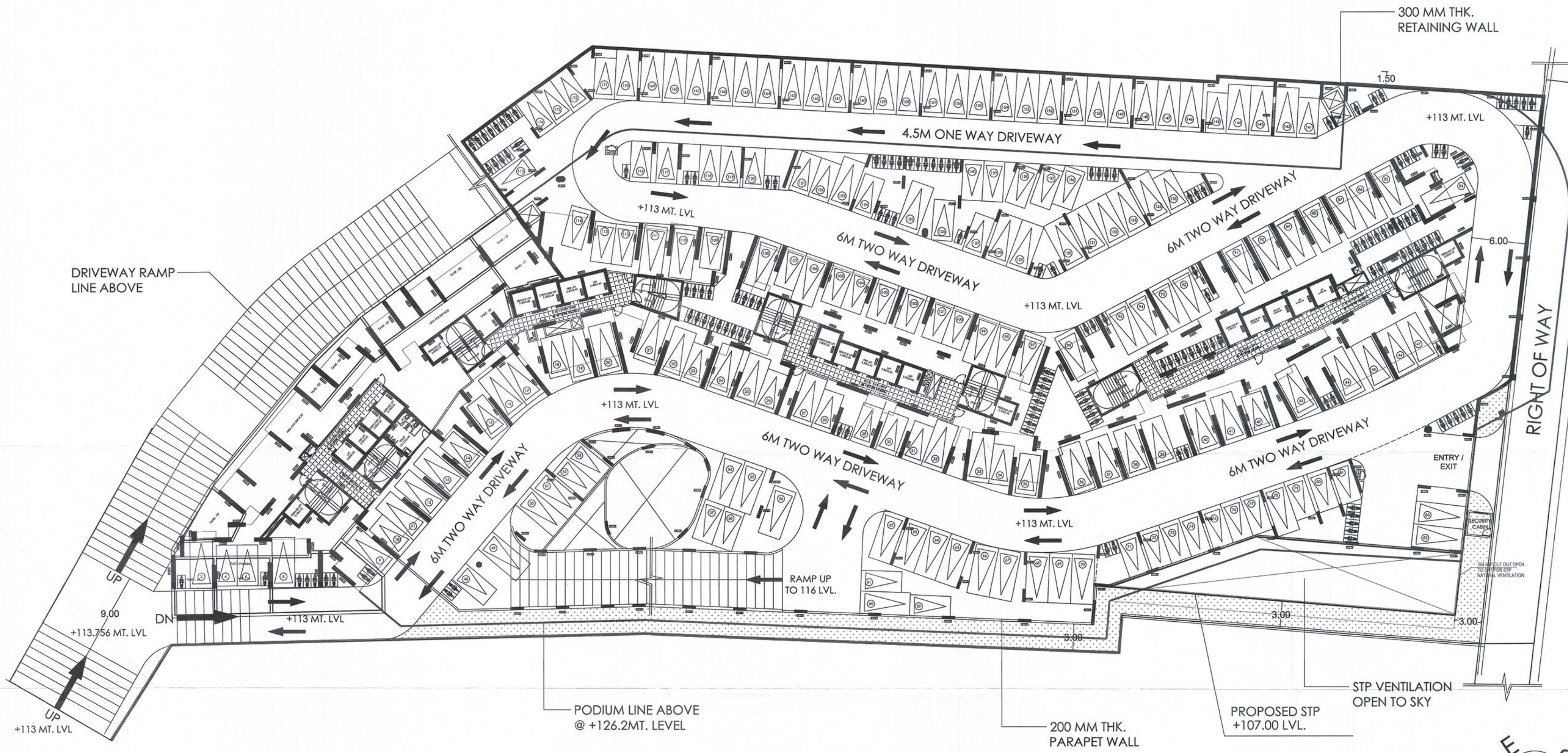

1ST BASEMENT CAR PARKING = 174 NOS
1ST BASEMENT SCOOTER PARKING = 150 NOS

F NOTES
BOUNDARY OF PLOT SHOWN THICK BLACK
PROPOSED WORK SHOWN RED FILLED IN
ALL WALLS ARE 150MM THK. CONCRETE BLOCK.
INT. PLASTER SHOULD BE NEERU FINISHED.
EXT. PLASTER SHOULD BE SAND FINISHED.
NATURE OF BUILDING IS R.C.C. FRAME WORK.

CERTIFICATE OF AREA
CERTIFIED THAT I HAVE SURVEYED THE PLOT UNDER REFERENCE ON
AND THE DIMENSIONS OF SIDES ETC. OF THE PLOT STATED ON THE PLAN ARE
AS MEASURED ON SITE AND THE AREA SO WORKED OUT IS SQ.MTS.
AND TALLIES WITH THE AREA STATED IN THE DOCUMENT OF OWNERSHIP
T.P.S. RECORDS / LAND RECORDS DEPT. / CITY SURVEY RECORDS

PROFORMA 'B'
CONTENTS OF SHEET: BASEMENT PLAN, SCHEDULE OF PARKING
DESCRIPTION OF PRO.PERTY: PROPOSED COM.COM BLDG ON PLOT BEARING S.90.00, 200ft & 150ft OF VILLAGE-MAHAJANWADI TAL. & DIST-THANE.

NAME, ADDRESS OF OWNER: M/S MAN VASTUCON LLP
AUTHORISED SIGNATURE: [Signature]

This plan is prepared as per the documents and papers provided by the owner.

NORTH: NAME, ADDRESS & SIGNATURE OF ARCHITECT
ARCHITECT: [Signature] CA/92/14868

Disha Design Consultants
OFFICE NO.5, 1ST FLOOR, ACHAL GIRI BUILDING,
NEAR JAIN TEMPLE, ABOVE PRASHANT HOTEL,
150 FEET WIDE ROAD MAXUS MALL BHAYANDER
(W).- 401101.

JOB NO.	DRG. NO.	SCALE	DRN BY	CHKD BY
	As Shown		A. K. SINGH	

1ST BASEMENT PLAN
LVL.+113.00 MT. SCALE - 1:200

