

CARPET AREA CALCULATIONS FOR (3RD TO 7TH & 9TH TO 14TH FLOOR) TENANT FLAT WING A, B, C FLAT NO. 1, 2, 4, 5 ARE SAME

A	7.90 x 1.91 x 1.90 = 2.90
B	1.85 x 1.31 x 1.00 = 2.50
C	3.35 x 1.31 x 1.00 = 3.98
D	2.58 x 1.49 x 1.00 = 3.84
E	1.05 x 0.33 x 1.00 = 0.34
TOTAL CARPET UP AREA	= 30.38

CARPET AREA CALCULATIONS FOR (3RD TO 20TH FLOOR) WING A - FLAT NO. 6

A	7.45 x 5.32 x 1.00 = 39.80
B	11.81 x 3.96 x 1.00 = 46.80
C	3.39 x 2.45 x 1.00 = 3.31
D	8.43 x 1.45 x 1.00 = 12.22
E	1.99 x 0.33 x 1.00 = 0.66
TOTAL CARPET UP AREA	= 79.11

CARPET AREA CALCULATIONS FOR (3RD TO 20TH FLOOR) WING B - FLAT NO. 6

A	7.45 x 5.32 x 1.00 = 39.80
B	11.81 x 3.96 x 1.00 = 46.80
C	3.39 x 2.45 x 1.00 = 3.31
D	8.43 x 1.45 x 1.00 = 12.22
E	1.99 x 0.33 x 1.00 = 0.66
TOTAL CARPET UP AREA	= 79.11

CARPET AREA CALCULATIONS FOR (3RD TO 20TH FLOOR) WING C - FLAT NO. 6 & 7

A	5.25 x 4.23 x 1.00 = 22.31
B	3.15 x 1.31 x 1.00 = 3.62
C	2.98 x 1.49 x 1.00 = 3.27
D	1.05 x 0.33 x 1.00 = 0.34
TOTAL CARPET UP AREA	= 19.85

CARPET AREA CALCULATIONS FOR (3RD TO 20TH FLOOR) WING A, B - FLAT NO. 3

A	1.05 x 0.33 x 1.00 = 0.34
B	3.15 x 2.39 x 1.00 = 2.70
C	1.81 x 2.27 x 1.00 = 2.60
D	2.39 x 1.32 x 1.00 = 2.60
E	8.43 x 1.09 x 1.00 = 29.33
F	1.99 x 2.15 x 1.00 = 4.27
TOTAL CARPET UP AREA	= 38.84

CARPET AREA CALCULATIONS FOR (3RD TO 20TH FLOOR) WING B - FLAT NO. 3

A	1.05 x 0.33 x 1.00 = 0.34
B	3.15 x 2.39 x 1.00 = 2.70
C	1.81 x 2.27 x 1.00 = 2.60
D	2.39 x 1.32 x 1.00 = 2.60
E	8.43 x 1.09 x 1.00 = 29.33
F	1.99 x 2.15 x 1.00 = 4.27
TOTAL CARPET UP AREA	= 38.84

CARPET AREA CALCULATIONS FOR (3RD TO 20TH FLOOR) WING C - FLAT NO. 3

A	1.05 x 0.33 x 1.00 = 0.34
B	3.15 x 2.39 x 1.00 = 2.70
C	1.81 x 2.27 x 1.00 = 2.60
D	2.39 x 1.32 x 1.00 = 2.60
E	8.43 x 1.09 x 1.00 = 29.33
F	1.99 x 2.15 x 1.00 = 4.27
TOTAL CARPET UP AREA	= 38.84

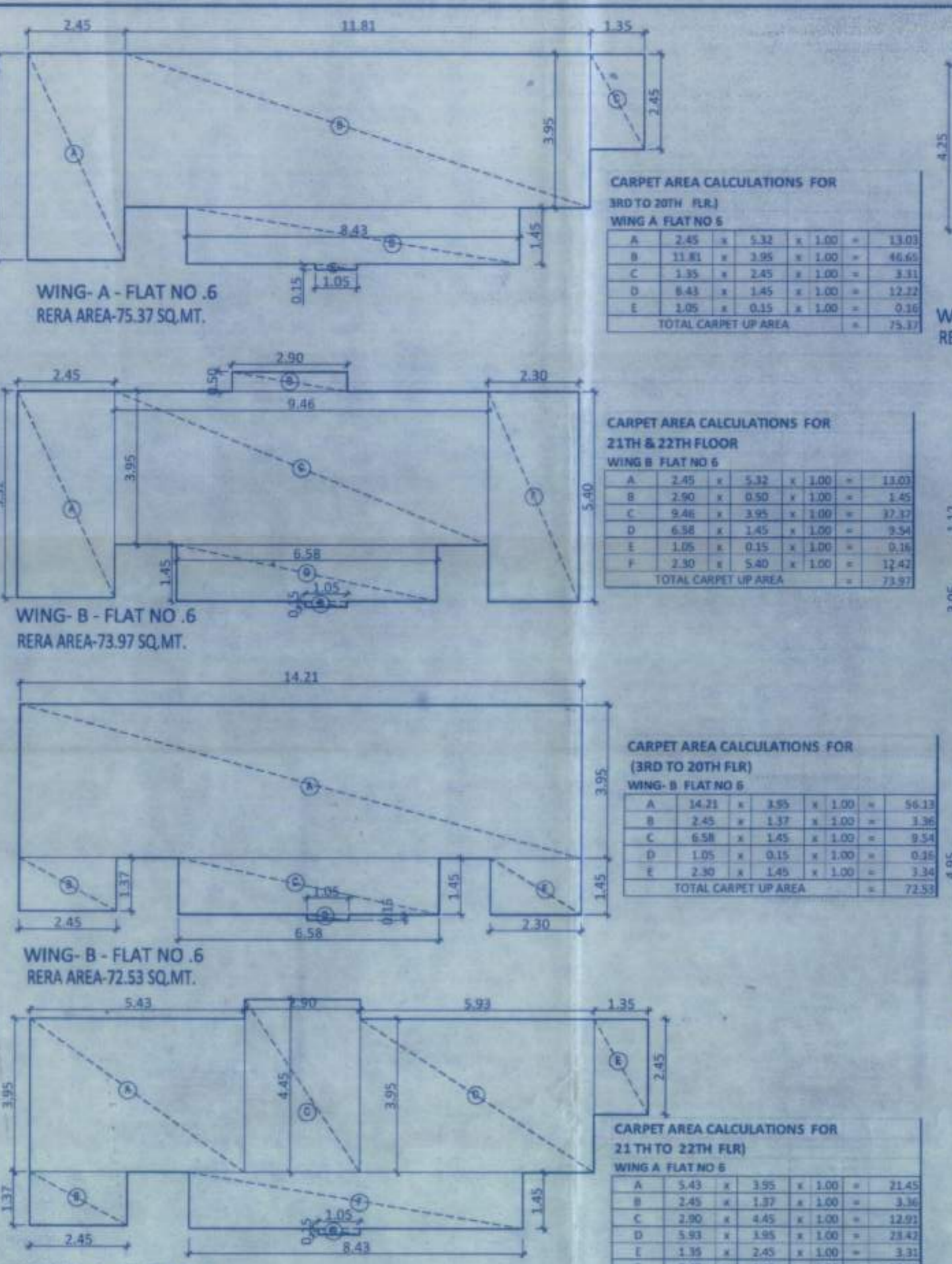

CARPET AREA CALCULATIONS FOR (3RD TO 20TH FLOOR) WING A - FLAT NO. 6

A	7.45 x 5.32 x 1.00 = 39.80
B	11.81 x 3.96 x 1.00 = 46.80
C	3.39 x 2.45 x 1.00 = 3.31
D	8.43 x 1.45 x 1.00 = 12.22
E	1.99 x 0.33 x 1.00 = 0.66
TOTAL CARPET UP AREA	= 79.11

CARPET AREA CALCULATIONS FOR (3RD TO 20TH FLOOR) WING B - FLAT NO. 6

A	7.45 x 5.32 x 1.00 = 39.80
B	11.81 x 3.96 x 1.00 = 46.80
C	3.39 x 2.45 x 1.00 = 3.31
D	8.43 x 1.45 x 1.00 = 12.22
E	1.99 x 0.33 x 1.00 = 0.66
TOTAL CARPET UP AREA	= 79.11

CARPET AREA CALCULATIONS FOR (3RD TO 20TH FLOOR) WING C - FLAT NO. 6 & 7

A	5.25 x 4.23 x 1.00 = 22.31
B	3.15 x 1.31 x 1.00 = 3.62
C	2.98 x 1.49 x 1.00 = 3.27
D	1.05 x 0.33 x 1.00 = 0.34
TOTAL CARPET UP AREA	= 19.85

CARPET AREA CALCULATIONS FOR (3RD TO 20TH FLOOR) WING A, B - FLAT NO. 3

A	1.05 x 0.33 x 1.00 = 0.34
B	3.15 x 2.39 x 1.00 = 2.70
C	1.81 x 2.27 x 1.00 = 2.60
D	2.39 x 1.32 x 1.00 = 2.60
E	8.43 x 1.09 x 1.00 = 29.33
F	1.99 x 2.15 x 1.00 = 4.27
TOTAL CARPET UP AREA	= 38.84

CARPET AREA CALCULATIONS FOR (3RD TO 20TH FLOOR) WING B - FLAT NO. 3

A	1.05 x 0.33 x 1.00 = 0.34
B	3.15 x 2.39 x 1.00 = 2.70
C	1.81 x 2.27 x 1.00 = 2.60
D	2.39 x 1.32 x 1.00 = 2.60
E	8.43 x 1.09 x 1.00 = 29.33
F	1.99 x 2.15 x 1.00 = 4.27
TOTAL CARPET UP AREA	= 38.84

CARPET AREA CALCULATIONS FOR (3RD TO 20TH FLOOR) WING C - FLAT NO. 3

A	1.05 x 0.33 x 1.00 = 0.34
B	3.15 x 2.39 x 1.00 = 2.70
C	1.81 x 2.27 x 1.00 = 2.60
D	2.39 x 1.32 x 1.00 = 2.60
E	8.43 x 1.09 x 1.00 = 29.33
F	1.99 x 2.15 x 1.00 = 4.27
TOTAL CARPET UP AREA	= 38.84

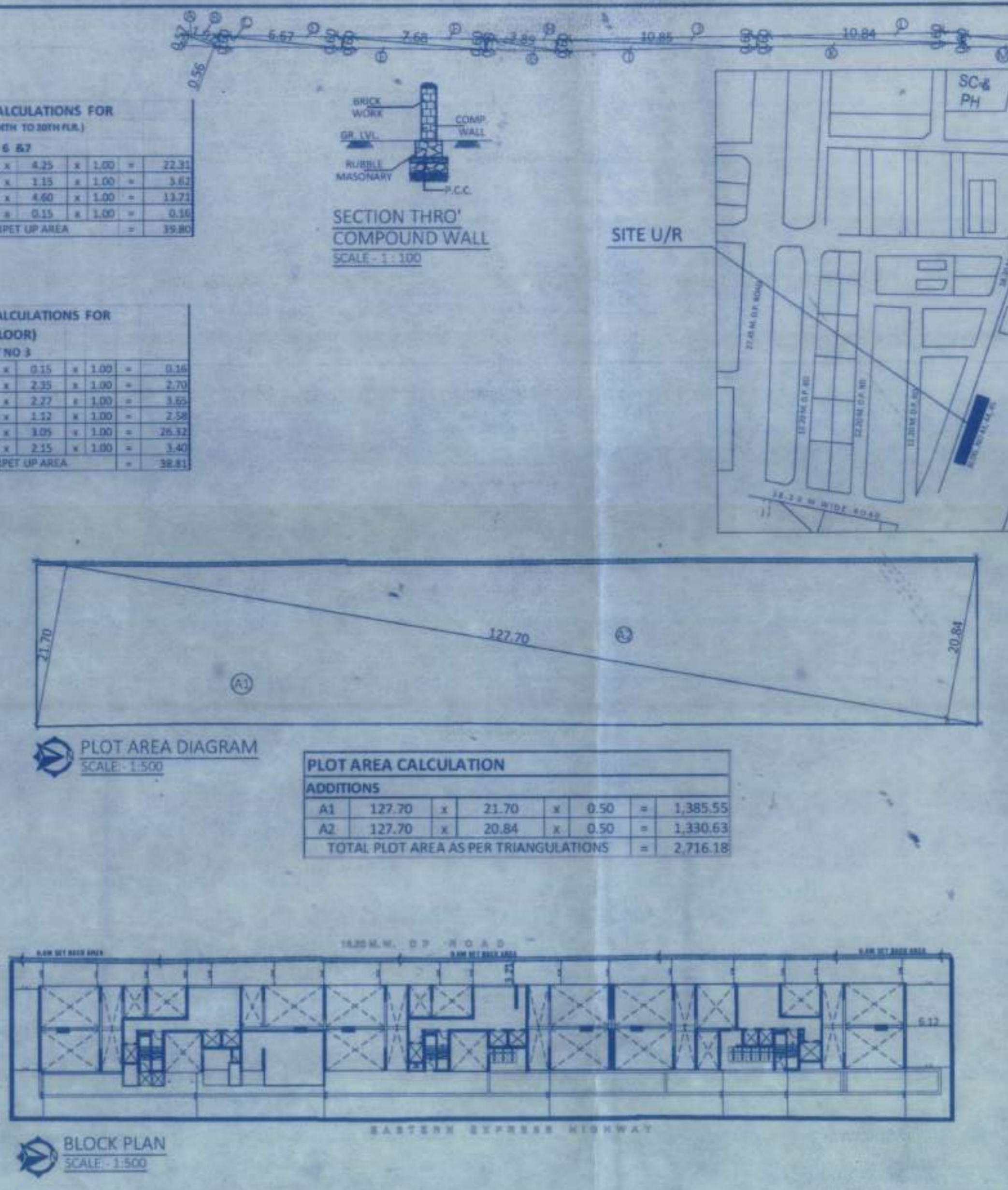

SETBACK AREA CALCULATION ADDITIONS

A	1.92 x 0.57 x 0.50 = 0.55
B	1.92 x 0.56 x 0.50 = 0.54
C	6.07 x 0.60 x 0.50 = 2.00
D	6.07 x 0.60 x 0.50 = 2.00
E	7.68 x 0.60 x 0.50 = 2.30
F	7.68 x 0.60 x 0.50 = 2.30
G	3.89 x 0.60 x 0.50 = 1.17
H	3.89 x 0.60 x 0.50 = 1.17
I	10.85 x 0.60 x 0.50 = 3.26
J	10.85 x 0.60 x 0.50 = 3.26
K	10.84 x 0.60 x 0.50 = 3.25
L	10.84 x 0.60 x 0.50 = 3.25
M	7.61 x 0.60 x 0.50 = 2.28
N	7.61 x 0.60 x 0.50 = 2.28
O	19.42 x 0.60 x 0.50 = 5.83
P	19.42 x 0.60 x 0.50 = 5.83
Q	22.47 x 0.60 x 0.50 = 6.74
R	22.47 x 0.60 x 0.50 = 6.74
S	19.69 x 0.60 x 0.50 = 5.91
T	19.69 x 0.60 x 0.50 = 5.91
U	15.11 x 0.60 x 0.50 = 4.53
V	15.11 x 0.60 x 0.50 = 4.53
TOTAL SETBACK AREA AS PER SITE MEASUREMENT	75.57
TOTAL SETBACK AREA AS PER MHADA DEMARCATION	31.59

SETBACK AREA DIAGRAM
SCALE - 1:200

FITNESS AREA STATEMENT

AMENITY FLOOR	
2% OF THE TOTAL BUA	21669.36
TOTAL PROPOSED BUA	21669.36
TOTAL BUA	21669.36
2% AMENITY AREA	433.39
PROPOSED AMENITY AREA	1093.99
EXCESS AMENITY AREA	660.60

PARKING AREA STATEMENT (RESIDENTIAL REG. NO. 44(2) Table 2)

TYPE	CARPET AREA IN SQ.MT.	TENEMENT NO.	PARKING REQD.
RESIDENTIAL	4 TENEMENTS WITH CARPET AREA UPTO 45.00 SQ.MT.	99	24.75
RESIDENTIAL	2 TENEMENTS WITH CARPET AREA EXCEEDING 45.00 SQ.MT. BUT NOT EXCEEDING 60.00 SQ.MT.	232	116.00
RESIDENTIAL	1 TENEMENTS WITH CARPET AREA EXCEEDING 60.00 SQ.MT. BUT NOT EXCEEDING 90.00 SQ.MT.	38	38.00
RESIDENTIAL	1/2 TENEMENT WITH CARPET AREA EXCEEDING 90.00 SQ.MT.	0	0.00
TOTAL		369	178.75
10% FOR VISITORS CAR PARKING			17.88
TOTAL PERMISSIBLE PARKING			196.63
50% ADDITIONAL PARKING			98.32
PERMISSIBLE PARKING INCLUDING ADDITIONAL 50%			227
TOTAL PARKING PROPOSED			227
SCOOTER PARKING TOTAL PROVIDED - 25% OF CAR PARKING (227 x 25% = 56.75)			57

BUILT UP AREA SUMMARY

FLOOR NAME	WING A	WING B	WING C	GROSS BUA (A+B+C)	NET BUA	FUNGIBLE	WING A	WING B	WING C	SOCIETY OFFICE	LETTER BOX	FITNESS CENTER	REFUGE AREA A, B & C WING	TOTAL GROSS BUA	NOS OF FLAT
2nd FLOOR							57.95	58.22	59.38	20	17.65	1093.99		1307.19	0
3rd FLOOR	361.05	358.92	368.68	1088.65	806.41	282.24	57.95	58.22	59.38					1264.2	19
4th FLOOR	361.05	358.92	368.68	1088.65	806.41	282.24	57.95	58.22	59.38					1264.2	19
5th FLOOR	361.05	358.92	368.68	1088.65	806.41	282.24	57.95	58.22	59.38					1264.2	19
6th FLOOR	361.05	358.92	368.68	1088.65	806.41	282.24	57.95	58.22	59.38					1264.2	19
7th FLOOR	361.05	358.92	368.68	1088.65	806.41	282.24	57.95	58.22	59.38					1264.2	19
8th FLOOR - REFUGE AREA	306.22	167.38	313.44	786.84	542.84	244.00	57.95	58.22	59.38				301.79	1569.99	14
9th FLOOR	361.05	358.92	368.68	1088.65	806.41	282.24	57.95	58.22	59.38					1264.2	19
10th FLOOR	361.05	358.92	368.68	1088.65	806.41	282.24	57.95	58.22	59.38					1264.2	19
11th FLOOR	361.05	358.92	368.68	1088.65	806.41	282.24	57.95	58.22	59.38					1264.2	19
12th FLOOR	374.92	372.85	383.17	1130.94	837.73	293.21	57.95	58.22	59.38					1306.49	19
13th FLOOR	374.92	372.85	383.17	1130.94	837.73	293.21	57.95	58.22	59.38					1306.49	19
14th FLOOR	374.92	372.85	383.17	1130.94	837.73	293.21	57.95	58.22	59.38					1306.49	19
15th FLOOR - REFUGE AREA	316.64	174.12	280.36	771.12	571.20	199.92	57.95	58.22	59.38				359.83	1566.32	13
16th FLOOR	374.92	372.85	383.17	1130.94	837.73	293.21	57.95	58.22	59.38					1306.49	19
17th FLOOR	374.92	372.85	383.17	1130.94	837.73	293.21	57.95	58.22	59.38					1306.49	19
18th FLOOR	374.92	372.85	383.17	1130.94	837.73	293.21	57.95	58.22	59.38					1306.49	19
19th FLOOR	374.92	372.85	383.17	1130.94	837.73	293.21	57.95	58.22	59.38					1306.49	19
20th FLOOR	374.92	372.85	383.17	1130.94	837.73	293.21	57.95	58.22	59.38					1306.49	19
21st FLOOR	390.52	389.01	397.41	1177.34	872.10	305.24	57.95	58.22	59.38					1352.89	19
22nd FLOOR	390.52	389.01	397.41	1177.34	872.10	305.24	57.95	58.22	59.38					1352.89	19
TOTAL BUILT UP AREA	7292.46	6973.48	7403.42	21669.36	16051.38	5617.98	1216.95	1222.62	1246.98	20	17.65	1093.99	661.62	27237.86	349
ADDITIONAL AMENITY AREA				660.60	660.60										
TOTAL PROPOSED AREA				22329.96	16711.98										

TOTAL STAIRCASE/LIFT AREA 3686.55

PROFORMA-A

1	AREA OF PLOT	AS PER MHADA DEMARCATION	2808.24
2	AS PER MHADA OFFER LETTER	2713.18	
3	DEDUCTIONS FOR		
3.1	ROAD SET-BACK AREA (AS PER SURVEY REMARKS)		75.37
3.2	PROPOSED ROAD		
3.3	AMENITY PRESERVATION		
3.4	50% AMENITY SPACE AS PER DCR 56/77 (50% PLOT)		75.37
4	DEDUCTIONS FOR 15% RECREATIONAL GROUND		364.62
5	BALANCE AREA OF PLOT (1 - 3a)		0.00
6	NET AREA OF PLOT (1 - 4)		433.39
7	NET AREA OF PLOT (1 - 4)		3040.61
8	ADDITIONALS FOR FLOOR SPACE INDEX		75.37
9	ADDITIONALS FOR FLOOR SPACE INDEX		75.37
10	ADDITIONALS FOR FLOOR SPACE INDEX		75.37
11	ADDITIONALS FOR FLOOR SPACE INDEX		75.37
12	ADDITIONALS FOR FLOOR SPACE INDEX		75.37
13	ADDITIONALS FOR FLOOR SPACE INDEX		75.37
14	ADDITIONALS FOR FLOOR SPACE INDEX		75.37
15	ADDITIONALS FOR FLOOR SPACE INDEX		75.37
16	ADDITIONALS FOR FLOOR SPACE INDEX		75.37
17	ADDITIONALS FOR FLOOR SPACE INDEX		75.37
18	ADDITIONALS FOR FLOOR SPACE INDEX		75.37
19	ADDITIONALS FOR FLOOR SPACE INDEX		75.37
20	ADDITIONALS FOR FLOOR SPACE INDEX		75.37
21	ADDITIONALS FOR FLOOR SPACE INDEX		75.37
22	ADDITIONALS FOR FLOOR SPACE INDEX		75.37
23	ADDITIONALS FOR FLOOR SPACE INDEX		75.37
24	ADDITIONALS FOR FLOOR SPACE INDEX		75.37
25	ADDITIONALS FOR FLOOR SPACE INDEX		75.37
26	ADDITIONALS FOR FLOOR SPACE INDEX		75.37
27	ADDITIONALS FOR FLOOR SPACE INDEX		75.37
28	ADDITIONALS FOR FLOOR SPACE INDEX		75.37
29	ADDITIONALS FOR FLOOR SPACE INDEX		75.37
30	ADDITIONALS FOR FLOOR SPACE INDEX		75.37
31	ADDITIONALS FOR FLOOR SPACE INDEX		75.37
32	ADDITIONALS FOR FLOOR SPACE INDEX		75.37
33	ADDITIONALS FOR FLOOR SPACE INDEX		75.37
34	ADDITIONALS FOR FLOOR SPACE INDEX		75.37
35	ADDITIONALS FOR FLOOR SPACE INDEX		75.37
36	ADDITIONALS FOR FLOOR SPACE INDEX		75.37
37	ADDITIONALS FOR FLOOR SPACE INDEX		75.37
38	ADDITIONALS FOR FLOOR SPACE INDEX		75.37
39	ADDITIONALS FOR FLOOR SPACE INDEX		75.37
40	ADDITIONALS FOR FLOOR SPACE INDEX		75.37
41	ADDITIONALS FOR FLOOR SPACE INDEX		75.37
42	ADDITIONALS FOR FLOOR SPACE INDEX		75.37
43	ADDITIONALS FOR FLOOR SPACE INDEX		75.37
44	ADDITIONALS FOR FLOOR SPACE INDEX		75.37
45	ADDITIONALS FOR FLOOR SPACE INDEX		75.37
46	ADDITIONALS FOR FLOOR SPACE INDEX		75.37
47	ADDITIONALS FOR FLOOR SPACE INDEX		75.37
48	ADDITIONALS FOR FLOOR SPACE INDEX		75.37
49	ADDITIONALS FOR FLOOR SPACE INDEX		75.37
50	ADDITIONALS FOR FLOOR SPACE INDEX		75.37
51	ADDITIONALS FOR FLOOR SPACE INDEX		75.37
52	ADDITIONALS FOR FLOOR SPACE INDEX		75.37