

**EXISTING BUILT UP AREA STATEMENT**

BLDG NO.	TYPE	GR. FLR.	1st FLR.	2nd FLR.	3rd FLR.	4th FLR.	5th FLR.	6th FLR.	7th FLR.	8th FLR.	9th FLR.	10th FLR.	11th FLR.	12th FLR.	13th FLR.	14th FLR.	EXCESS STAIR & BAL. AREA	TOTAL AREA (SQ. MT.)
2	ST+M	STILT	275.47	219.08	219.08	219.08	219.08	219.08	219.08	157.35	219.08	219.08	219.08	219.08	219.08	219.08	1.24*8.35 = 9.99	2854.32
3	ST+M	STILT	275.47	219.08	219.08	219.08	219.08	219.08	219.08	157.35	219.08	219.08	219.08	219.08	219.08	219.08	1.24*8.35 = 9.99	2854.32
4&5	ST+M	STILT	203.29	221.81	221.81	221.81	221.81	221.81	221.81	240.57	321.81	321.81	321.81	321.81	321.81	321.81	0.57*14 = 7.98	4535.11

TOTAL BUILT UP AREA IN PROPOSED BUILDING = 10,583,14 SQ. MT.

**PROPOSED BUILT UP AREA STATEMENT**

BLDG NO.	TYPE	GR. FLR.	1st FLR.	2nd FLR.	3rd FLR.	4th FLR.	5th FLR.	6th FLR.	7th FLR.	8th FLR.	9th FLR.	10th FLR.	11th FLR.	12th FLR.	13th FLR.	14th FLR.	TOTAL
1	CH	364.82	242.50														852.32
6	ST+M	STILT	187.43														807.43
7	ST+M	STILT	289.12	209.12	289.12	289.12	289.12	289.12	289.12	250.34	289.12						2163.39

TOTAL BUILT UP AREA IN PROPOSED BUILDING = 4923.14 SQ. MT.

**R.G. AREA CALCULATION R.G-2**

UNITS	DIMENSION IN METERS	AREA IN SQ. MT.
12	0.5 x 63.39 x 2.47	54.33
14	0.5 x 21.14 x 18.22	183.90
15	0.5 x 41.00 x 12.31	235.59
15	0.5 x 15.63 x 2.67	24.91
TOTAL		498.73

PLOT A DELETED FROM LAYOUT PLAN & INCLUDED IN S.NO. H.NO. 8 & 9 NO. 33 H.NO. 1A, 1B, 2, OF VILLAGE GODDEV.

**R.G. AREA CALCULATION**

R.G. REQUIRED = 15788.875 X 25% = 3947.21 SQ. MT.

R.G. PROVIDED = 4778.12 SQ. MT.

**R.G. AREA CALCULATION R.G-1**

UNITS	DIMENSION IN METER	AREA IN SQ. M.
1	0.5 x 34.13 x 0.96	187.03
2	0.5 x 34.13 x 25.82	192.23
3	0.5 x 71.25 x 31.53	1230.13
4	0.5 x 70.87 x 18.42	652.71
5	0.5 x 48.71 x 8.50	196.10
6	0.5 x 11.25 x 4.14	147.49
7	0.5 x 4.17 x 3.86	1.79
TOTAL		2855.48

**R.G. AREA CALCULATION R.G-2**

UNITS	DIMENSION IN METERS	AREA IN SQ. M.
8	0.5 x 24.37 x 3.57	41.96
9	0.5 x 33.60 x 10.28	172.70
10	0.5 x 43.99 x 21.85	476.19
11	0.5 x 28.34 x 8.63	121.88
12	0.5 x 21.98 x 19.84	214.14
TOTAL		1125.85

TOTAL R.G. AREA = 2855.48 + 1125.85 + 798.59 = 4778.12 SQ. MT.

**NOTE:**

- BUILDING NO-1, 6, 7 FOR RIMSION
- BUILDING NO-2 & 5 AS PER THE SECTION-BUILDING PLAN VIDE NO MNP/NR/2005/2007-2008 DATED-7-12-2007
- BUILDING NO-4 & 8 AS PER THE SECTION-BUILDING PLAN VIDE NO MNP/NR/2009/2013-2014 DATED-10-09-2013

**PROPOSED BUILT UP AREA STATEMENT**

BLDG NO.	TOTAL BUILT UP AREA	ST/UT AREA	BALCONY AREA	STAIRCASE AREA	TOTAL AREA
1	852.32	-	-	45.91	898.23
2	3084.32	228.475	283.17	438.45	3634.02
3	3084.32	228.475	283.17	438.45	3634.02
4&5	4535.11	413.34	614.34	321.72	5284.51
6	807.43	58.31	130.48	541.66	1497.87
7	2163.39	250.72	342.89	444.02	2957.02
TOTAL	14287.87	1973.36	2653.85	1954.25	18873.33

**ROAD SET BACK AREA**

UNITS	DIMENSION IN METER	AREA IN SQ. M.
1	0.5 x 15.53 x 5.50	42.63
2	0.5 x 15.00 x 14.00	105.00
3	0.5 x 35.00 x 10.00	175.00
4	0.5 x 18.00 x 4.00	36.00
5	0.5 x 37.00 x 18.00	333.00
6	0.5 x 37.50 x 18.00	337.50
7	0.5 x 17.00 x 18.00	153.00
8	0.5 x 9.00 x 2.00	9.00
TOTAL		1221.13

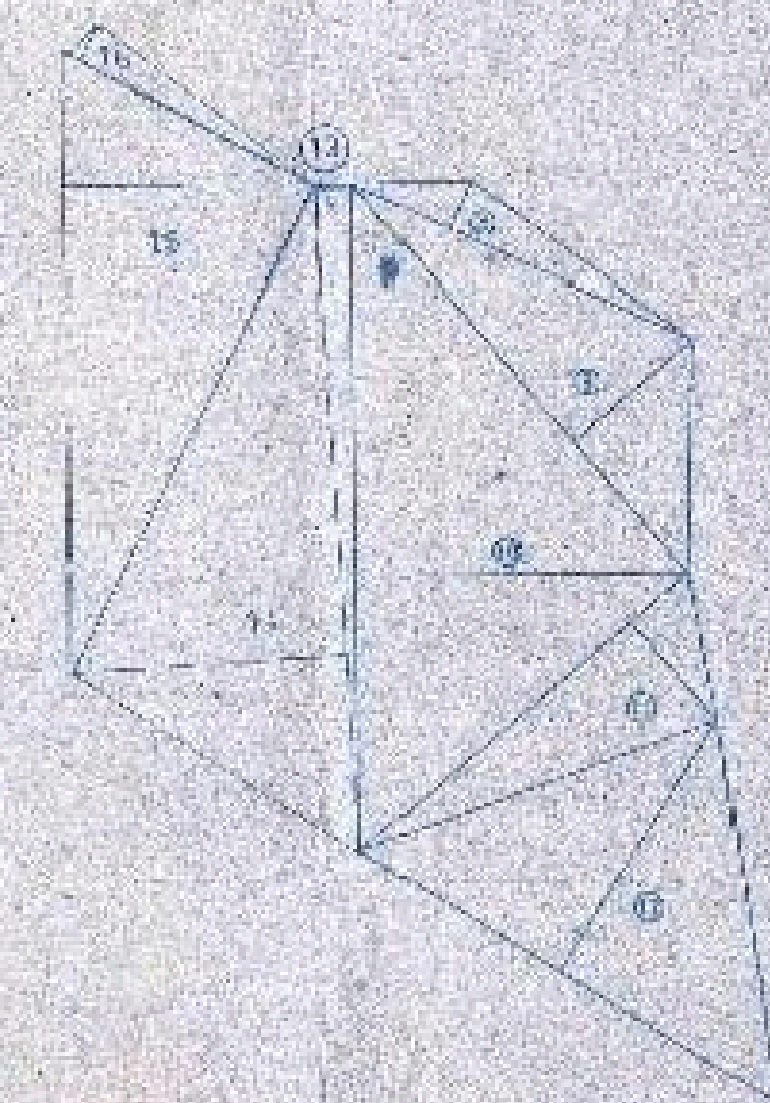
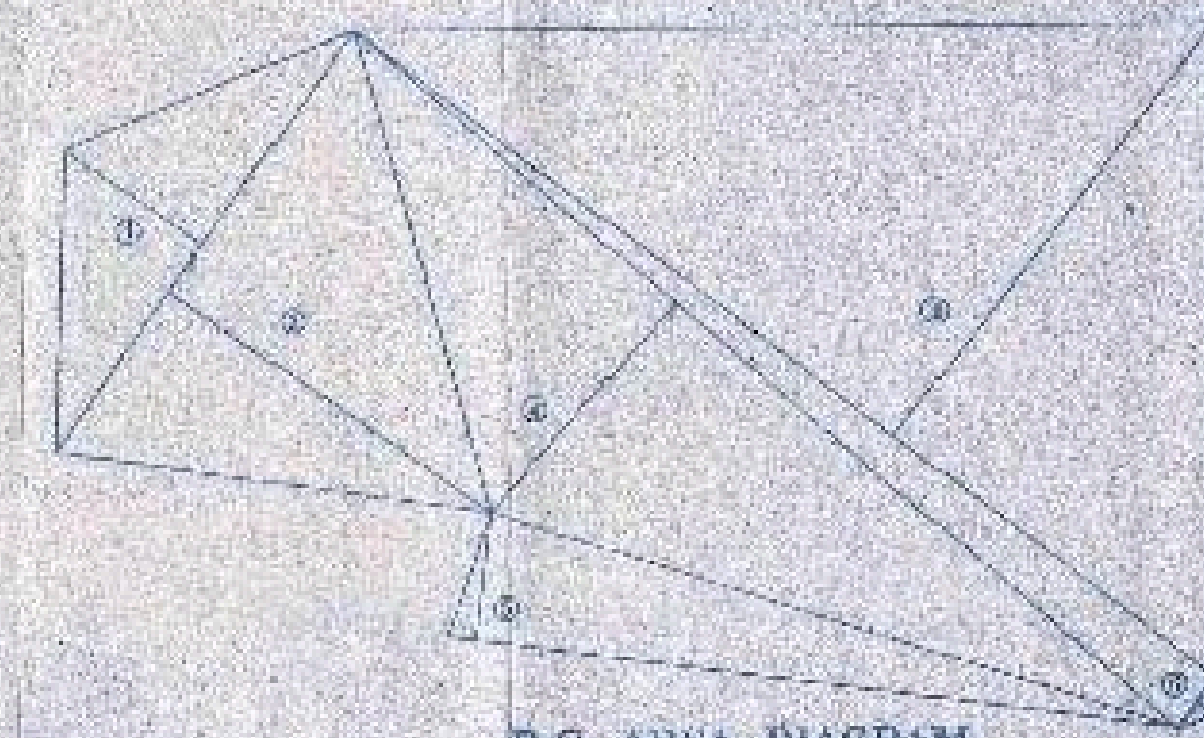

**PLOT AREA CALCULATION**

UNITS	DIMENSION IN METER	AREA IN SQ. M.
9	0.5 x 12.00 x 12.50	75.00
10	0.5 x 12.00 x 11.00	66.00
11	0.5 x 125.00 x 25.00	1562.50
12	0.5 x 38.00 x 8.00	304.00
13	0.5 x 38.00 x 21.00	399.00
14	0.5 x 112.00 x 31.50	1764.00
15	0.5 x 62.00 x 16.50	507.00
16	0.5 x 29.00 x 8.50	123.25
17	0.5 x 75.00 x 22.00	825.00
18	0.5 x 35.00 x 14.50	623.75
19	0.5 x 36.00 x 18.00	774.00
20	0.5 x 36.00 x 18.00	612.00
21	0.5 x 13.00 x 51.50	2688.75
22	0.5 x 58.00 x 28.00	932.00
23	0.5 x 65.00 x 31.00	1007.25
24	0.5 x 57.60 x 17.20	495.15
25	0.5 x 21.80 x 8.50	93.70
26	0.5 x 55.70 x 10.00	448.50
27	0.5 x 39.50 x 28.00	973.00
28	0.5 x 37.12 x 13.47	250.00
TOTAL		16276.21

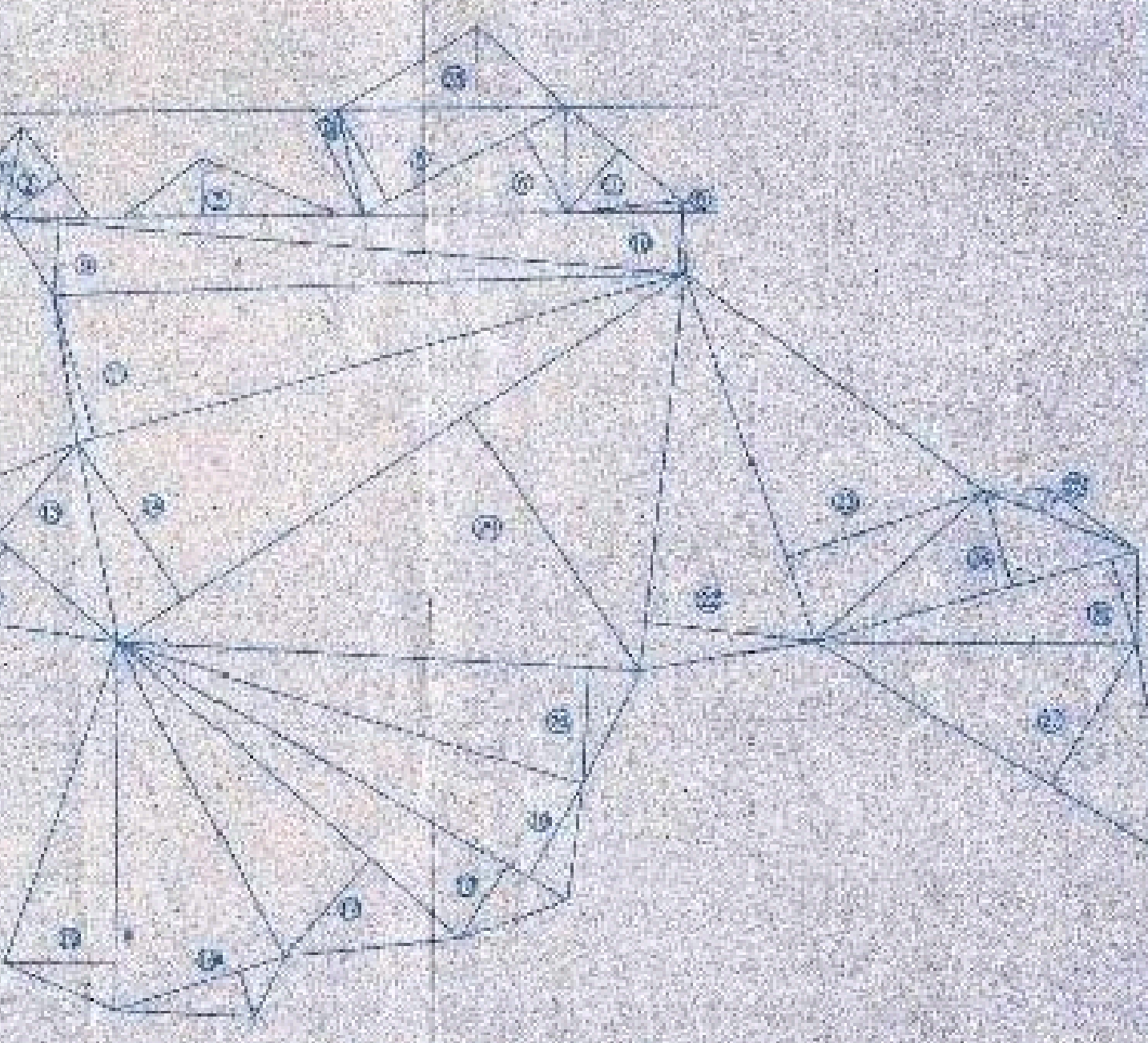

**PROPOSED SITE UNDER**

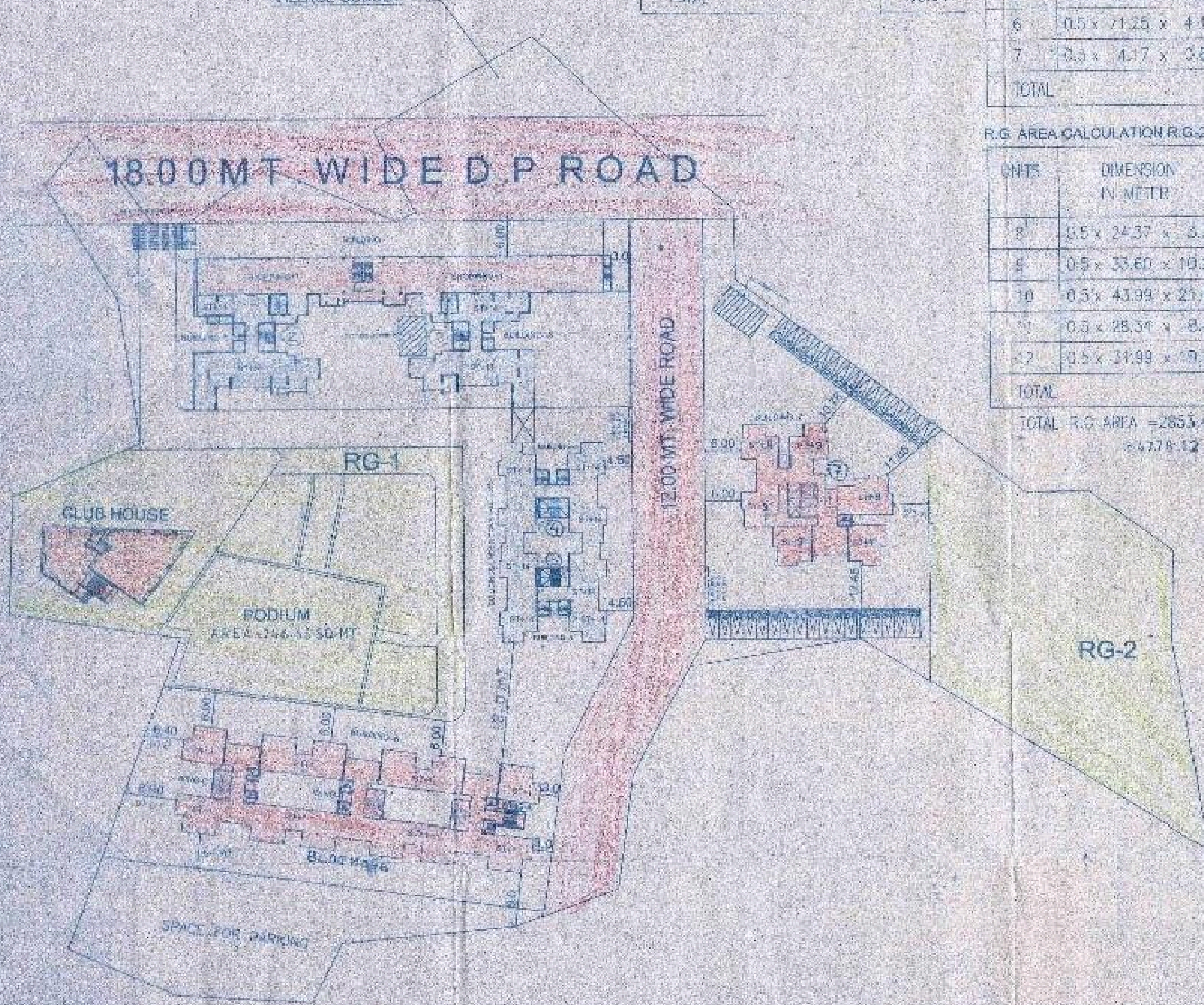
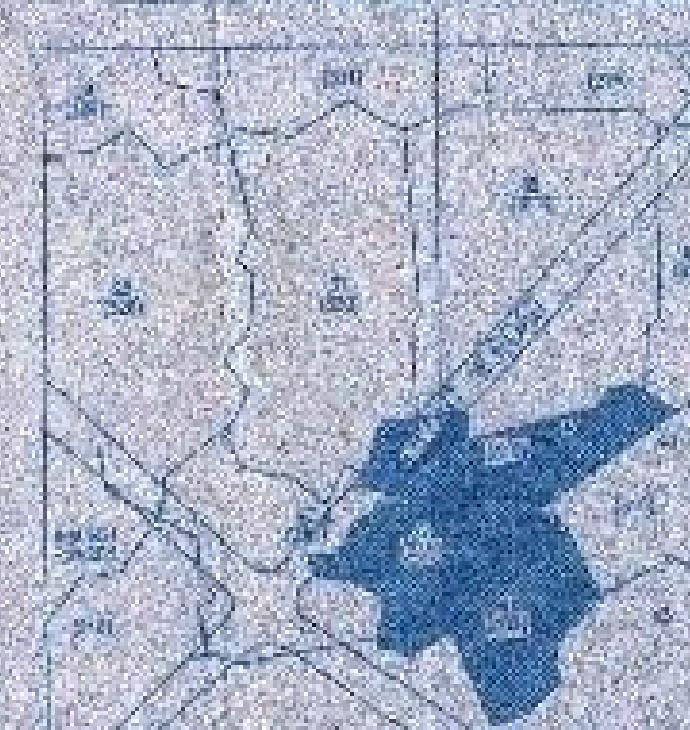

**A. AREA STATEMENT SQ. MT.**

1	AREA OF PLOT AS PER 7/12 EXTRACT S.NO. 311/28	4318.00
2	AREA OF PLOT AS PER 7/12 EXTRACT S.NO. 311/28	100.00
3	AREA OF PLOT AS PER 7/12 EXTRACT S.NO. 311/28	610.00
4	AREA OF PLOT AS PER 7/12 EXTRACT S.NO. 311/28	2360.00
5	AREA OF PLOT AS PER 7/12 EXTRACT S.NO. 311/28	3700.00
6	AREA OF PLOT AS PER 7/12 EXTRACT S.NO. 311/28	400.00
7	AREA OF PLOT AS PER 7/12 EXTRACT S.NO. 311/28	3280.00
8	TOTAL AREA OF PLOT	17388.00
9	ROAD SET BACK	1221.12
10	NON-DEVELOPMENT	18938.88
11	AREA OF PLOT	16077.76
12	AREA OF PLOT	15078.88
13	DISCOUNT FOR R.O.	3888.88
14	SETBACK OF PLOT	14470.00
15	ADDITION OF P.S.I.	1400.18
16	TOTAL AREA	14661.69
17	PERMISSIBLE	1.00
18	PERMISSIBLE AVAILABLE BY PLOT	14660.69
19	PERMISSIBLE FLOOR AREA	11523.57
20	EXISTING FLOOR AREA (G.O. NO. 7/12)	10558.52
21	PROPOSED AREA	10223.55
22	EXCESS FLOOR AREA IN P.S.I.	1295.02
23	TOTAL FLOOR AREA	21518.57
24	BALCONY AREA STATEMENT	
25	PERMISSIBLE BALCONY AREA PER FLOOR	
26	PROPOSED BALCONY AREA PER FLOOR	
27	EXCESS BALCONY AREA PER FLOOR	
28	TENEMENT STATEMENT	
29	TOTAL BUILT UP AREA	14661.69
30	PERMISSIBLE BALCONY AREA FOR NON-FRESH AREA	10223.55
31	PERMISSIBLE AVAILABLE FOR TENEMENT	11523.57
32	EXISTING TENEMENT	
33	NEW TENEMENT	
34	TOTAL TENEMENT	
35	PARKING STATEMENT	
36	PERMISSIBLE PARKING	
37	PROPOSED PARKING	

**CERTIFICATE OF AREA**

WE HEREBY CERTIFY THAT THE AREA OF THE PLOT AS SHOWN IN THE BLOCK PLAN IS CORRECT AND ACCURATE AS PER THE MEASUREMENTS MADE BY US AND AS SHOWN IN THE BLOCK PLAN. WE HAVE NOTED THAT THE PLOT IS NOT AGRICULTURAL LAND AND IS NOT AGRICULTURAL LAND AS PER THE RECORDS OF THE GOVERNMENT OF GUJARAT.

**DESCRIPTION OF PROPOSAL**

PROPOSED DEVELOPMENT OF PLOT AS SHOWN IN THE BLOCK PLAN. THE PLOT IS NOT AGRICULTURAL LAND AND IS NOT AGRICULTURAL LAND AS PER THE RECORDS OF THE GOVERNMENT OF GUJARAT.

**CONTENTS OF SHEET**

DRN BY	NORTH
SUNIL	
CHIEF BY	D.N.PATEL AND ASSOCIATES
D.N.PATEL	DISCREET SURVEYOR & ENGINEER & CIVIL CONSULTANT
SHEET NO.	NAVAMHAR ROAD BHAYKANTPURA
	PH. 28188108