

TRIRACH DESIGN STUDIO
ARCHITECTS AND INTERIOR DESIGNERS
18th MAR 2020
2019/A-1691/AS SHOWN
18th MAR 2020
2019/A-1691/3
2019/A-1691/3

DRG. NO. 2019/A-1691/3
DRAWN BY DINESH P
DATE 18th MAR 2020
SCALE NORTH

MR. DILIP BALARAM PATIL (Partner)
M/S. SHUBHAM INFRA
OWNERS / P.A.H.
VILLAGE - GHOT, TAL. PANVEL, DIST. RAIGAD.
S. NO. - 66, H. NO. 8, 10, 11 & 12,
PROPOSED RESIDENTIAL BUILDING ON

PROJECT

U/G TANK	17.500 LTRS.	772.500 LTRS.
CH. H. TANK	8.000 LTRS.	368.000 LTRS.
TOTAL	25.500 LTRS.	1140.500 LTRS.

A. WATER CAPACITY CALCULATION

1. PERMISSIBLE BALCONY AREA	1203.222
2. PROPOSED BALCONY AREA	1195.114
3. EXCESS BALCONY AREA	0.000

B. BALCONY AREA STATEMENT (BUILDING-1, 2 & 3)

13. BALCONY AREA	3.518
12. TOTAL PROPOSED BUILT-UP AREA	9168.306
11. PROPOSED BUA	2161.165
a) BUILDING-01 (2161.165 x 1 Nos.)	2161.165
b) BUILDING-02 (2558.477 x 1 Nos.)	2558.477
c) BUILDING-03 (348.664 x 1 Nos.)	348.664
WING - A & B (STILT + 7th Floor) (Building)	348.664
14. TOTAL RESIDENTIAL UNIT	188 Nos.

C. WATER CAPACITY CALCULATION

1. Area of plot (as per 7/12)	7090.000
2. Road Widening Area	726.335
3. Balance Area (1-2)	6363.665
4. Required R. G. Area (10% OF 3)	636.366
5. Proposed R. G. Area	686.546
6. NET PLOT AREA (90% OF (3))	5727.299
7. PERMISSIBLE BUILT-UP AREA (6X7)	1.100
8. PERMISSIBLE BUILT-UP AREA (6X7)	6300.029
9. ADDITION OF F.S.I. (IF ANY)	726.335
10. TOTAL PERMISSIBLE BUILT-UP AREA (8+9)	8171.824
11. PROPOSED BUA	2161.165
12. TOTAL PROPOSED BUILT-UP AREA	9168.306
13. BALCONY AREA	3.518
14. TOTAL RESIDENTIAL UNIT	188 Nos.

D. PARKING STATEMENT

1. NO. OF RESIDENTS IN THE PLOT	188
2. NO. OF CARS PER RESIDENT	1.0
3. NO. OF CARS REQUIRED	188
4. NO. OF CARS PROVIDED	188
5. NO. OF SCOOTERS PER RESIDENT	1.0
6. NO. OF SCOOTERS REQUIRED	188
7. NO. OF SCOOTERS PROVIDED	188

E. SEPTIC TANK CALCULATION

1. NO. OF RESIDENTS IN THE PLOT	188
2. NO. OF CARS PER RESIDENT	1.0
3. NO. OF CARS PROVIDED	188
4. NO. OF CARS REQUIRED	188
5. NO. OF SCOOTERS PER RESIDENT	1.0
6. NO. OF SCOOTERS REQUIRED	188
7. NO. OF SCOOTERS PROVIDED	188

F. ROAD WIDENING AREA CALCULATION

1. ROAD WIDENING AREA (RWA) CALCULATION	726.335
2. ROAD WIDENING AREA (RWA) CALCULATION	726.335
3. ROAD WIDENING AREA (RWA) CALCULATION	726.335

G. SEPTIC TANK & SOAK PIT

SECTION THRO' U/G TANK
SCALE = NTS

SECTION THRO' U/G TANK
SCALE = NTS

TYPICAL GATE SECTION
SCALE = NTS

TYPICAL WALL DETAIL
SCALE = NTS

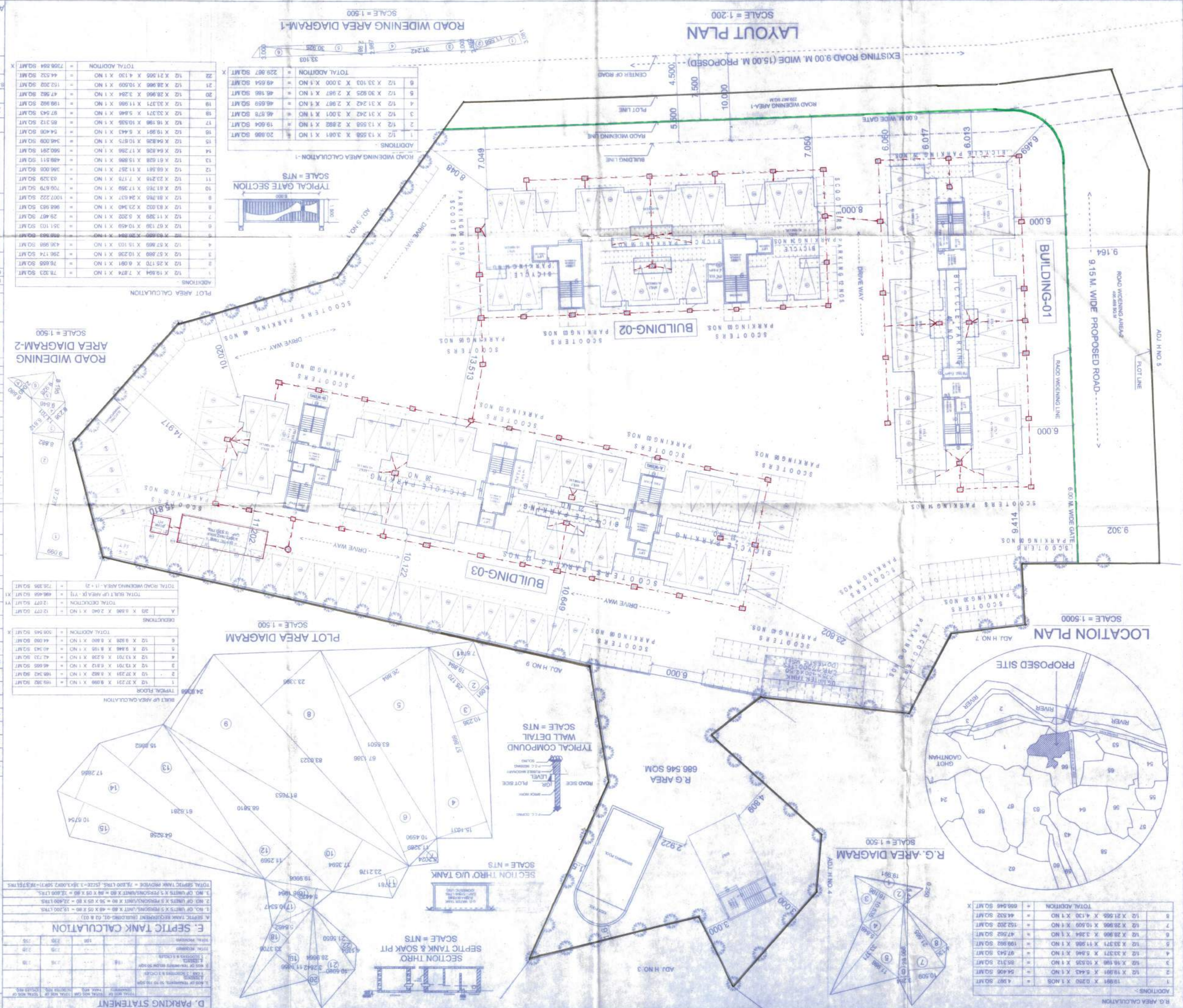

ADJ. H. NO. 5
ADJ. H. NO. 7
ADJ. H. NO. 4
ADJ. H. NO. 3

EXISTING ROAD 9.00 M. WIDE (15.00 M. PROPOSED)
EXISTING ROAD 9.00 M. WIDE (15.00 M. PROPOSED)
EXISTING ROAD 9.00 M. WIDE (15.00 M. PROPOSED)

PROPOSED ROAD 9.00 M. WIDE (15.00 M. PROPOSED)
PROPOSED ROAD 9.00 M. WIDE (15.00 M. PROPOSED)
PROPOSED ROAD 9.00 M. WIDE (15.00 M. PROPOSED)

ADJ. H. NO. 1
ADJ. H. NO. 2
ADJ. H. NO. 3
ADJ. H. NO. 4
ADJ. H. NO. 5
ADJ. H. NO. 6
ADJ. H. NO. 7
ADJ. H. NO. 8
ADJ. H. NO. 9

ADJ. H. NO. 1
ADJ. H. NO. 2
ADJ. H. NO. 3
ADJ. H. NO. 4
ADJ. H. NO. 5
ADJ. H. NO. 6
ADJ. H. NO. 7
ADJ. H. NO. 8
ADJ. H. NO. 9

ADJ. H. NO. 1
ADJ. H. NO. 2
ADJ. H. NO. 3
ADJ. H. NO. 4
ADJ. H. NO. 5
ADJ. H. NO. 6
ADJ. H. NO. 7
ADJ. H. NO. 8
ADJ. H. NO. 9

ADJ. H. NO. 1
ADJ. H. NO. 2
ADJ. H. NO. 3
ADJ. H. NO. 4
ADJ. H. NO. 5
ADJ. H. NO. 6
ADJ. H. NO. 7
ADJ. H. NO. 8
ADJ. H. NO. 9

ADJ. H. NO. 1
ADJ. H. NO. 2
ADJ. H. NO. 3
ADJ. H. NO. 4
ADJ. H. NO. 5
ADJ. H. NO. 6
ADJ. H. NO. 7
ADJ. H. NO. 8
ADJ. H. NO. 9

ADJ. H. NO. 1
ADJ. H. NO. 2
ADJ. H. NO. 3
ADJ. H. NO. 4
ADJ. H. NO. 5
ADJ. H. NO. 6
ADJ. H. NO. 7
ADJ. H. NO. 8
ADJ. H. NO. 9

ADJ. H. NO. 1
ADJ. H. NO. 2
ADJ. H. NO. 3
ADJ. H. NO. 4
ADJ. H. NO. 5
ADJ. H. NO. 6
ADJ. H. NO. 7
ADJ. H. NO. 8
ADJ. H. NO. 9

ADJ. H. NO. 1
ADJ. H. NO. 2
ADJ. H. NO. 3
ADJ. H. NO. 4
ADJ. H. NO. 5
ADJ. H. NO. 6
ADJ. H. NO. 7
ADJ. H. NO. 8
ADJ. H. NO. 9