

STAMP OF APPROVAL

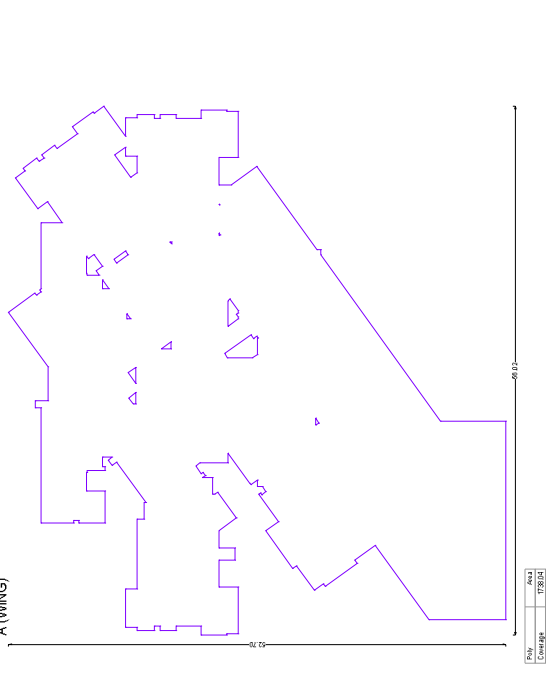

NO.	DESCRIPTION	UNIT	QUANTITY	UNIT PRICE	TOTAL
1.	AREA OF PLOT FOR	SQ.M	1488.24		
2.	AREA OF PLOT FOR	SQ.M	0.00		
3.	AREA OF PLOT FOR	SQ.M	0.00		
4.	AREA OF PLOT FOR	SQ.M	0.00		
5.	AREA OF PLOT FOR	SQ.M	0.00		
6.	AREA OF PLOT FOR	SQ.M	0.00		
7.	AREA OF PLOT FOR	SQ.M	0.00		
8.	AREA OF PLOT FOR	SQ.M	0.00		
9.	AREA OF PLOT FOR	SQ.M	0.00		
10.	AREA OF PLOT FOR	SQ.M	0.00		
11.	AREA OF PLOT FOR	SQ.M	0.00		
12.	AREA OF PLOT FOR	SQ.M	0.00		
13.	AREA OF PLOT FOR	SQ.M	0.00		
14.	AREA OF PLOT FOR	SQ.M	0.00		
15.	AREA OF PLOT FOR	SQ.M	0.00		
16.	AREA OF PLOT FOR	SQ.M	0.00		
17.	AREA OF PLOT FOR	SQ.M	0.00		
18.	AREA OF PLOT FOR	SQ.M	0.00		
19.	AREA OF PLOT FOR	SQ.M	0.00		
20.	AREA OF PLOT FOR	SQ.M	0.00		
21.	AREA OF PLOT FOR	SQ.M	0.00		
22.	AREA OF PLOT FOR	SQ.M	0.00		
23.	AREA OF PLOT FOR	SQ.M	0.00		
24.	AREA OF PLOT FOR	SQ.M	0.00		
25.	AREA OF PLOT FOR	SQ.M	0.00		
26.	AREA OF PLOT FOR	SQ.M	0.00		
27.	AREA OF PLOT FOR	SQ.M	0.00		
28.	AREA OF PLOT FOR	SQ.M	0.00		
29.	AREA OF PLOT FOR	SQ.M	0.00		
30.	AREA OF PLOT FOR	SQ.M	0.00		
31.	AREA OF PLOT FOR	SQ.M	0.00		
32.	AREA OF PLOT FOR	SQ.M	0.00		
33.	AREA OF PLOT FOR	SQ.M	0.00		
34.	AREA OF PLOT FOR	SQ.M	0.00		
35.	AREA OF PLOT FOR	SQ.M	0.00		
36.	AREA OF PLOT FOR	SQ.M	0.00		
37.	AREA OF PLOT FOR	SQ.M	0.00		
38.	AREA OF PLOT FOR	SQ.M	0.00		
39.	AREA OF PLOT FOR	SQ.M	0.00		
40.	AREA OF PLOT FOR	SQ.M	0.00		
41.	AREA OF PLOT FOR	SQ.M	0.00		
42.	AREA OF PLOT FOR	SQ.M	0.00		
43.	AREA OF PLOT FOR	SQ.M	0.00		
44.	AREA OF PLOT FOR	SQ.M	0.00		
45.	AREA OF PLOT FOR	SQ.M	0.00		
46.	AREA OF PLOT FOR	SQ.M	0.00		
47.	AREA OF PLOT FOR	SQ.M	0.00		
48.	AREA OF PLOT FOR	SQ.M	0.00		
49.	AREA OF PLOT FOR	SQ.M	0.00		
50.	AREA OF PLOT FOR	SQ.M	0.00		

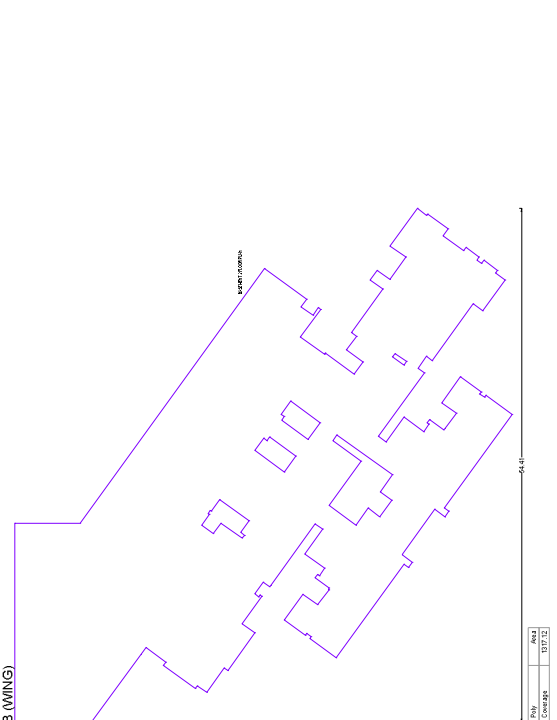
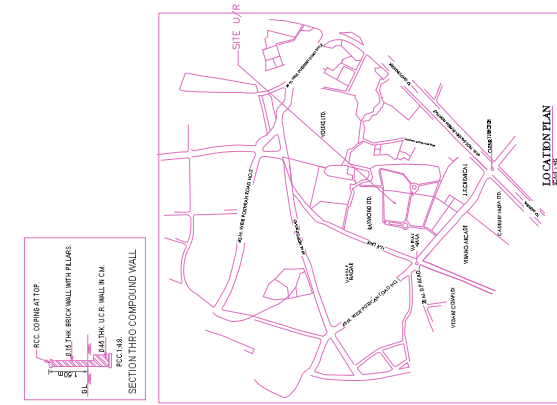

TYPE	AREA (SQ.M)	PERCENTAGE
Area 1	137.12	
Area 2	137.12	
Area 3	137.12	
Area 4	137.12	
Area 5	137.12	
Area 6	137.12	
Area 7	137.12	
Area 8	137.12	
Area 9	137.12	
Area 10	137.12	
TOTAL	1371.2	100%

CERTIFICATE OF AREA
 I hereby certify that the area shown on the plan is correct and true to the original survey and that the same has been measured and calculated in accordance with the provisions of the Survey Act, 1975 and the Survey Rules, 1975 and that the same has been approved by the Survey Officer, District Survey Office, District of ...

GENERAL NOTES
 1. THE ARCHITECT SHALL BE RESPONSIBLE FOR THE DESIGN OF THE BUILDING AND THE STRUCTURE.
 2. THE ARCHITECT SHALL BE RESPONSIBLE FOR THE DESIGN OF THE SERVICES AND THE INSTALLATION THEREOF.
 3. THE ARCHITECT SHALL BE RESPONSIBLE FOR THE DESIGN OF THE LANDSCAPE AND THE PLANTING THEREOF.
 4. THE ARCHITECT SHALL BE RESPONSIBLE FOR THE DESIGN OF THE INTERIOR AND THE EXTERIOR FINISHES.
 5. THE ARCHITECT SHALL BE RESPONSIBLE FOR THE DESIGN OF THE ELECTRICAL AND MECHANICAL SERVICES.
 6. THE ARCHITECT SHALL BE RESPONSIBLE FOR THE DESIGN OF THE SANITARY AND WATER SUPPLY SERVICES.
 7. THE ARCHITECT SHALL BE RESPONSIBLE FOR THE DESIGN OF THE PAVEMENT AND THE ROADS.
 8. THE ARCHITECT SHALL BE RESPONSIBLE FOR THE DESIGN OF THE FENCE AND THE GATE.
 9. THE ARCHITECT SHALL BE RESPONSIBLE FOR THE DESIGN OF THE SIGNAGE AND THE IDENTIFICATION.
 10. THE ARCHITECT SHALL BE RESPONSIBLE FOR THE DESIGN OF THE SECURITY AND THE PROTECTION.
 11. THE ARCHITECT SHALL BE RESPONSIBLE FOR THE DESIGN OF THE MAINTENANCE AND THE REPAIRS.
 12. THE ARCHITECT SHALL BE RESPONSIBLE FOR THE DESIGN OF THE OPERATION AND THE MANAGEMENT.
 13. THE ARCHITECT SHALL BE RESPONSIBLE FOR THE DESIGN OF THE EVALUATION AND THE IMPROVEMENT.
 14. THE ARCHITECT SHALL BE RESPONSIBLE FOR THE DESIGN OF THE DOCUMENTATION AND THE RECORDS.
 15. THE ARCHITECT SHALL BE RESPONSIBLE FOR THE DESIGN OF THE COMMUNICATION AND THE COORDINATION.
 16. THE ARCHITECT SHALL BE RESPONSIBLE FOR THE DESIGN OF THE MONITORING AND THE CONTROL.
 17. THE ARCHITECT SHALL BE RESPONSIBLE FOR THE DESIGN OF THE REPORTING AND THE ACCOUNTING.
 18. THE ARCHITECT SHALL BE RESPONSIBLE FOR THE DESIGN OF THE TRAINING AND THE EDUCATION.
 19. THE ARCHITECT SHALL BE RESPONSIBLE FOR THE DESIGN OF THE RESEARCH AND THE DEVELOPMENT.
 20. THE ARCHITECT SHALL BE RESPONSIBLE FOR THE DESIGN OF THE INNOVATION AND THE CREATIVITY.

TYPE	AREA (SQ.M)	PERCENTAGE	CYCLE (NO.)
Residential	814.95	55.00	0
Commercial	104.05	7.00	1
Industrial	104.05	7.00	1
Public	104.05	7.00	1
Other	104.05	7.00	1
Total	1431.10	100%	5

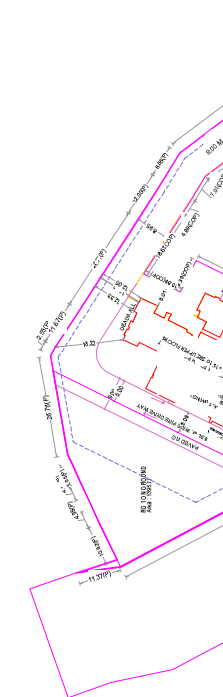

DESCRIPTION	AREA (SQ.M)	PERCENTAGE
NET PLOT AREA	1170.05	80.00
REQUIRED G.O. ON GROUND	2892.51	247.22
PROPOSED R.O.	954.53	81.66
PROPOSED R.O. ON GROUND	1352.71	115.61
PROPOSED R.O. ON GROUND TOP	1046.61	89.40
PROPOSED R.O. ON GROUND BOTTOM	739.43	63.20
TOTAL R.O. PROVIDED	4822.31	412.87

OWNER'S NAME: ...
OWNER'S ADDRESS: ...
PROJECT: ...
DATE: ...

ARCHITECT'S NAME: ...
ARCHITECT'S ADDRESS: ...
SCALE: 1:500
DATE: ...

GENERAL NOTES
 1. THE ARCHITECT SHALL BE RESPONSIBLE FOR THE DESIGN OF THE BUILDING AND THE STRUCTURE.
 2. THE ARCHITECT SHALL BE RESPONSIBLE FOR THE DESIGN OF THE SERVICES AND THE INSTALLATION THEREOF.
 3. THE ARCHITECT SHALL BE RESPONSIBLE FOR THE DESIGN OF THE LANDSCAPE AND THE PLANTING THEREOF.
 4. THE ARCHITECT SHALL BE RESPONSIBLE FOR THE DESIGN OF THE INTERIOR AND THE EXTERIOR FINISHES.
 5. THE ARCHITECT SHALL BE RESPONSIBLE FOR THE DESIGN OF THE ELECTRICAL AND MECHANICAL SERVICES.
 6. THE ARCHITECT SHALL BE RESPONSIBLE FOR THE DESIGN OF THE SANITARY AND WATER SUPPLY SERVICES.
 7. THE ARCHITECT SHALL BE RESPONSIBLE FOR THE DESIGN OF THE PAVEMENT AND THE ROADS.
 8. THE ARCHITECT SHALL BE RESPONSIBLE FOR THE DESIGN OF THE FENCE AND THE GATE.
 9. THE ARCHITECT SHALL BE RESPONSIBLE FOR THE DESIGN OF THE SIGNAGE AND THE IDENTIFICATION.
 10. THE ARCHITECT SHALL BE RESPONSIBLE FOR THE DESIGN OF THE SECURITY AND THE PROTECTION.
 11. THE ARCHITECT SHALL BE RESPONSIBLE FOR THE DESIGN OF THE MAINTENANCE AND THE REPAIRS.
 12. THE ARCHITECT SHALL BE RESPONSIBLE FOR THE DESIGN OF THE OPERATION AND THE MANAGEMENT.
 13. THE ARCHITECT SHALL BE RESPONSIBLE FOR THE DESIGN OF THE EVALUATION AND THE IMPROVEMENT.
 14. THE ARCHITECT SHALL BE RESPONSIBLE FOR THE DESIGN OF THE DOCUMENTATION AND THE RECORDS.
 15. THE ARCHITECT SHALL BE RESPONSIBLE FOR THE DESIGN OF THE COMMUNICATION AND THE COORDINATION.
 16. THE ARCHITECT SHALL BE RESPONSIBLE FOR THE DESIGN OF THE MONITORING AND THE CONTROL.
 17. THE ARCHITECT SHALL BE RESPONSIBLE FOR THE DESIGN OF THE REPORTING AND THE ACCOUNTING.
 18. THE ARCHITECT SHALL BE RESPONSIBLE FOR THE DESIGN OF THE TRAINING AND THE EDUCATION.
 19. THE ARCHITECT SHALL BE RESPONSIBLE FOR THE DESIGN OF THE RESEARCH AND THE DEVELOPMENT.
 20. THE ARCHITECT SHALL BE RESPONSIBLE FOR THE DESIGN OF THE INNOVATION AND THE CREATIVITY.

DESCRIPTION	AREA (SQ.M)	PERCENTAGE
NET PLOT AREA	1170.05	80.00
REQUIRED G.O. ON GROUND	2892.51	247.22
PROPOSED R.O.	954.53	81.66
PROPOSED R.O. ON GROUND	1352.71	115.61
PROPOSED R.O. ON GROUND TOP	1046.61	89.40
PROPOSED R.O. ON GROUND BOTTOM	739.43	63.20
TOTAL R.O. PROVIDED	4822.31	412.87

THIS IS A PRELIMINARY DRAWING AND NOT TO BE USED FOR CONSTRUCTION WITHOUT THE ARCHITECT'S PERMISSION.