

HOLDING AREA STATEMENT

S.NO.	H.NO.	PLOT AREA IN SQ. FT.
395	2/3	3820.00 SQ.MT.
396	1/2	1000.00 SQ.MT.
398	2/1/2	6570.00 SQ.MT.
399	1/1/1	1070.00 SQ.MT.
TOTAL		12860.00 SQ.MT.

TOTAL AREA STATEMENT (INCLUDING MHADA AREA)

BLDG	WING	BUILT-UP AREA		FREE OF SET WITH PREMIUM							
		FLOOR AREA	ROOF AREA	BALCONY AREA	STAIRCASE AREA	COMMON AREA	COVERED TERRACE AREA	STREET AREA	OPEN SPACE	TERRACE AREA	
1		2847.83	2847.83	3421.14	3708.58	343.21	-	-	-	-	-
2		2816.4	2816.4	356.0	189.4	493.09	144.80	-	-	-	-
GRAND TOTAL		5664.23	5664.23	3977.14	5607.98	836.21	144.80	-	-	-	-

TOTAL BUILT UP AREA STATEMENT

BLDG	FLOOR AREA	ROOF AREA	TOTAL B/D AREA
1	2847.83	2847.83	5695.66
2	2816.4	2816.4	5632.8
TOTAL	5664.23	5664.23	11328.46

HOLDING AREA DIAGRAM
(SCALE 1:1000)

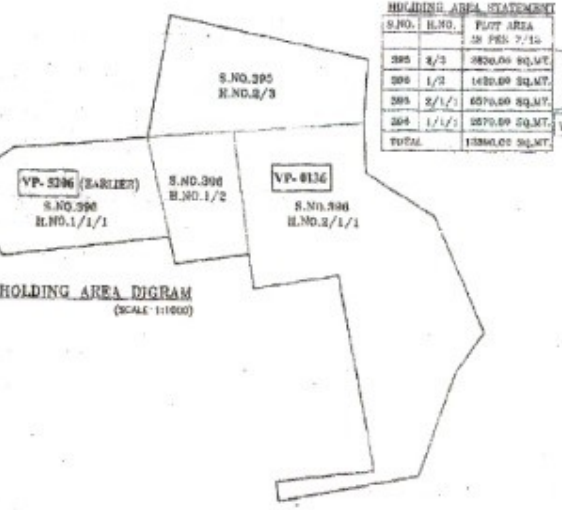

LOCATION PLAN
(SCALE 1:5000)



PARKING AREA STATEMENT

BLDG NO.	NO. OF FLOORS	REQUIRED	PROVIDED	REQUIRE	PROVIDED
BLDG NO. 1	100	37.01	30.00	-	-
BLDG NO. 2	80	71.00	72.00	50.00	50.00
GRAND TOTAL	180	108.01	102.00	50.00	50.00

REQUIRED UTILITY OF AREA MHADA (10000.00) = 1072.70 SQ.MT.
BUILT-UP AREA PROPOSED PER AREA = 1306.30 SQ.MT.

VP 0136

(A) PLOT AREA CALCULATION

- (I) AREA UNDER 30.00 M/W D.P. ROAD**
- 1 41.00 x 21.45 x 0.50 = 439.03 SQMT
 - 2 41.00 x 10.10 x 0.50 = 207.05 SQMT
 - 3 28.00 x 5.10 x 0.50 = 71.70 SQMT
 - 4 38.00 x 14.35 x 0.50 = 272.68 SQMT
 - 5 28.15 x 5.80 x 0.50 = 81.62 SQMT
- TOTAL AREA = 1072.08 SQMT**

(II) AREA UNDER 30.00 M/W D.P. ROAD

- 6 48.80 x 3.75 x 0.50 = 91.50 SQMT
 - 7 13.80 x 3.85 x 0.50 = 26.44 SQMT
 - 8 73.70 x 13.80 x 0.50 = 253.09 SQMT
 - 9 78.35 x 14.15 x 0.50 = 279.53 SQMT
 - 10 13.50 x 15.75 x 0.50 = 106.31 SQMT
 - 11 25.80 x 13.60 x 0.50 = 175.22 SQMT
 - 12 23.70 x 11.90 x 0.50 = 140.38 SQMT
- TOTAL AREA = 896.87 SQMT**

(III) AREA UNDER CHANNEL RESERVATION (PROPOSED)

- (A)**
- 13 42.00 x 14.40 x 0.50 = 302.40 SQMT
 - 14 48.00 x 10.81 x 0.50 = 259.38 SQMT
 - 15 45.10 x 11.10 x 0.50 = 250.96 SQMT
- TOTAL AREA = 812.74 SQMT**

(B) AREA UNDER ENCROACHMENT

- 16 79.00 x 1.15 x 0.50 = 45.53 SQMT
 - 17 54.04 x 4.70 x 0.50 = 127.59 SQMT
- TOTAL AREA = 173.12 SQMT**

(VI) AREA UNDER CHANNEL RESERVATION

- 18 6.70 x 3.50 x 0.50 = 11.73 SQMT
 - 19 53.85 x 1.50 x 0.50 = 40.39 SQMT
 - 20 43.40 x 7.60 x 0.50 = 165.38 SQMT
- TOTAL AREA = 217.50 SQMT**

(V) AREA UNDER RESIDENTIAL ZONE

- 21 14.45 x 5.90 x 0.50 = 42.51 SQMT
 - 22 48.40 x 3.20 x 0.50 = 77.45 SQMT
 - 23 12.80 x 15.85 x 0.50 = 101.36 SQMT
 - 24 72.00 x 33.75 x 0.50 = 1213.38 SQMT
 - 25 40.20 x 16.35 x 0.50 = 328.58 SQMT
 - 26 10.55 x 8.90 x 0.50 = 46.81 SQMT
 - 27 15.35 x 23.50 x 0.50 = 180.74 SQMT
 - 28 56.30 x 29.60 x 0.50 = 831.48 SQMT
 - 29 14.50 x 11.70 x 0.50 = 84.38 SQMT
 - 30 13.70 x 27.05 x 0.50 = 185.62 SQMT
- TOTAL AREA = 3193.38 SQMT**

(I) PLOT AREA CALCULATION

- 1 86.75 x 3.80 x 0.50 = 164.85 SQMT
 - 2 63.75 x 3.60 x 0.50 = 114.75 SQMT
- TOTAL AREA = 279.60 SQMT**

(II) AREA UNDER RESIDENTIAL ZONE

- 3 36.70 x 14.85 x 0.50 = 272.48 SQMT
 - 4 44.20 x 14.70 x 0.50 = 324.77 SQMT
 - 5 83.44 x 14.80 x 0.50 = 616.19 SQMT
 - 6 66.50 x 30.80 x 0.50 = 1021.90 SQMT
 - 7 30.40 x 6.25 x 0.50 = 95.50 SQMT
- TOTAL AREA = 2331.93 SQMT**

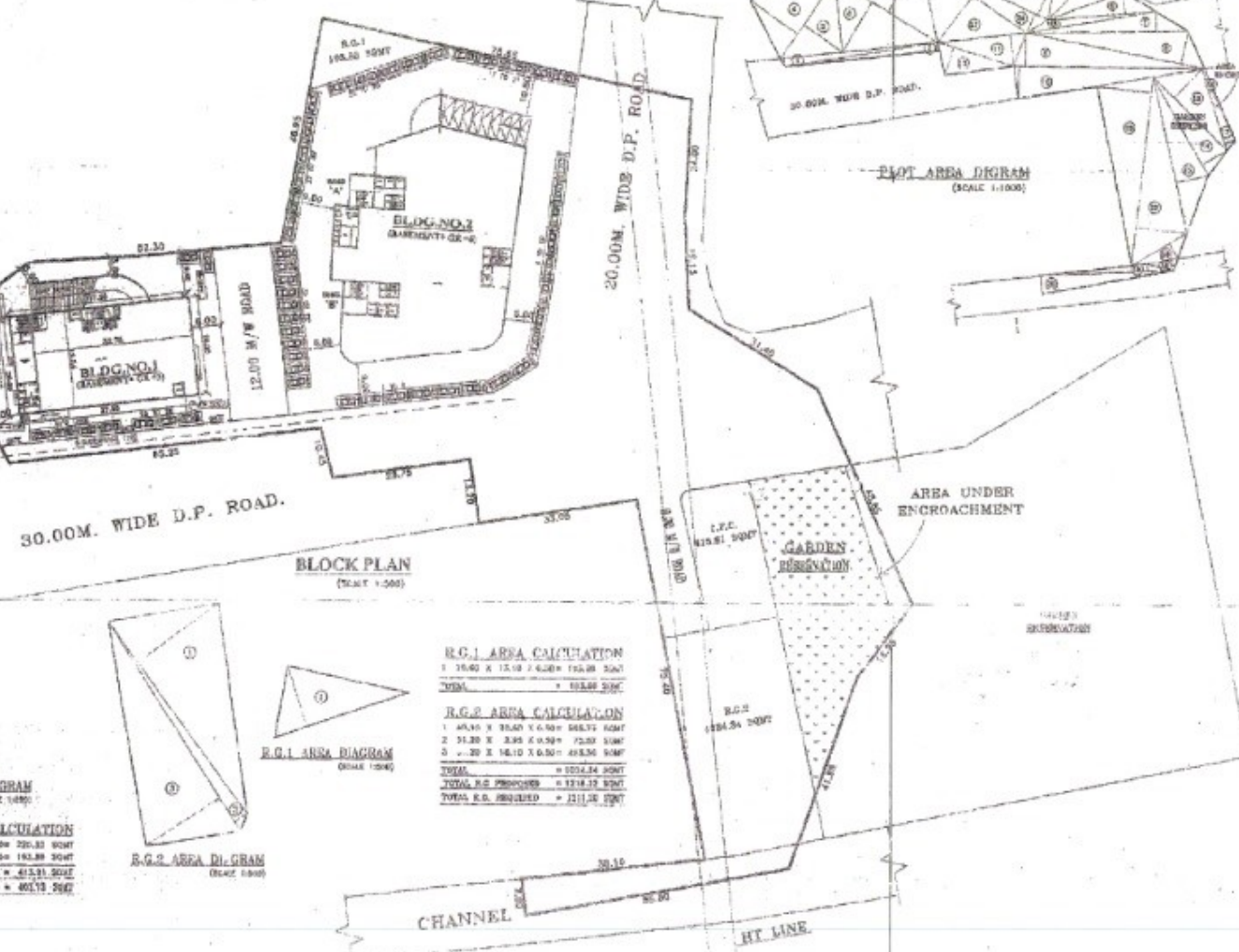

BLOCK PLAN
(SCALE 1:500)

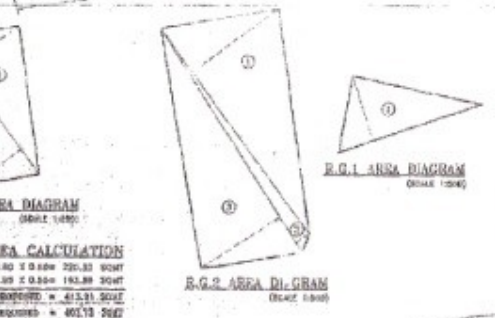

R.C.I. AREA CALCULATION

1	10.00 x 15.10 x 0.50	75.50 SQMT
2	10.00 x 15.10 x 0.50	75.50 SQMT
TOTAL		151.00 SQMT

R.C.P. AREA CALCULATION

1	45.10 x 25.60 x 0.50	582.73 SQMT
2	31.20 x 3.85 x 0.50	72.00 SQMT
3	20 x 14.10 x 0.50	141.30 SQMT
TOTAL		796.03 SQMT
TOTAL R.C. PROPOSED		947.03 SQMT
TOTAL R.C. REQUIRED		1211.30 SQMT

AREA CALCULATION

1	13.40 x 0.50 x 20.30	136.71 SQMT
2	11.80 x 0.50 x 182.80	1079.24 SQMT
TOTAL		1215.95 SQMT

R.C.P. AREA DIAGRAM
(SCALE 1:500)

PROFORMA I

NO.	DESCRIPTION	AREA (SQ.MT.)
1	AREA OF PLOT AS PER 77/18	12860.00
2	AREA UNDER 30.00 M/W D.P. ROAD	1072.08
3	AREA UNDER CHANNEL RESERVATION (PROPOSED)	812.74
4	AREA UNDER ENCROACHMENT	173.12
5	AREA UNDER CHANNEL RESERVATION	217.50
6	AREA UNDER RESIDENTIAL ZONE	3193.38
7	AREA UNDER RESIDENTIAL ZONE	279.60
8	AREA UNDER RESIDENTIAL ZONE	2331.93
TOTAL		11328.46

PROFORMA II

NO.	DESCRIPTION	AREA (SQ.MT.)
1	AREA UNDER 30.00 M/W D.P. ROAD	1072.08
2	AREA UNDER CHANNEL RESERVATION (PROPOSED)	812.74
3	AREA UNDER ENCROACHMENT	173.12
4	AREA UNDER CHANNEL RESERVATION	217.50
5	AREA UNDER RESIDENTIAL ZONE	3193.38
6	AREA UNDER RESIDENTIAL ZONE	279.60
7	AREA UNDER RESIDENTIAL ZONE	2331.93
TOTAL		11328.46

CERTIFICATE OF AREA

I hereby certify that the above area is correct as per the details given in the above statement and that the area is correct as per the details given in the above statement.

Signature of Surveyor/Engineer

STAMP OF APPROVAL OF PLANS

Approved as per the conditions mentioned in the Office Order No. VP/0136/2018 dated 10/01/2018.

Signature of Surveyor/Engineer

REVISIONS

NO.	REVISION	DATE
1	AS SHOWN	10/01/2018
2	AS SHOWN	10/01/2018

EN-CON

Architectural & Structural Works
Project Consultants

Signature of Applicant