

This is a copy of the original plan submitted to the Surveyor General, Bangalore, on 15/01/2014.

**APPROVABLE**  
Subject to conditions of Registered Terms & Conditions as Per Office Letter No. SPA/ENG/22/7/1 dated 15/01/2014.  
15 JAN 2014  
Executive Engineer  
Slum Rehabilitation Authority

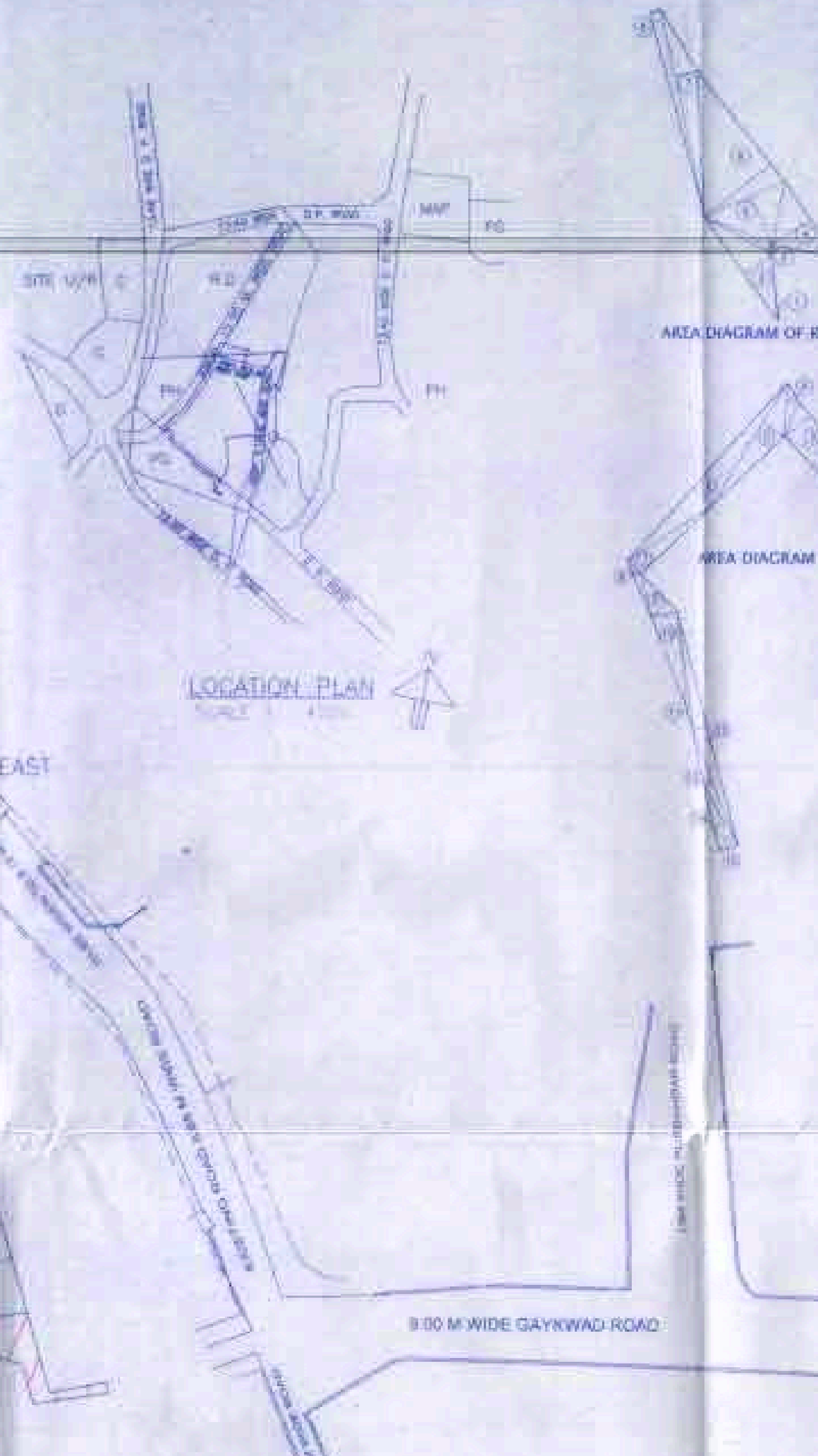

R.G. - 1

1	1/2 x 5100 x 5200 x 100	5400 SQ.MT
2	1/2 x 15500 x 4300 x 100	13385 SQ.MT
3	1/2 x 8400 x 1100 x 100	4620 SQ.MT
4	1/2 x 11200 x 2500 x 100	14000 SQ.MT
5	1/2 x 10200 x 6200 x 100	31620 SQ.MT
6	1/2 x 10200 x 10400 x 100	53040 SQ.MT
7	1/2 x 20100 x 2300 x 100	23115 SQ.MT
8	1/2 x 10200 x 10400 x 100	53040 SQ.MT
TOTAL R.G. - 1 AREA		249480 SQ.MT

R.G. - 2

1	1/2 x 5100 x 5200 x 100	5400 SQ.MT
2	1/2 x 15500 x 4300 x 100	13385 SQ.MT
3	1/2 x 8400 x 1100 x 100	4620 SQ.MT
4	1/2 x 11200 x 2500 x 100	14000 SQ.MT
5	1/2 x 10200 x 6200 x 100	31620 SQ.MT
6	1/2 x 10200 x 10400 x 100	53040 SQ.MT
7	1/2 x 20100 x 2300 x 100	23115 SQ.MT
8	1/2 x 10200 x 10400 x 100	53040 SQ.MT
TOTAL R.G. - 2 AREA		249480 SQ.MT

R.G. - 3

1	1/2 x 5100 x 5200 x 100	5400 SQ.MT
2	1/2 x 15500 x 4300 x 100	13385 SQ.MT
3	1/2 x 8400 x 1100 x 100	4620 SQ.MT
4	1/2 x 11200 x 2500 x 100	14000 SQ.MT
5	1/2 x 10200 x 6200 x 100	31620 SQ.MT
6	1/2 x 10200 x 10400 x 100	53040 SQ.MT
7	1/2 x 20100 x 2300 x 100	23115 SQ.MT
8	1/2 x 10200 x 10400 x 100	53040 SQ.MT
TOTAL R.G. - 3 AREA		249480 SQ.MT

REQUIRED SUB DIVISION AREA

1	1/2 x 5100 x 5200 x 100	5400 SQ.MT
2	1/2 x 15500 x 4300 x 100	13385 SQ.MT
3	1/2 x 8400 x 1100 x 100	4620 SQ.MT
4	1/2 x 11200 x 2500 x 100	14000 SQ.MT
5	1/2 x 10200 x 6200 x 100	31620 SQ.MT
6	1/2 x 10200 x 10400 x 100	53040 SQ.MT
7	1/2 x 20100 x 2300 x 100	23115 SQ.MT
8	1/2 x 10200 x 10400 x 100	53040 SQ.MT
TOTAL REQUIRED SUB DIVISION AREA		249480 SQ.MT

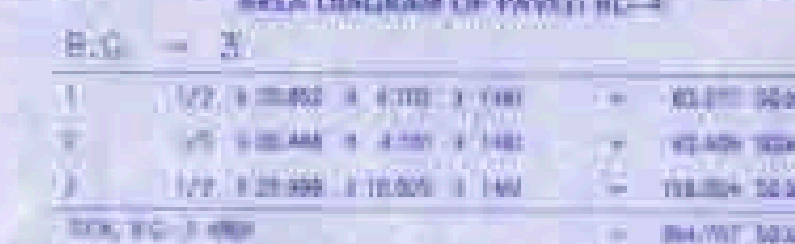
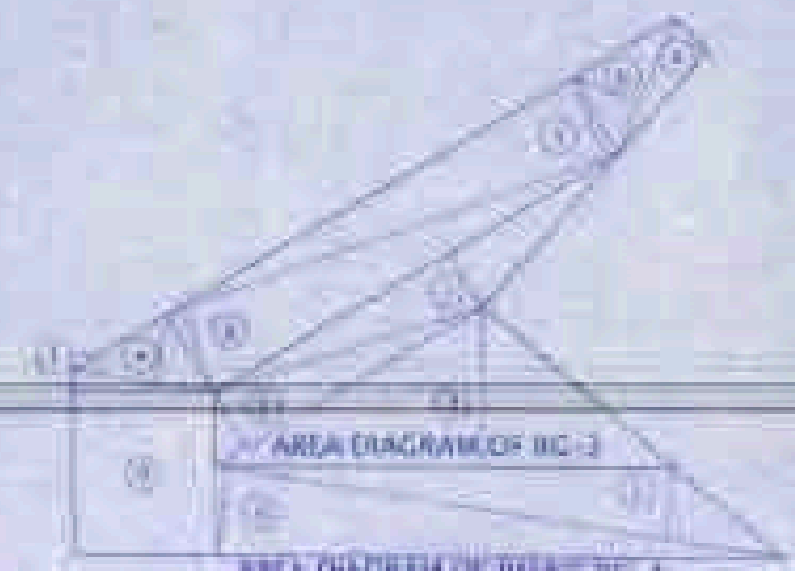

R.G. - 4

1	1/2 x 5100 x 5200 x 100	5400 SQ.MT
2	1/2 x 15500 x 4300 x 100	13385 SQ.MT
3	1/2 x 8400 x 1100 x 100	4620 SQ.MT
4	1/2 x 11200 x 2500 x 100	14000 SQ.MT
5	1/2 x 10200 x 6200 x 100	31620 SQ.MT
6	1/2 x 10200 x 10400 x 100	53040 SQ.MT
7	1/2 x 20100 x 2300 x 100	23115 SQ.MT
8	1/2 x 10200 x 10400 x 100	53040 SQ.MT
TOTAL R.G. - 4 AREA		249480 SQ.MT

REQUIRED SUB DIVISION AREA

1	1/2 x 5100 x 5200 x 100	5400 SQ.MT
2	1/2 x 15500 x 4300 x 100	13385 SQ.MT
3	1/2 x 8400 x 1100 x 100	4620 SQ.MT
4	1/2 x 11200 x 2500 x 100	14000 SQ.MT
5	1/2 x 10200 x 6200 x 100	31620 SQ.MT
6	1/2 x 10200 x 10400 x 100	53040 SQ.MT
7	1/2 x 20100 x 2300 x 100	23115 SQ.MT
8	1/2 x 10200 x 10400 x 100	53040 SQ.MT
TOTAL REQUIRED SUB DIVISION AREA		249480 SQ.MT

AREA CALCULATION FOR REHAB PLOT

1	1/2 x 5100 x 5200 x 100	5400 SQ.MT
2	1/2 x 15500 x 4300 x 100	13385 SQ.MT
3	1/2 x 8400 x 1100 x 100	4620 SQ.MT
4	1/2 x 11200 x 2500 x 100	14000 SQ.MT
5	1/2 x 10200 x 6200 x 100	31620 SQ.MT
6	1/2 x 10200 x 10400 x 100	53040 SQ.MT
7	1/2 x 20100 x 2300 x 100	23115 SQ.MT
8	1/2 x 10200 x 10400 x 100	53040 SQ.MT
9	1/2 x 5100 x 5200 x 100	5400 SQ.MT
10	1/2 x 15500 x 4300 x 100	13385 SQ.MT
11	1/2 x 8400 x 1100 x 100	4620 SQ.MT
12	1/2 x 11200 x 2500 x 100	14000 SQ.MT
13	1/2 x 10200 x 6200 x 100	31620 SQ.MT
14	1/2 x 10200 x 10400 x 100	53040 SQ.MT
15	1/2 x 20100 x 2300 x 100	23115 SQ.MT
16	1/2 x 10200 x 10400 x 100	53040 SQ.MT
17	1/2 x 5100 x 5200 x 100	5400 SQ.MT
18	1/2 x 15500 x 4300 x 100	13385 SQ.MT
19	1/2 x 8400 x 1100 x 100	4620 SQ.MT
20	1/2 x 11200 x 2500 x 100	14000 SQ.MT
21	1/2 x 10200 x 6200 x 100	31620 SQ.MT
22	1/2 x 10200 x 10400 x 100	53040 SQ.MT
23	1/2 x 20100 x 2300 x 100	23115 SQ.MT
24	1/2 x 10200 x 10400 x 100	53040 SQ.MT
25	1/2 x 5100 x 5200 x 100	5400 SQ.MT
26	1/2 x 15500 x 4300 x 100	13385 SQ.MT
27	1/2 x 8400 x 1100 x 100	4620 SQ.MT
28	1/2 x 11200 x 2500 x 100	14000 SQ.MT
29	1/2 x 10200 x 6200 x 100	31620 SQ.MT
30	1/2 x 10200 x 10400 x 100	53040 SQ.MT
31	1/2 x 20100 x 2300 x 100	23115 SQ.MT
32	1/2 x 10200 x 10400 x 100	53040 SQ.MT
33	1/2 x 5100 x 5200 x 100	5400 SQ.MT
34	1/2 x 15500 x 4300 x 100	13385 SQ.MT
35	1/2 x 8400 x 1100 x 100	4620 SQ.MT
36	1/2 x 11200 x 2500 x 100	14000 SQ.MT
37	1/2 x 10200 x 6200 x 100	31620 SQ.MT
38	1/2 x 10200 x 10400 x 100	53040 SQ.MT
39	1/2 x 20100 x 2300 x 100	23115 SQ.MT
40	1/2 x 10200 x 10400 x 100	53040 SQ.MT
TOTAL REHAB PLOT AREA		249480 SQ.MT

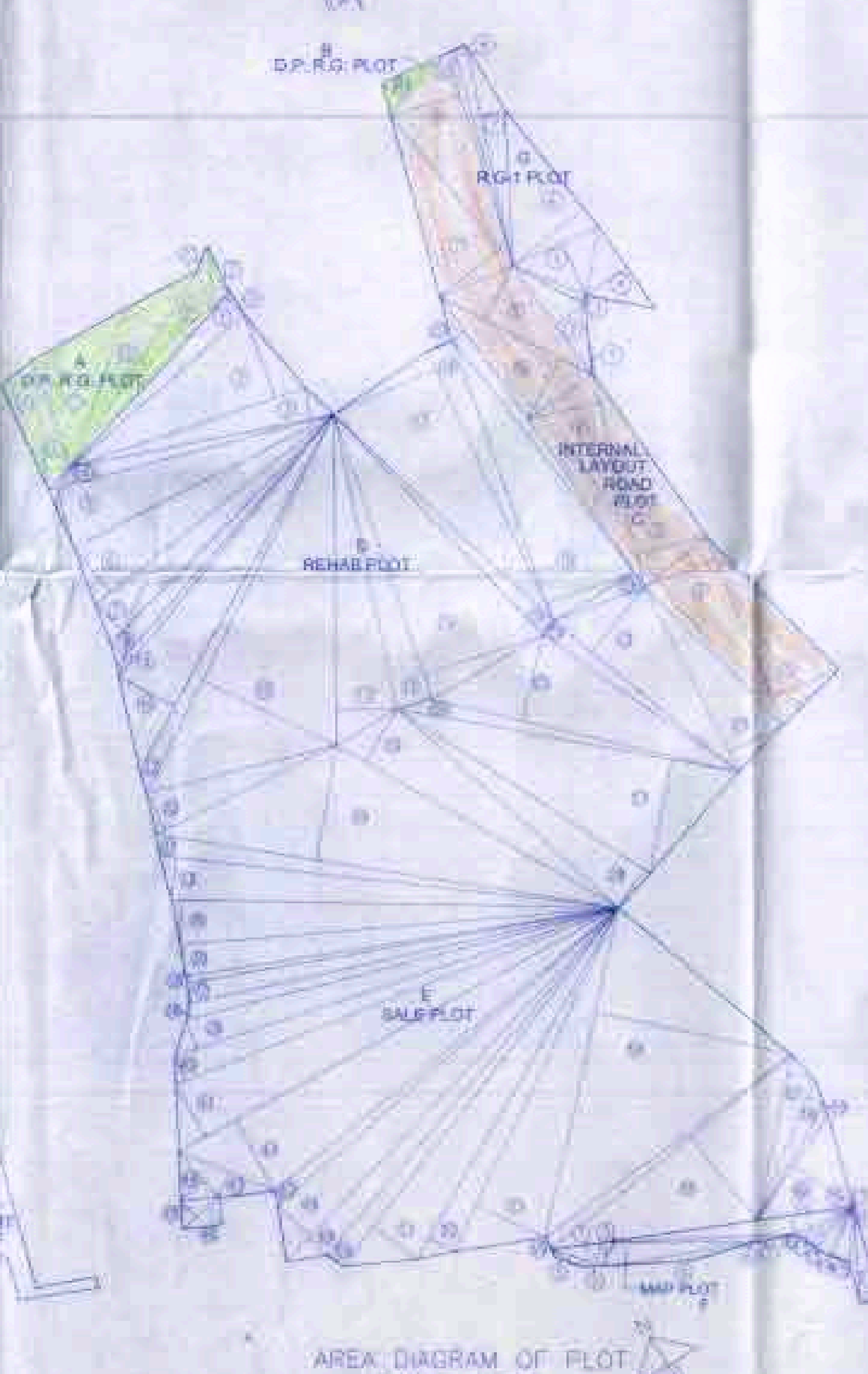
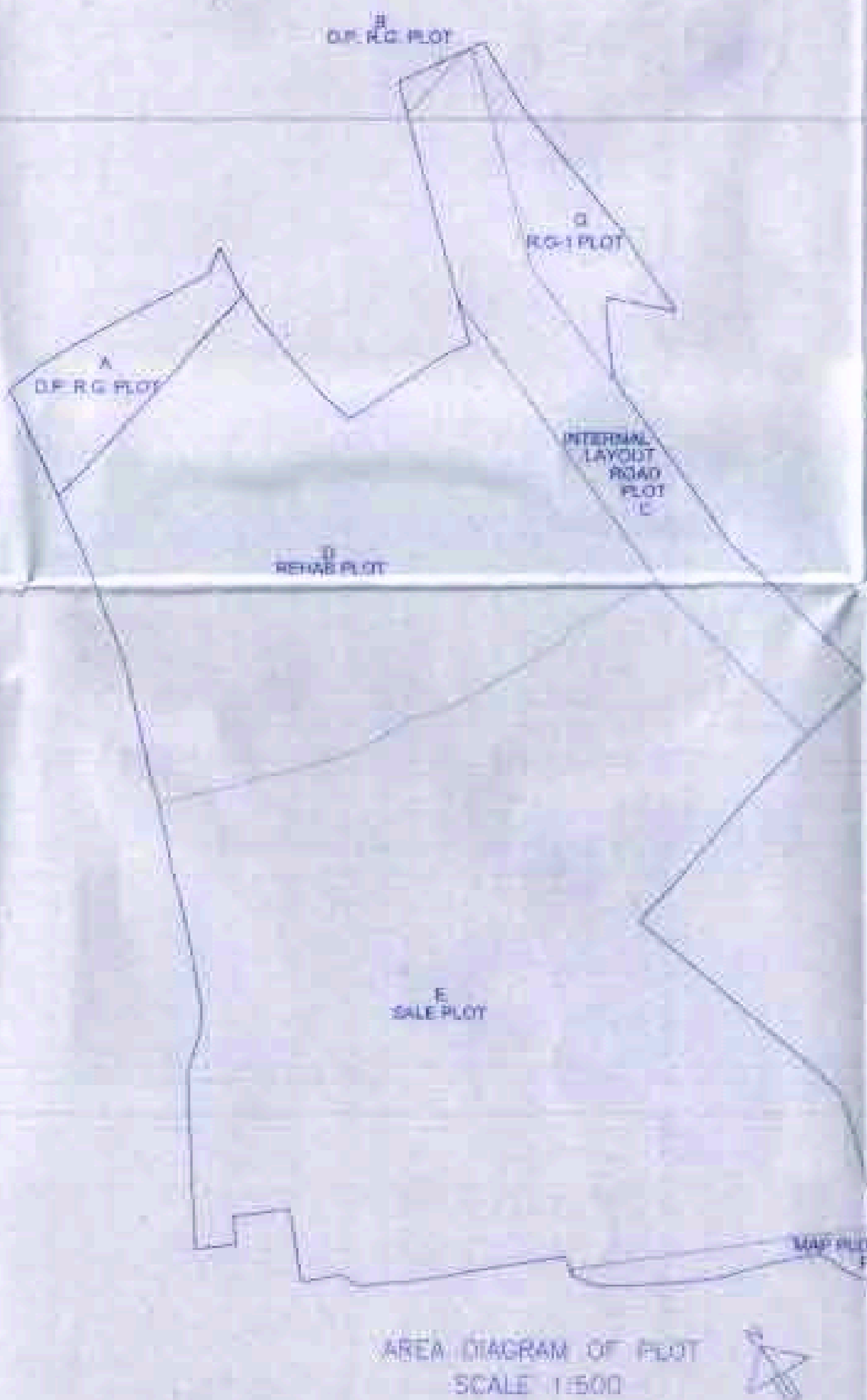

TOTAL PLOT AREA

1	1/2 x 5100 x 5200 x 100	5400 SQ.MT
2	1/2 x 15500 x 4300 x 100	13385 SQ.MT
3	1/2 x 8400 x 1100 x 100	4620 SQ.MT
4	1/2 x 11200 x 2500 x 100	14000 SQ.MT
5	1/2 x 10200 x 6200 x 100	31620 SQ.MT
6	1/2 x 10200 x 10400 x 100	53040 SQ.MT
7	1/2 x 20100 x 2300 x 100	23115 SQ.MT
8	1/2 x 10200 x 10400 x 100	53040 SQ.MT
TOTAL PLOT AREA		249480 SQ.MT

**A. AREA STATEMENT**

1	AREA OF PLOT NO. 01	144.00
2	AREA OF PLOT NO. 02	144.00
3	AREA OF PLOT NO. 03	144.00
4	AREA OF PLOT NO. 04	144.00
5	AREA OF PLOT NO. 05	144.00
6	AREA OF PLOT NO. 06	144.00
7	AREA OF PLOT NO. 07	144.00
8	AREA OF PLOT NO. 08	144.00
9	AREA OF PLOT NO. 09	144.00
10	AREA OF PLOT NO. 10	144.00
11	AREA OF PLOT NO. 11	144.00
12	AREA OF PLOT NO. 12	144.00
13	AREA OF PLOT NO. 13	144.00
14	AREA OF PLOT NO. 14	144.00
15	AREA OF PLOT NO. 15	144.00
16	AREA OF PLOT NO. 16	144.00
17	AREA OF PLOT NO. 17	144.00
18	AREA OF PLOT NO. 18	144.00
19	AREA OF PLOT NO. 19	144.00
20	AREA OF PLOT NO. 20	144.00
21	AREA OF PLOT NO. 21	144.00
22	AREA OF PLOT NO. 22	144.00
23	AREA OF PLOT NO. 23	144.00
24	AREA OF PLOT NO. 24	144.00
25	AREA OF PLOT NO. 25	144.00
26	AREA OF PLOT NO. 26	144.00
27	AREA OF PLOT NO. 27	144.00
28	AREA OF PLOT NO. 28	144.00
29	AREA OF PLOT NO. 29	144.00
30	AREA OF PLOT NO. 30	144.00
31	AREA OF PLOT NO. 31	144.00
32	AREA OF PLOT NO. 32	144.00
33	AREA OF PLOT NO. 33	144.00
34	AREA OF PLOT NO. 34	144.00
35	AREA OF PLOT NO. 35	144.00
36	AREA OF PLOT NO. 36	144.00
37	AREA OF PLOT NO. 37	144.00
38	AREA OF PLOT NO. 38	144.00
39	AREA OF PLOT NO. 39	144.00
40	AREA OF PLOT NO. 40	144.00
41	AREA OF PLOT NO. 41	144.00
42	AREA OF PLOT NO. 42	144.00
43	AREA OF PLOT NO. 43	144.00
44	AREA OF PLOT NO. 44	144.00
45	AREA OF PLOT NO. 45	144.00
46	AREA OF PLOT NO. 46	144.00
47	AREA OF PLOT NO. 47	144.00
48	AREA OF PLOT NO. 48	144.00
49	AREA OF PLOT NO. 49	144.00
50	AREA OF PLOT NO. 50	144.00
51	AREA OF PLOT NO. 51	144.00
52	AREA OF PLOT NO. 52	144.00
53	AREA OF PLOT NO. 53	144.00
54	AREA OF PLOT NO. 54	144.00
55	AREA OF PLOT NO. 55	144.00
56	AREA OF PLOT NO. 56	144.00
57	AREA OF PLOT NO. 57	144.00
58	AREA OF PLOT NO. 58	144.00
59	AREA OF PLOT NO. 59	144.00
60	AREA OF PLOT NO. 60	144.00
61	AREA OF PLOT NO. 61	144.00
62	AREA OF PLOT NO. 62	144.00
63	AREA OF PLOT NO. 63	144.00
64	AREA OF PLOT NO. 64	144.00
65	AREA OF PLOT NO. 65	144.00
66	AREA OF PLOT NO. 66	144.00
67	AREA OF PLOT NO. 67	144.00
68	AREA OF PLOT NO. 68	144.00
69	AREA OF PLOT NO. 69	144.00
70	AREA OF PLOT NO. 70	144.00
71	AREA OF PLOT NO. 71	144.00
72	AREA OF PLOT NO. 72	144.00
73	AREA OF PLOT NO. 73	144.00
74	AREA OF PLOT NO. 74	144.00
75	AREA OF PLOT NO. 75	144.00
76	AREA OF PLOT NO. 76	144.00
77	AREA OF PLOT NO. 77	144.00
78	AREA OF PLOT NO. 78	144.00
79	AREA OF PLOT NO. 79	144.00
80	AREA OF PLOT NO. 80	144.00
81	AREA OF PLOT NO. 81	144.00
82	AREA OF PLOT NO. 82	144.00
83	AREA OF PLOT NO. 83	144.00
84	AREA OF PLOT NO. 84	144.00
85	AREA OF PLOT NO. 85	144.00
86	AREA OF PLOT NO. 86	144.00
87	AREA OF PLOT NO. 87	144.00
88	AREA OF PLOT NO. 88	144.00
89	AREA OF PLOT NO. 89	144.00
90	AREA OF PLOT NO. 90	144.00
91	AREA OF PLOT NO. 91	144.00
92	AREA OF PLOT NO. 92	144.00
93	AREA OF PLOT NO. 93	144.00
94	AREA OF PLOT NO. 94	144.00
95	AREA OF PLOT NO. 95	144.00
96	AREA OF PLOT NO. 96	144.00
97	AREA OF PLOT NO. 97	144.00
98	AREA OF PLOT NO. 98	144.00
99	AREA OF PLOT NO. 99	144.00
100	AREA OF PLOT NO. 100	144.00
TOTAL AREA		14400.00

**B. BALCONY AREA STATEMENT**

1	AREA OF BALCONY NO. 01	14.40
2	AREA OF BALCONY NO. 02	14.40
3	AREA OF BALCONY NO. 03	14.40
4	AREA OF BALCONY NO. 04	14.40
5	AREA OF BALCONY NO. 05	14.40
6	AREA OF BALCONY NO. 06	14.40
7	AREA OF BALCONY NO. 07	14.40
8	AREA OF BALCONY NO. 08	14.40
9	AREA OF BALCONY NO. 09	14.40
10	AREA OF BALCONY NO. 10	14.40
11	AREA OF BALCONY NO. 11	14.40
12	AREA OF BALCONY NO. 12	14.40
13	AREA OF BALCONY NO. 13	14.40
14	AREA OF BALCONY NO. 14	14.40
15	AREA OF BALCONY NO. 15	14.40
16	AREA OF BALCONY NO. 16	14.40
17	AREA OF BALCONY NO. 17	14.40
18	AREA OF BALCONY NO. 18	14.40
19	AREA OF BALCONY NO. 19	14.40
20	AREA OF BALCONY NO. 20	14.40
21	AREA OF BALCONY NO. 21	14.40
22	AREA OF BALCONY NO. 22	14.40
23	AREA OF BALCONY NO. 23	14.40
24	AREA OF BALCONY NO. 24	14.40
25	AREA OF BALCONY NO. 25	14.40
26	AREA OF BALCONY NO. 26	14.40
27	AREA OF BALCONY NO. 27	14.40
28	AREA OF BALCONY NO. 28	14.40
29	AREA OF BALCONY NO. 29	14.40
30	AREA OF BALCONY NO. 30	14.40
31	AREA OF BALCONY NO. 31	14.40
32	AREA OF BALCONY NO. 32	14.40
33	AREA OF BALCONY NO. 33	14.40
34	AREA OF BALCONY NO. 34	14.40
35	AREA OF BALCONY NO. 35	14.40
36	AREA OF BALCONY NO. 36	14.40
37	AREA OF BALCONY NO. 37	14.40
38	AREA OF BALCONY NO. 38	14.40
39	AREA OF BALCONY NO. 39	14.40
40	AREA OF BALCONY NO. 40	14.40
41	AREA OF BALCONY NO. 41	14.40
42	AREA OF BALCONY NO. 42	14.40
43	AREA OF BALCONY NO. 43	14.40
44	AREA OF BALCONY NO. 44	14.40
45	AREA OF BALCONY NO. 45	14.40
46	AREA OF BALCONY NO. 46	14.40
47	AREA OF BALCONY NO. 47	14.40
48	AREA OF BALCONY NO. 48	14.40
49	AREA OF BALCONY NO. 49	14.40
50	AREA OF BALCONY NO. 50	14.40
51	AREA OF BALCONY NO. 51	14.40
52	AREA OF BALCONY NO. 52	14.40
53	AREA OF BALCONY NO. 53	14.40
54	AREA OF BALCONY NO. 54	14.40
55	AREA OF BALCONY NO. 55	14.40
56	AREA OF BALCONY NO. 56	14.40
57	AREA OF BALCONY NO. 57	14.40
58	AREA OF BALCONY NO. 58	14.40
59	AREA OF BALCONY NO. 59	14.40
60	AREA OF BALCONY NO. 60	14.40
61	AREA OF BALCONY NO. 61	14.40
62	AREA OF BALCONY NO. 62	14.40
63	AREA OF BALCONY NO. 63	14.40
64	AREA OF BALCONY NO. 64	14.40
65	AREA OF BALCONY NO. 65	14.40
66	AREA OF BALCONY NO. 66	

# Proposed Layout



**BLOCK PLAN**  
SCALE 1 : 500

**LOCATION PLAN**  
SCALE 1 : 4000

## PROFOMA "A"

A AREA STATEMENT		SQ.MT.
1	AREA OF PLOT AS PER DEMARCATION	7860.00
2	DEDUCTIONS FOR	
a	ANY RESERVATION MAP	133.19
b	ANY RESERVATION R.G	276.92
c	PROPOSED WIDENING OF EXISTING NALLA	108.86
	TOTAL (a+b+c)	518.97
3	NET GROSS AREA OF PLOT (1-2)	7341.03
4	DEDUCTIONS FOR	
a	RECREATION GROUND AS PER RULE NO. 13.3.1	
b	INTERNAL ROADS	
c	TOTAL (a+b)	
5	NET AREA OF PLOT (3-4c)	7341.03
6	ADDITION FOR F.A.R.	
	ADDITION FOR 2(a) 100%	276.92
	ADDITION FOR 2(b) 100%	108.86
	ADDITION FOR 2(c) 100%	
7	TOTAL AREA (5+6)	7726.81
8	F.A.R. PERMISSIBLE	4.00
9	PERMISSIBLE FLOOR AREA (7 x 8)	30907.24
10	EXISTING FLOOR AREA	
11	PROPOSED BUA AREA (REHAB BLDG-1)	4979.722
12	PROPOSED BUA AREA (REHAB BLDG-2)	10183.602
13	PROPOSED BUA AREA (SALE BLDG)	15114.690
14	TOTAL BUILT-UP AREA PROPOSED (11 + 12 + 13)	30278.014
15	PERMISSIBLE FUNGIBLE AREA (REHAB BLDG-1)	1699.128
16	PERMISSIBLE FUNGIBLE AREA (REHAB BLDG-1)	885.838
17	PERMISSIBLE FUNGIBLE AREA (REHAB BLDG-2)	2973.169
18	PERMISSIBLE FUNGIBLE AREA (REHAB BLDG-2)	1349.102
19	PERMISSIBLE FUNGIBLE AREA (SALE BLDG)	
20	PERMISSIBLE FUNGIBLE AREA (SALE BLDG)	
21	F.A.R. CONSUMED (14/7)	3.919
B R.G AREA STATEMENT		
	REQUIRED R.G.- 20 % OF NET PLOT AREA (7341.03 SQ.MT)	1468.206
	PROPOSED R.G AREA	1468.679
C BALCONY AREA STATEMENT		
a	(i) PERMISSIBLE BALCONY AREA PER FLOOR	
	(ii) PERM. BALCONY LENGTH PER FL	
b	(i) PROP BALCONY AREA PER FLOOR	
	(ii) PROP BALCONY LENGTH PER FLOOR	
c	EXCESS BALCONY AREA (TOTAL)	
D TENEMENT STATEMENT		
a	NET AREA OF PLOT-ITEM A (7) ABOVE	
b	LESS DEDUCTION OF NON RESIDENTIAL AREA (SHOPS ETC.)	
c	AREA OF TENEMENTS (a - b)	
d	TENEMENTS PERMISSIBLE	
e	TENEMENTS PROPOSED	
f	TENEMENTS EXISTING	
g	TOTAL TENEMENTS (e + f)	
E PARKING STATEMENT		
a	PARKING REQUIRED BY RULE	
	CAR	
	SCOOTER/MOTOR CYCLE	
	CYCLE	
	OUTSIDERS	
b	GARAGES PERMISSIBLE	
c	GARAGES PROPOSED	
	CAR	
	SCOOTER/MOTOR CYCLE	
	CYCLE	
	OUTSIDERS	
d	TOTAL PARKING PROVIDED	
F LOADING / UNLOADING STATEMENT		
	LOADING/UNLOADING REQUIRED	
	TOTAL LOADING/UNLOADING PROVIDED	
G LEGEND		
1)	PLOT LINES - THK. BLACK /RED	8) R.G. - GREEN WASH
2)	EXISTING WORK - BLUE	9) EX. STREET LINE-BROWN
3)	WORK PROP. TO BE DEMOLISHED - YELLOW	10) FUTURE STREET LINE-BROWN DOTTED
4)	PROPOSED WORK - RED/PINK	11) B - DENOTES BALCONY
5)	DRAINAGE & SEWERAGE WORK - RED/YEL DOTTED	
6)	WATER SUPPLY WORK - BLACK DOTTED THIN	
7)	DEVIATIONS - RED HATCHED	

## PROFOMA " B "

CONTENTS OF SHEETS  
BLOCK PLAN & LOCATION PLAN

STAMP OF DATE OF RECEIPT OF PLANS      STAMP OF APPROVAL PLANS

### CERTIFICATE OF AREA

CERTIFIED THAT THE PLOT UNDER REFERENCE WAS SURVEYED BY ME ON 12/08/2013 AND THE DIMENSIONS OF THE SIDES ETC. OF THE PLOT STATED ON THE PLANS ARE AS MEASURED ON SITE AND THE AREA SO WORKED OUT TALLIES WITH THE AREA STATED IN THE DOCUMENTS OF OWNERSHIP/AND T.P. SCHEME RECORDS/ LAND RECORDS DEPT/ CITY SURVEY RECORDS

SIGNATURE OF LIC.ARCHITECT

DESCRIPTION OF PROPSAL & PROPERTY

PROPOSED LAYOUT ON SLUM REHABILITATION SCHEME ON PROPERTY BEARING C. T. S. NO. 755(P.T.) VILLAGE MULUND, AT R.P. ROAD, MULUND (W), MUMBAI.

NAME OF DEVELOPER

**M/S. RIDDI SIDDHI CORPORATION**

JOB.NO      DATE      SIGNATURE OF DEVELOPER

*[Signature]*

DRW. NO      SCALE

**01**

SCALE

1:500

NORTH      DRN. BY

CHEK. BY

**RAJENDRA U. PAGNIS**

**PAGNIS AND PAGNIS**

ARCHITECTS DESIGNERS & PLANNING CONSULTANTS  
4, ANAND, OPP VITHAL MANDIR, D.L. VAIDYA ROAD,  
DADAR(WEST), MUMBAI-4000 28  
OFF.TEL-24312025,24308081.