

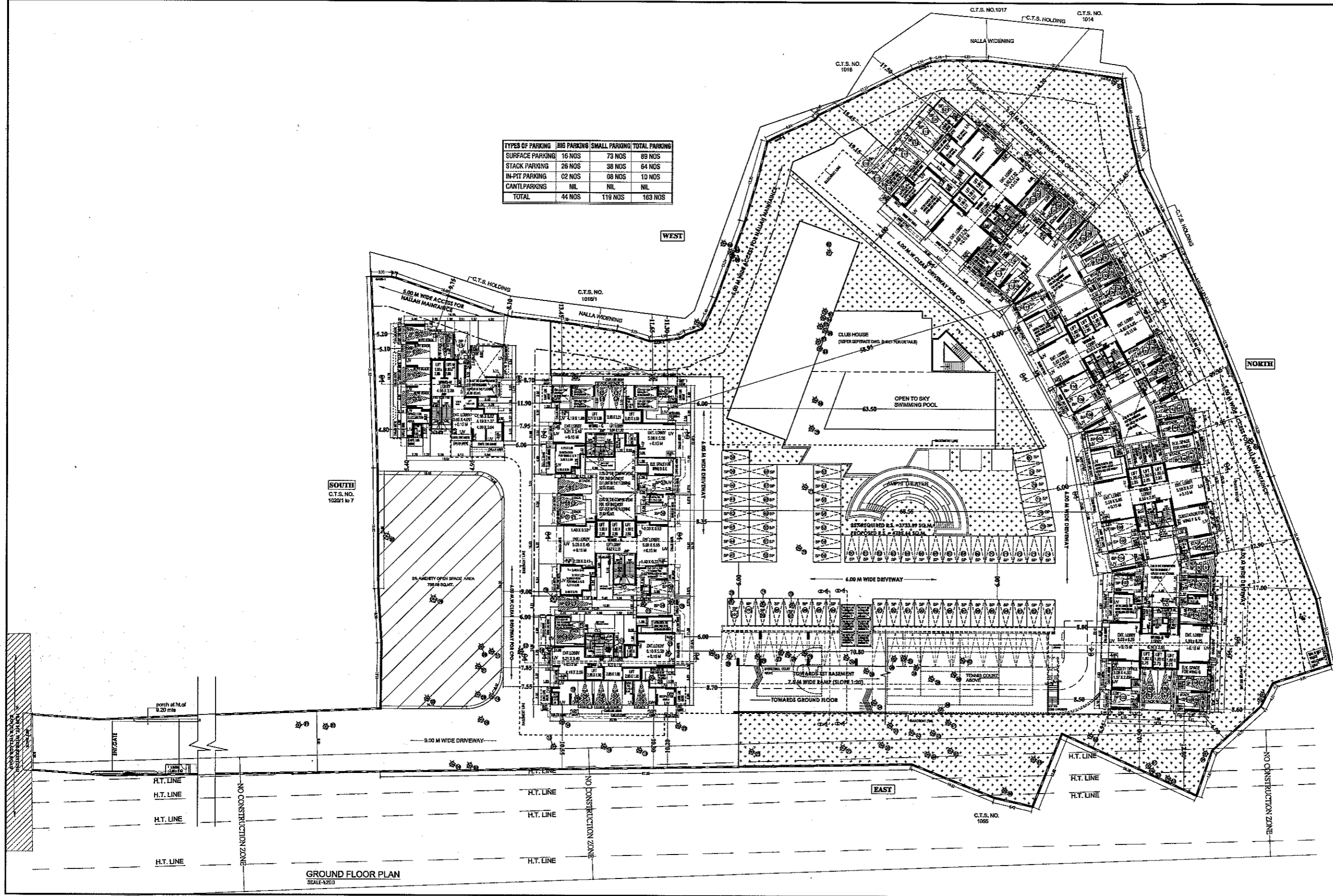

TYPES OF PARKING	BIG PARKING	SMALL PARKING	TOTAL PARKING
SURFACE PARKING	16 NOS	73 NOS	89 NOS
STACK PARKING	26 NOS	38 NOS	64 NOS
IN-PT PARKING	02 NOS	08 NOS	10 NOS
CANTL PARKING	NIL	NIL	NIL
TOTAL	44 NOS	119 NOS	163 NOS



**PROFORMA-B**

CONTENTS OF SHEET:  
GROUND FLOOR PLAN

DESCRIPTION OF PROPOSAL AND PROPERTY  
PROPOSED RESIDENTIAL BUILDING ON PLOT BEARING CTS NO. 1019 OF VILLAGE KANUR, KANUR (EAST), MANGALURU.

NAME, ADD. & SIGNATURE OF OWNER/DEVELOPER  
SMT M. JAYI, DIRECTOR  
M/S ARKADE DEVELOPER PVT. LDM,  
C. A. TO CHITRE  
ARKADE DEVELOPER BHOOMI ARKADE SOCIETY TO  
CHILDREN'S ACADEMY A.S. BANG, ASHOK NAGAR  
KANDIVALI (2) MIDURAI 600101

NAME, ADD. & SIGNATURE OF LICENSED ARCHITECT  
*Manish Shah*  
MANISH KUMAR M SHAH  
MANISH SHAH  
REGISTERED ARCHITECT

SCALE: 1:100

DATE: 06/06/17

NO. OF SHEETS: 12  
NO. OF PAGES: 12

MONTH	DRAWN	CHECKED	DATE

NO CONSTRUCTION ZONE

GROUND FLOOR PLAN  
SCALE: 1:200

TYPES OF PARKING	BIG PARKING	SMALL PARKING	TOTAL PARKING
SURFACE PARKING	53 NOS	86 NOS	139 NOS
STACK PARKING	NIL	NIL	NIL
PIT PARKING	NIL	NIL	NIL
CANTILEVER PARKING	NIL	NIL	NIL
TOTAL	53 NOS	86 NOS	139 NOS

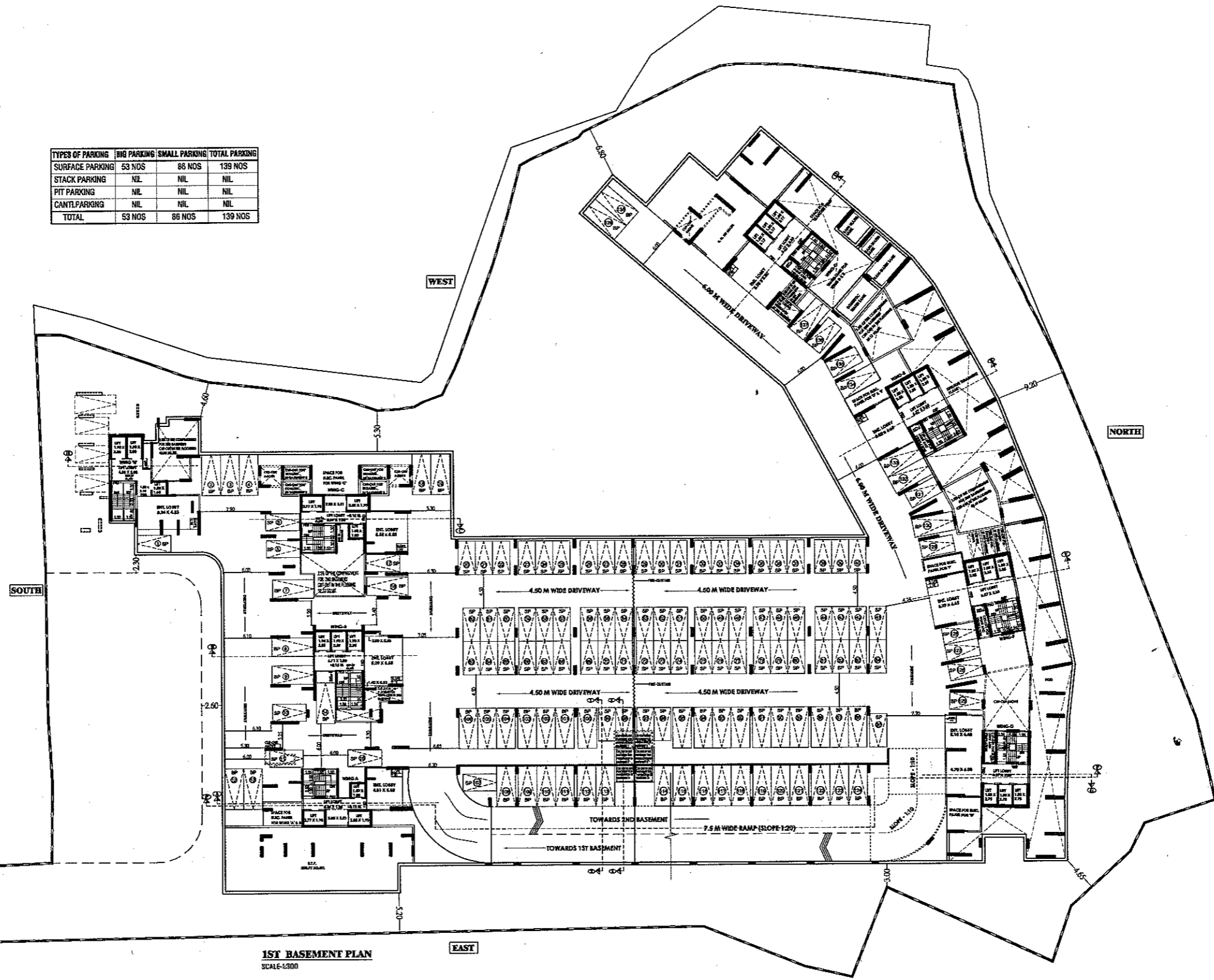

**1ST BASEMENT PLAN**  
 SCALE-1/500

PROFORMA-B	
CONTENTS OF SHEET:	
1ST BASEMENT FLOOR PLAN	
DESCRIPTION OF PROPOSAL AND PROPERTY	
PROPOSED RESIDENTIAL BUILDING ON PLOT BEARING GTS NO.- 1019 OF VILLAGE NAKAR, KANUPUR (EAST), MUMBAI.	
NAME, ADD. & SIGNATURE OF OWNER/DEVELOPER	
ANIL M. JAIN, DIRECTOR M/S ARKADE DEVELOPER PVT. LTM. ARKADE HOUSE, OPP. BHOOMI ARKADE NEXT TO CHILDREN'S ACADEMY A.S. MARG, ASHOK NAGAR KANDIVALI (E) MUMBAI 400103	
NAME, ADD. & SIGNATURE OF LICENSED ARCHITECT	
Manish Shah ARCHITECT & PROJECT CONSULTANT MANISH KUMAR M SHAH ARCHITECT & PROJECT CONSULTANT 40/102/1, Durgam Chawl, 4th Floor, Durgam Chawl, Mumbai - 400 018 Phone: 98220 20000, 98220 20001 Email: manishshah@rediffmail.com	
NORTH	DISBY
	N/23527
	CHELT
	3/10/17
SCALE	DATE
1/500	04/06/17
	EXE. ENDD

