

CONTENTS OF SHEET
BLOCK & LOCATION PLAN & AREA DIAGRAM & AREA CALC.
STAMP OF DATE OF RECEIPT OF PLAN

This certifies Approval to the previous Plans CHEUNG LOK TAI K1502 dated 29/05/2014

26 JUL 2016
SEARCHED, INDEXED, SERIALIZED & FILED
2016 JUL 26 AM 11:13
HONG KONG
REGISTRY OF DEEDS

APPROVED BY: [Signature]
CHEUNG LOK TAI
REGISTERED ARCHITECT
NO. 147

R.G. AREA CALCULATION	
1. PLOT AREA	76466.72
2. DEDUCTION FOR ROAD SETBACK	6865.70
3. PROPOSED ROAD	703.93
4. AMENITY SPACE AS PER DCR 56/57	5702.16
5. 25% AMENITY SPACE (NOT IN POSSESSION)	5488.36
6. OTHER (NOT IN POSSESSION)	121.91
7. BALANCE AREA OF PLOT (1-2)	57683.66
8. AREA OF DISPUTED LAND	1422.12
9. NET PLOT AREA (3-4)	56161.54
10. DEDUCTION FOR R.G. SPACE AS PER DCR 35(1) (4) AS PER D.P. RELEASE LETTER CHE/2442/DPM/SH & K DATED 30/11/2010 (10% OF TOTAL AREA OF PLOT A.E.F.G.H. I.E. 10% OF 56161.54)	5616.15
11. NET AREA OF PLOTS (5-6)	50545.39
12. ADDITION FOR FSI	703.93
13. 2(a) 100% FOR D.P. ROAD	51249.32
14. TOTAL AREA (7+8)	1.00
15. FSI PERMISSIBLE (1.00)	18600.00
16. FLOOR SPACE INDEX CREDIT AVAILABLE BY DEVELOPMENT RIGHTS (RESTRICTED TO % OF THE BALANCE AREA (3 ABOVE) (Ref D.S.C. No. 00694/RD & SBA/1000/Cont.) (Ref D.S.C. No. 835/AMHMH/D.R.C. No. 840/WH&MH/D.R.C. 877/WH&MH))	16801.57
17. ADDITIONS FOR FLOOR SPACE INDEX (9+1) 33% AS PER DCR 32 (PERMISSIBLE = 56161.54 X 33% = 18533.31)	40360.00
18. 9(b) 100% AS PER DCR 33(2)	127190.89
19. PERMISSIBLE FLOOR AREA (9 X 10) PLUS 12 ABOVE	127190.89
20. EXISTING BUILT UP AREA	127690.17
21. TOTAL PERMISSIBLE FLOOR AREA (19+20)	14608.96
22. FLOOR SPACE INDEX COMPONENT PROPOSED VIDE DCR PAID AREA = 14608.96 SQ.MT. 35(4) FOR PURELY RESIDENTIAL (Ref. Receipt / SAP NO: 100163451/100163698/1002229456)	137299.15
23. TOTAL PERMISSIBLE GROSS BUILT UP AREA (18+21)	

PERFORMA-A	
A	AREA STATEMENT
1	PLOT AREA
2	DEDUCTION FOR ROAD SETBACK
3	PROPOSED ROAD
4	AMENITY SPACE AS PER DCR 56/57
5	25% AMENITY SPACE (NOT IN POSSESSION)
6	OTHER (NOT IN POSSESSION)
7	BALANCE AREA OF PLOT (1-2)
8	AREA OF DISPUTED LAND
9	NET PLOT AREA (3-4)
10	DEDUCTION FOR R.G. SPACE AS PER DCR 35(1) (4) AS PER D.P. RELEASE LETTER CHE/2442/DPM/SH & K DATED 30/11/2010 (10% OF TOTAL AREA OF PLOT A.E.F.G.H. I.E. 10% OF 56161.54)
11	NET AREA OF PLOTS (5-6)
12	ADDITION FOR FSI
13	2(a) 100% FOR D.P. ROAD
14	TOTAL AREA (7+8)
15	FSI PERMISSIBLE (1.00)
16	FLOOR SPACE INDEX CREDIT AVAILABLE BY DEVELOPMENT RIGHTS (RESTRICTED TO % OF THE BALANCE AREA (3 ABOVE) (Ref D.S.C. No. 00694/RD & SBA/1000/Cont.) (Ref D.S.C. No. 835/AMHMH/D.R.C. No. 840/WH&MH/D.R.C. 877/WH&MH))
17	ADDITIONS FOR FLOOR SPACE INDEX (9+1) 33% AS PER DCR 32 (PERMISSIBLE = 56161.54 X 33% = 18533.31)
18	9(b) 100% AS PER DCR 33(2)
19	PERMISSIBLE FLOOR AREA (9 X 10) PLUS 12 ABOVE
20	EXISTING BUILT UP AREA
21	TOTAL PERMISSIBLE FLOOR AREA (19+20)
22	FLOOR SPACE INDEX COMPONENT PROPOSED VIDE DCR PAID AREA = 14608.96 SQ.MT. 35(4) FOR PURELY RESIDENTIAL (Ref. Receipt / SAP NO: 100163451/100163698/1002229456)
23	TOTAL PERMISSIBLE GROSS BUILT UP AREA (18+21)

PLOT AREA SUMMARY	
PLOT - A	56161.54 SQ.MT.
PLOT - B	4759.62 SQ.MT.
PLOT - C	942.54 SQ.MT.
PLOT - D	703.93 SQ.MT.
PLOT - E	703.93 SQ.MT.
PLOT - F	94.27 SQ.MT.
PLOT - G	12.98 SQ.MT.
PLOT - H	1422.12 SQ.MT.
PLOT - I	685.70 SQ.MT.
ROAD AREA	685.70 SQ.MT.
NET FOOT AREA	76466.72 SQ.MT.

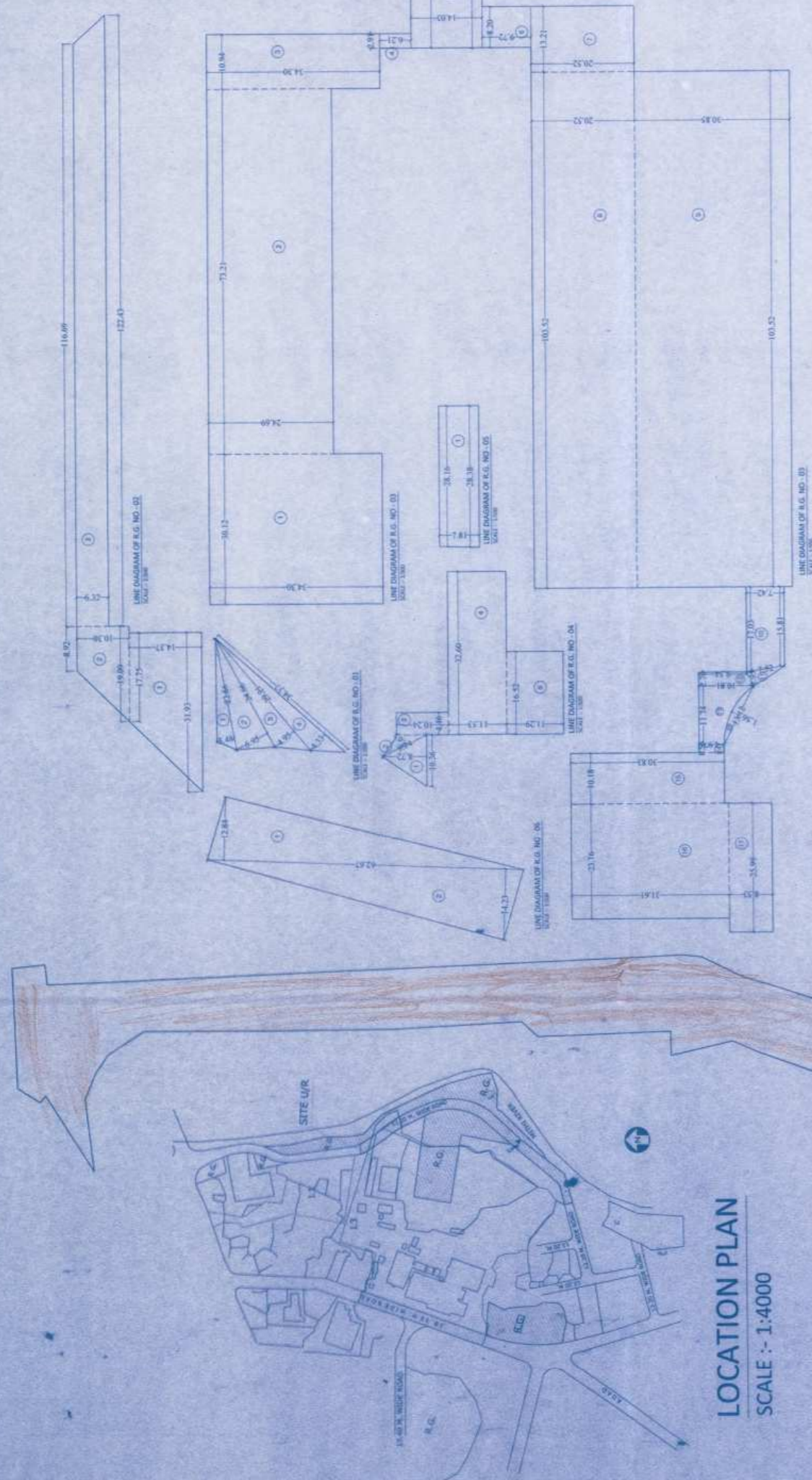

LOCATION PLAN
SCALE: 1:4000

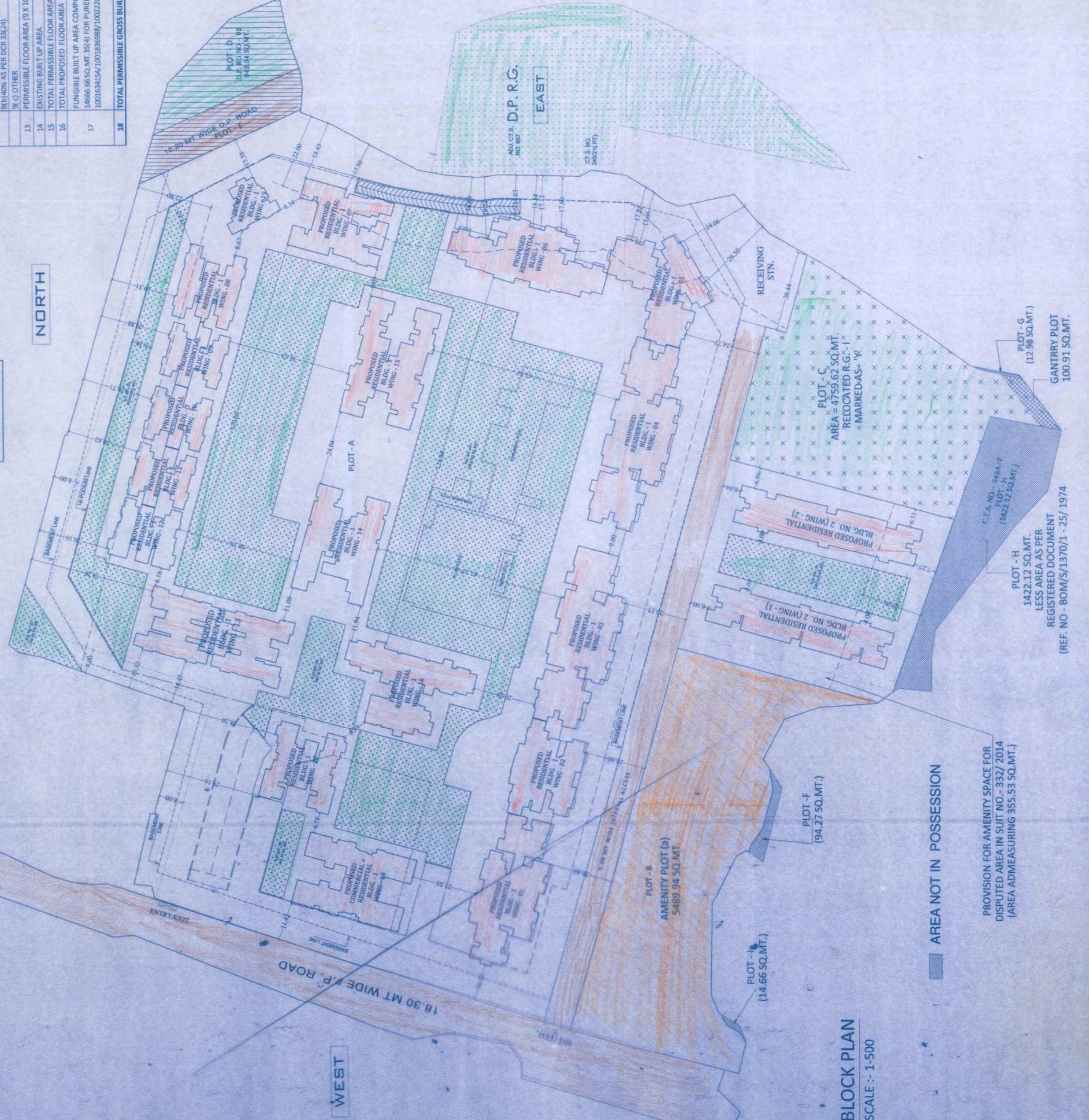

BLOCK PLAN
SCALE: 1:500

AREA NOT IN POSSESSION

PROVISION FOR AMENITY SPACE FOR DISPUTED AREA IN SUIT NO. - 332/ 2014 (AREA ADMEASURING 355.53 SQ.MT.)

PLOT - G (12.98 SQ.MT.)
GANTRY PLOT 100.91 SQ.MT.
PLOT - H 1422.12 SQ.MT. LESS AREA AS PER REGISTERED DOCUMENT (REF. NO - BOM/S/1370/1 - 25/1974)

STAMP OF DATE OF APPROVAL OF PLAN

DESCRIPTION OF PROPOSAL & PROPERTY
REQUEST TO ALLOW RELOCATION OF RECREATION GROUND RESERVATION...
CITY NO. 446, 447, 448, 449, 450, 451, 452, 453, 454, 455, 456, 457, 458, 459, 460, 461, 462, 463, 464, 465, 466, 467, 468, 469, 470, 471, 472, 473, 474, 475, 476, 477, 478, 479, 480, 481, 482, 483, 484, 485, 486, 487, 488, 489, 490, 491, 492, 493, 494, 495, 496, 497, 498, 499, 500, 501, 502, 503, 504, 505, 506, 507, 508, 509, 510, 511, 512, 513, 514, 515, 516, 517, 518, 519, 520, 521, 522, 523, 524, 525, 526, 527, 528, 529, 530, 531, 532, 533, 534, 535, 536, 537, 538, 539, 540, 541, 542, 543, 544, 545, 546, 547, 548, 549, 550, 551, 552, 553, 554, 555, 556, 557, 558, 559, 560, 561, 562, 563, 564, 565, 566, 567, 568, 569, 570, 571, 572, 573, 574, 575, 576, 577, 578, 579, 580, 581, 582, 583, 584, 585, 586, 587, 588, 589, 590, 591, 592, 593, 594, 595, 596, 597, 598, 599, 600, 601, 602, 603, 604, 605, 606, 607, 608, 609, 610, 611, 612, 613, 614, 615, 616, 617, 618, 619, 620, 621, 622, 623, 624, 625, 626, 627, 628, 629, 630, 631, 632, 633, 634, 635, 636, 637, 638, 639, 640, 641, 642, 643, 644, 645, 646, 647, 648, 649, 650, 651, 652, 653, 654, 655, 656, 657, 658, 659, 660, 661, 662, 663, 664, 665, 666, 667, 668, 669, 670, 671, 672, 673, 674, 675, 676, 677, 678, 679, 680, 681, 682, 683, 684, 685, 686, 687, 688, 689, 690, 691, 692, 693, 694, 695, 696, 697, 698, 699, 700, 701, 702, 703, 704, 705, 706, 707, 708, 709, 710, 711, 712, 713, 714, 715, 716, 717, 718, 719, 720, 721, 722, 723, 724, 725, 726, 727, 728, 729, 730, 731, 732, 733, 734, 735, 736, 737, 738, 739, 740, 741, 742, 743, 744, 745, 746, 747, 748, 749, 750, 751, 752, 753, 754, 755, 756, 757, 758, 759, 760, 761, 762, 763, 764, 765, 766, 767, 768, 769, 770, 771, 772, 773, 774, 775, 776, 777, 778, 779, 780, 781, 782, 783, 784, 785, 786, 787, 788, 789, 790, 791, 792, 793, 794, 795, 796, 797, 798, 799, 800, 801, 802, 803, 804, 805, 806, 807, 808, 809, 810, 811, 812, 813, 814, 815, 816, 817, 818, 819, 820, 821, 822, 823, 824, 825, 826, 827, 828, 829, 830, 831, 832, 833, 834, 835, 836, 837, 838, 839, 840, 841, 842, 843, 844, 845, 846, 847, 848, 849, 850, 851, 852, 853, 854, 855, 856, 857, 858, 859, 860, 861, 862, 863, 864, 865, 866, 867, 868, 869, 870, 871, 872, 873, 874, 875, 876, 877, 878, 879, 880, 881, 882, 883, 884, 885, 886, 887, 888, 889, 890, 891, 892, 893, 894, 895, 896, 897, 898, 899, 900, 901, 902, 903, 904, 905, 906, 907, 908, 909, 910, 911, 912, 913, 914, 915, 916, 917, 918, 919, 920, 921, 922, 923, 924, 925, 926, 927, 928, 929, 930, 931, 932, 933, 934, 935, 936, 937, 938, 939, 940, 941, 942, 943, 944, 945, 946, 947, 948, 949, 950, 951, 952, 953, 954, 955, 956, 957, 958, 959, 960, 961, 962, 963, 964, 965, 966, 967, 968, 969, 970, 971, 972, 973, 974, 975, 976, 977, 978, 979, 980, 981, 982, 983, 984, 985, 986, 987, 988, 989, 990, 991, 992, 993, 994, 995, 996, 997, 998, 999, 1000

NAME OF THE OWNER: Neepa Real Estate Pvt.Ltd.
SIGNATURE: [Signature]
NAME & ADDRESS OF LICENSED SURVEYOR (L.S.): [Signature]
B-10c, Neepa Building, 100, Queen's Road East, Hong Kong. Registered Professional Members - 400/000