

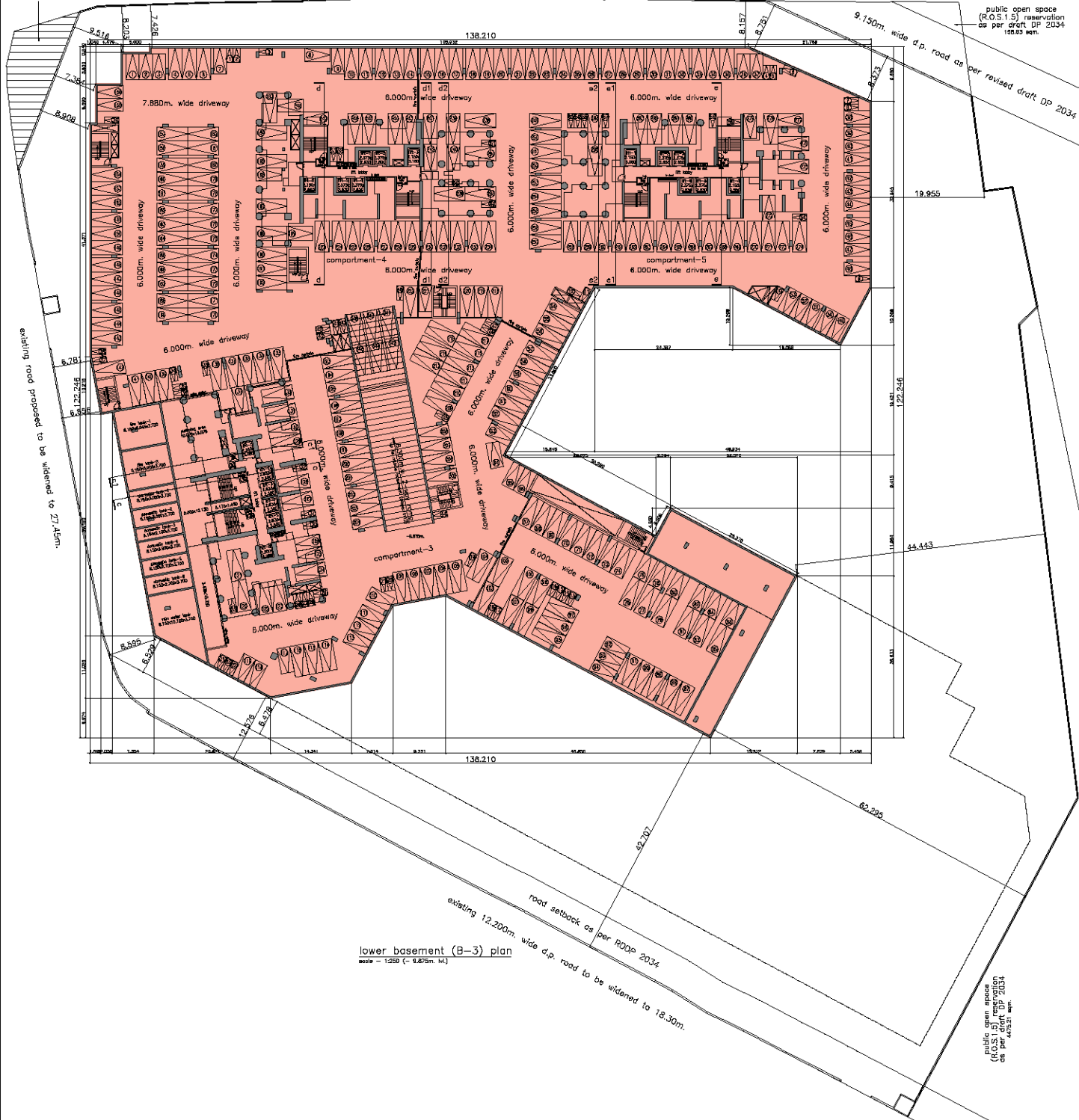



road setback as per draft dp 2034



car parking statement : L basement				
type	big	small	2-w	total
surface	226	19	60	305
stack	-	-	-	-
multistorey	-	-	-	-
total	226	19	60	305

**PROFORMA - B**

CONTENTS OF SHEET

lower basement (B-3) plan

STAMP OF DATE OF RECEIPT OF PLANS

This cancels APPROVAL to the previous Plan Sanctioned under No. CHE/ES/1689/S/337(NEW) Date 23 April 2018

STAMP OF APPROVAL OF PLANS

Approved subject to the conditions mentioned in this office No. CHE/ES/1689/S/337(NEW)

**AVINASH GORAKSH TAMBEWAG H**

Executive Engineer Bldg. Prop. (E/S)-II

**PRADIP KUMBE SURYABALI PATHAK**      **JAYESH CHHAGAN DUSANE**

S.E.(B.P.)S&T/E      A.E.(B.P.)S&T

DESCRIPTION OF PROPOSAL & PROPERTY

PROPOSED RESIDENTIAL PLOT COMPRISING OF MIXED A.B.C.D & E OH PROPERTY BEARING C.T.S. NO. 1004,1005,1006/1,1006,1007(P1),1007/2(P1),1007/4, 1008(P1),1008/2 & 6,1010(P1),1011(P1),1014(P1), 1014/1 TO 6,1017,1017/1 TO 6,1018,1018/1 TO 6 OF VILLAGE FARUKH, AT KANUNWARI (E), MUMBAI.

NAME OF OWNER  
**MURAD RAJESH PATHAK**  
EME REAL ESTATE PVT. LTD., C.A TO M/S. CROMPTON GREAVES LTD.

JOB NO. / DATE      DWG. NO. / SCALE      DWN BY      CRSD BY

**SUNIL AMBRE & ASSOCIATES ARCHITECTS**  
210 FLR, AGNI HOUSE, 35/31 SHREE SWABHA NAGR, BEHIND FITTIN HOUSE, PATA GUDA, FORT, MUMBAI. PH-40 024 15 10, 2200865, 2202067 / 094

lower basement (B-3) plan  
scale - 1:250 (- 9.875m : 1:1)

public open space (R.O.S. 1.5) reservation as per draft DP 2034



road setback as per draft dp 2034

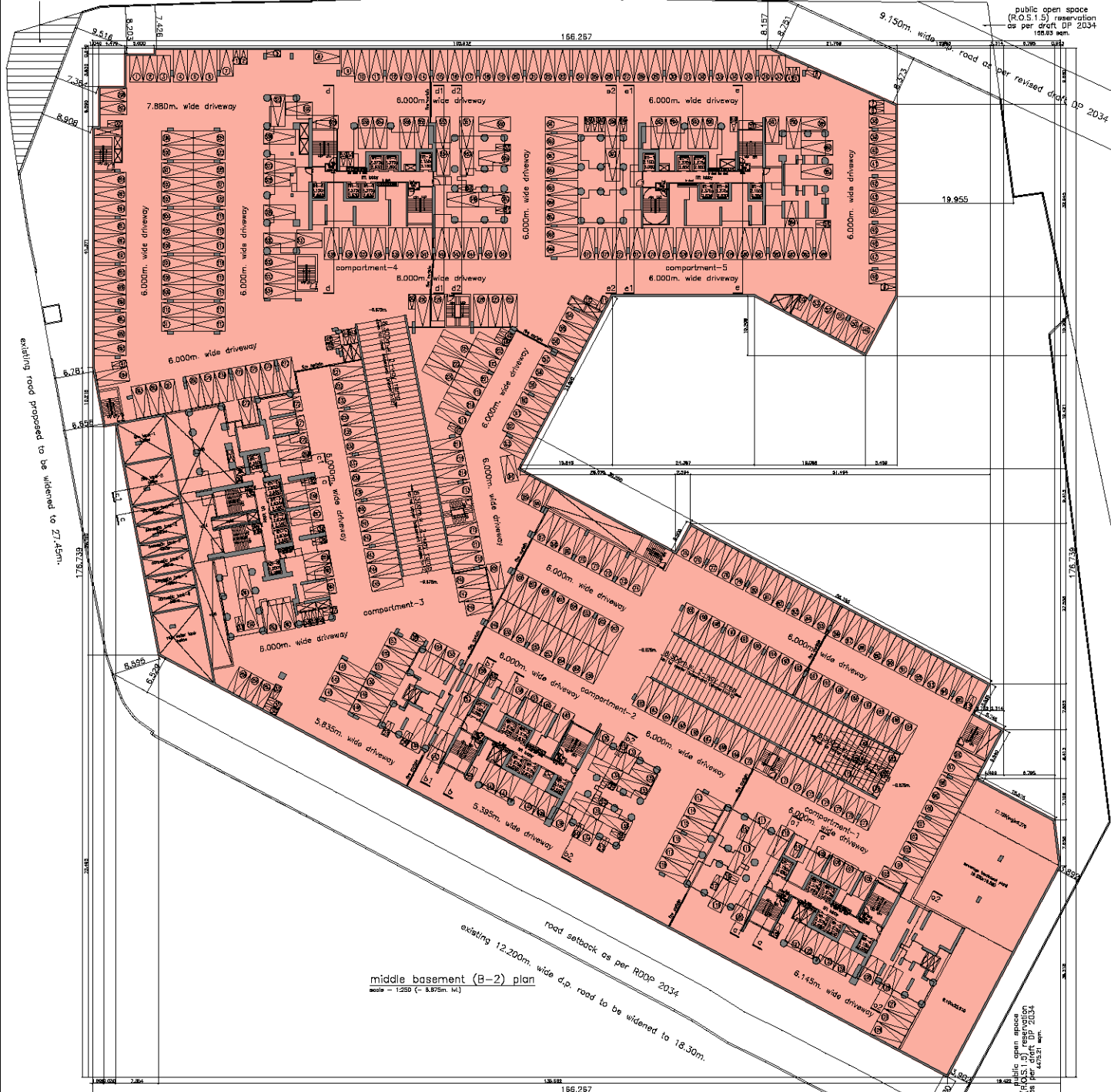

middle basement (B-2) plan  
scale = 1:250 (- 8.875m. 1:4)

car parking statement : m. basement (R.O.S.) reservation as per draft DP 2034				
type	big	small	2-w	total
surface	318	76	62	456
stack	-	-	-	-
mechanical	-	-	-	-
total	318	76	62	456

PROFORMA - B  
CONTENTS OF SHEET  
middle basement (B-2) plan  
STAMP OF DATE OF RECEIPT OF PLANS

This cancels APPROVAL to the previous Plan Sanctioned under No. CHE/ES/1689/S/337(NEW) Date 23 April 2018

STAMP OF APPROVAL OF PLANS  
Approved subject to the conditions mentioned in this office No. CHE/ES/1689/S/337(NEW)

**AVINASH GORAKSH TAMBEWAG H**  
Executive Engineer Bldg. Prop. (E/S)-II

**JAYESH CHHAGAN DUSANE**  
S.E.(B.P.)S&T / E A.E.(B.P.)S&T

DESCRIPTION OF PROPOSAL & PROPERTY  
PROPOSED RESIDENTIAL BLDG COMPRISING OF WINGS A,B,C,D & E ON PROPERTY BEARING C.T.S. NO. 1004/1005/1006/11/1006/1010(P1)/1007/20(P1)/1007/4/1008(P1)/1008/5 & 6/1010(P1)/1013(P1)/1014(P1)/1014/1 TO 6/1017/1017/1 TO 6/1018/1018/1 TO 9 OF VILLAGE PALUR, AT TAMBAWAG (S), MUMBAI.

NAME OF OWNER  
**MUNIND KASHINATH PATIL**  
SME REAL ESTATE PVT. LTD., C.A TO M/S. GROMPTON CREAVES LTD.

**SUNIL AMBRE & ASSOCIATES ARCHITECTS**  
210 FUL, AGNI HOUSE, 35/31 SHREE SWABHA NAG, BEHIND PITHI HOUSE, PALA GUDA, FORT, MUMBAI. PH-40 024, 15, 16, 2200865, 2202007 / 094