

AMENDED DEVELOPMENT PERMISSION GRANTED Subject to the conditions mentioned in this office's letter No. C/P/CO/NA/JANVIL/Kolkhe/SP 51/Amended/02/2018/10/95 Dated 09 JAN 2018 Associate Planner (JANNA)

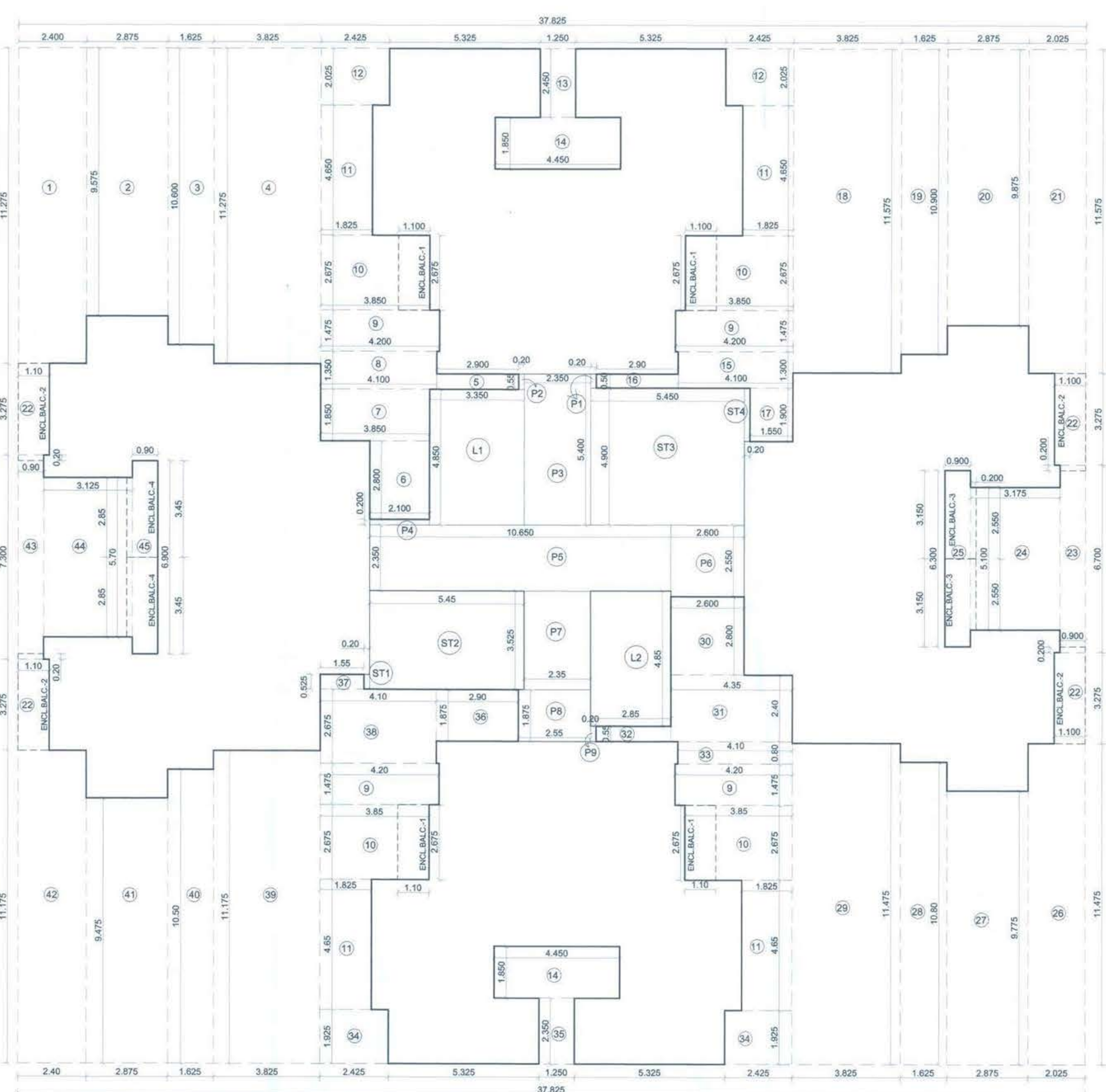

TYPICAL FLR. PLAN 2ND TO 7TH, 9TH TO 13TH, 15TH TO 19TH, 21ST TO 25TH, 27TH FLR PLAN (BLDG. S1 WING - B) SCALE: 1:100

LINE AREA DIAGRAM 2nd to 7th, 9th to 13th, 15th to 19th, 21st to 25th, 27th TYPICAL FLOOR (BLDG. S1-WING-B) SCALE: 1:100

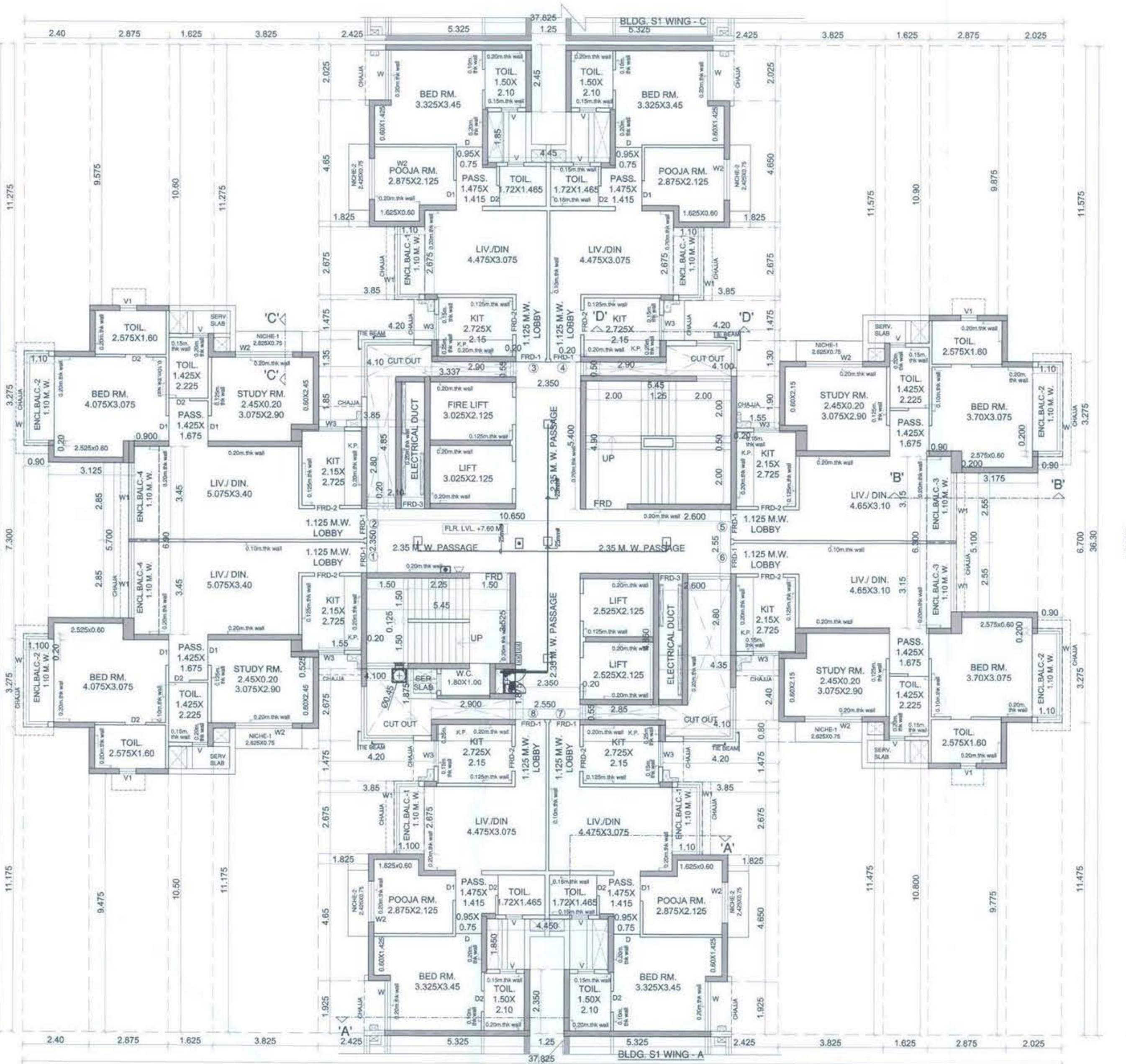
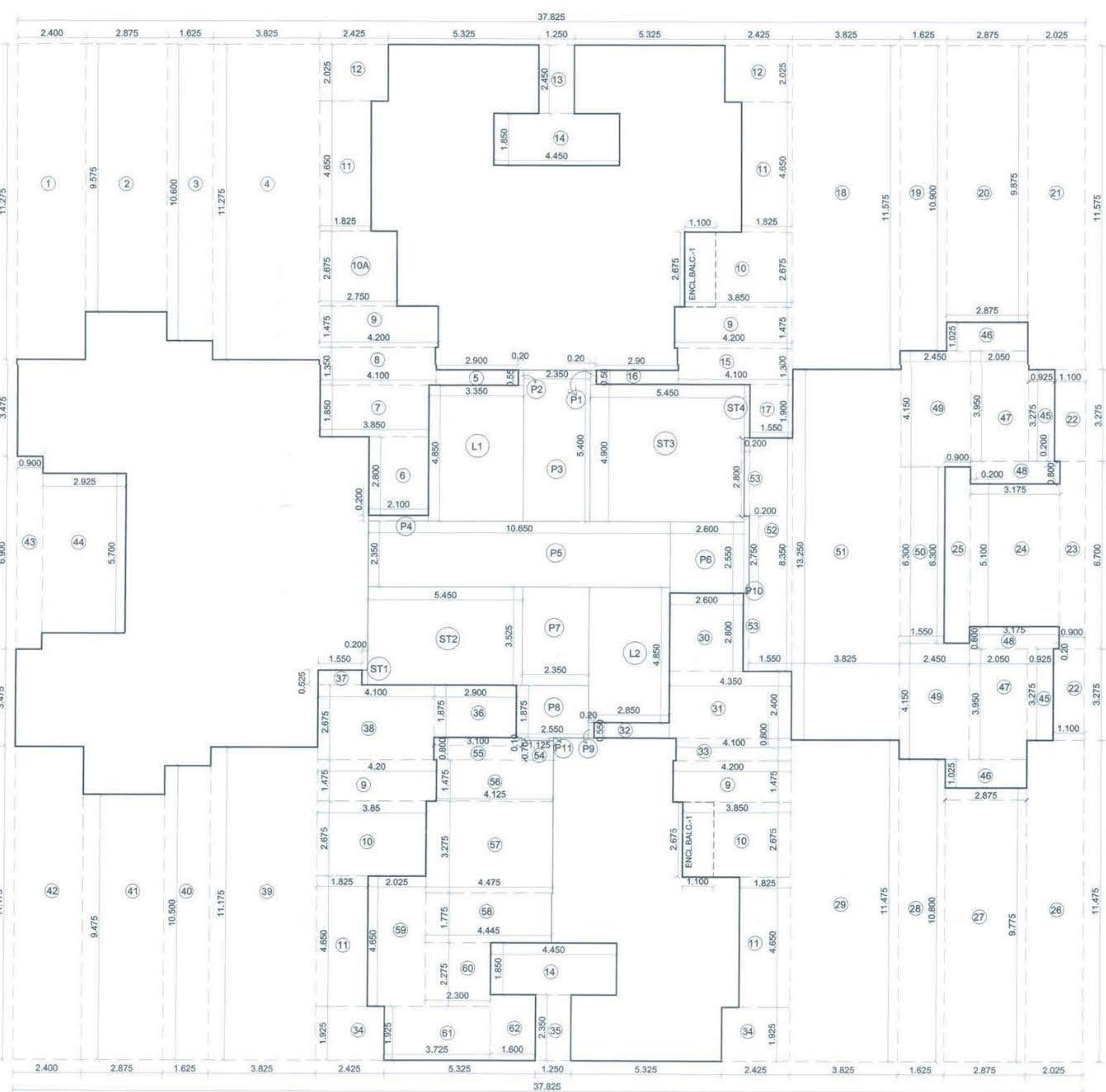
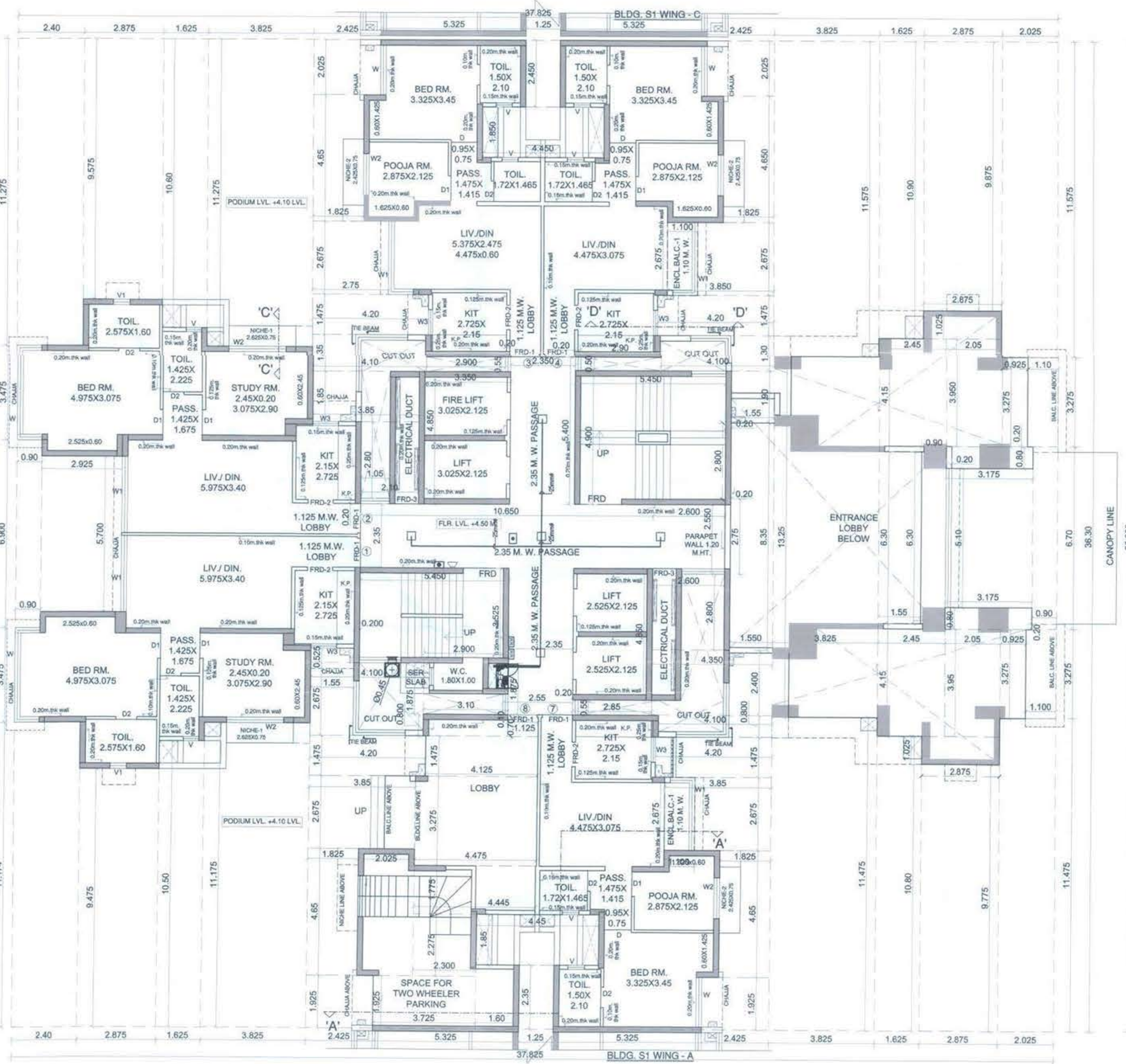

1ST FLOOR PLAN (BLDG. S1 WING - B) SCALE: 1:100

LINE AREA DIAGRAM 1st FLOOR (BLDG. S1-WING-B) SCALE: 1:100

Table with 4 columns: RECEPTION, AREA, HEIGHT, TYPE OF DOOR. Lists door types and their specifications.

Table with 4 columns: TYPE, AREA IN SQ.MT., HEIGHT, DESCRIPTION. Lists window types and their specifications.

Table with 2 columns: NICHE AREA STATEMENT, AREA. Lists niche areas for the 1st floor.

Table with 2 columns: NICHE AREA STATEMENT, AREA. Lists niche areas for the 2nd to 27th typical floors.

Table with 2 columns: BUILT UP AREA CALCULATION S1 WING - B, AREA. Lists built-up area calculations for the 1st floor.

Table with 2 columns: BUILT UP AREA CALCULATION S1 WING - B, AREA. Lists built-up area calculations for the 2nd to 27th typical floors.

Table with 2 columns: ADDITION (A), AREA. Lists addition calculations for the 1st floor.

Table with 2 columns: ADDITION (A), AREA. Lists addition calculations for the 2nd to 27th typical floors.

Table with 2 columns: ADDITION (A), AREA. Lists addition calculations for the 1st floor.

Table with 2 columns: ADDITION (A), AREA. Lists addition calculations for the 2nd to 27th typical floors.

Table with 2 columns: ADDITION (A), AREA. Lists addition calculations for the 1st floor.

Table with 2 columns: BUILT UP AREA CALCULATION S1 WING - B, AREA. Lists built-up area calculations for the 2nd to 27th typical floors.

Table with 2 columns: ADDITION (A), AREA. Lists addition calculations for the 2nd to 27th typical floors.

Table with 2 columns: ADDITION (A), AREA. Lists addition calculations for the 2nd to 27th typical floors.

Table with 2 columns: ADDITION (A), AREA. Lists addition calculations for the 2nd to 27th typical floors.

Table with 2 columns: ADDITION (A), AREA. Lists addition calculations for the 2nd to 27th typical floors.

Table with 2 columns: ADDITION (A), AREA. Lists addition calculations for the 2nd to 27th typical floors.

Table with 2 columns: ADDITION (A), AREA. Lists addition calculations for the 2nd to 27th typical floors.

Table with 2 columns: ADDITION (A), AREA. Lists addition calculations for the 2nd to 27th typical floors.

1) - ALL INTERNAL WALLS IN RESIDENTIAL WING FLOOR PLAN & CALCULATION IS 0.15 M. THICK UNLESS OTHERWISE SPECIFY IF PROPOSED WORK SHOWN IN RED

Table with 4 columns: REVISION, DESCRIPTION, DATE, SIGNATURE. Revision table for the drawing.

DESCRIPTION OF PROPOSAL & PROPERTY PROPOSED SALE RESIDENTIAL BLDG S1 WING-B ON LAND BEARING S NO. 94/1D, 95/1, 95/2, 95/3A, 95/3B, 95/4, 95/5, 97/1, 97/2, 98/1A, 98/2A, 98/3A, 98/6C, 98/6D AT VILLAGE KOLKHE TAL. PANVEL, DIST - RAIGAD.

NAME & SIGNATURE OF OWNERS M/s SANVO RESORTS PVT. LTD. SIGNATURE OF ARCHITECT