

BLDG. TYPE	BLDG. DESCRIPTION	NO. OF FLOORS	BUILT UP AREA INCLUDING STAIRCASE TYPICAL FLOOR	TOTAL BUILT UP AREA (IN SQ.M.)
A	BASEMENT-1 + BASE-2 + POOL-1 + POOL-2 + STILT + 24TH FLOOR	STILT FLOOR 1ST TO 4TH, 6TH, 7TH 9TH TO 12TH, 14TH TO 17TH 19TH TO 22ND	72.50 X 1 = 72.50 566.12 X 19 = 10756.28	11790.80 SQ.M.
B	BASEMENT-1 + BASE-2 + POOL-1 + POOL-2 + STILT + 23RD FLOOR	STILT FLOOR 1ST TO 4TH, 6TH, 7TH 9TH TO 12TH, 14TH TO 17TH 19TH TO 22ND	72.06 X 1 = 72.06 560.73 X 18 = 10093.14	10865.20 SQ.M.
C	BASEMENT-1 + BASE-2 + POOL-1 + POOL-2 + STILT + 23RD FLOOR	STILT FLOOR 1ST TO 4TH, 6TH, 7TH 9TH TO 12TH, 14TH TO 17TH 19TH TO 22ND	72.71 X 1 = 72.71 547.82 X 18 = 9860.76	10633.47 SQ.M.
D	BASEMENT-1 + BASE-2 + POOL-1 + POOL-2 + STILT + 23RD FLOOR	STILT FLOOR 1ST TO 4TH, 6TH, 7TH 9TH TO 12TH, 14TH TO 17TH 19TH TO 22ND	66.97 X 1 = 66.97 521.27 X 18 = 9382.86	10050.83 SQ.M.
E	BASEMENT-1 + BASE-2 + POOL-1 + POOL-2 + STILT + 23RD FLOOR	STILT FLOOR 1ST TO 4TH, 6TH, 7TH 9TH TO 12TH, 14TH TO 17TH 19TH TO 22ND	66.97 X 1 = 66.97 528.01 X 18 = 9504.18	10171.15 SQ.M.
F	BASEMENT-1 + BASE-2 + POOL-1 + POOL-2 + STILT + 23RD FLOOR	STILT FLOOR 1ST TO 4TH, 6TH, 7TH 9TH TO 12TH, 14TH TO 17TH 19TH TO 22ND	72.71 X 1 = 72.71 547.82 X 18 = 9860.76	10633.47 SQ.M.
G	BASEMENT-1 + BASE-2 + POOL-1 + POOL-2 + STILT + 23RD FLOOR	STILT FLOOR 1ST TO 4TH, 6TH, 7TH 9TH TO 12TH, 14TH TO 17TH 19TH TO 22ND	72.06 X 1 = 72.06 560.73 X 18 = 10093.14	10865.20 SQ.M.
H	BASEMENT-1 + BASE-2 + POOL-1 + POOL-2 + STILT + 23RD FLOOR	STILT FLOOR 1ST TO 4TH, 6TH, 7TH 9TH TO 12TH, 14TH TO 17TH 19TH TO 22ND	66.41 X 1 = 66.41 459.10 X 18 = 8263.80	8928.21 SQ.M.
PROPOSED RESIDENTIAL BUILT UP AREA (A)				
			72.50 X 1 = 72.50	11790.80 SQ.M.
			72.06 X 1 = 72.06	10865.20 SQ.M.
			72.71 X 1 = 72.71	10633.47 SQ.M.
			66.97 X 1 = 66.97	10050.83 SQ.M.
			66.97 X 1 = 66.97	10171.15 SQ.M.
			72.71 X 1 = 72.71	10633.47 SQ.M.
			72.06 X 1 = 72.06	10865.20 SQ.M.
			66.41 X 1 = 66.41	8928.21 SQ.M.
PROPOSED COMMERCIAL BUILT UP AREA (B)				
			273.26 X 1 = 273.26	9572.25 SQ.M.
			547.97 X 1 = 547.97	1918.83 SQ.M.
			791.20 X 23 = 18197.80	1918.83 SQ.M.
PROPOSED TEMPORARY STRUCTURE BUILT UP AREA (C)				
			407.47 X 1 = 407.47	13542.06 SQ.M.
			580.83 X 22 = 12778.26	
			356.27 X 1 = 356.27	
TOTAL PROPOSED BUILT UP AREA				
				32989.83 SQ.M.

PROPOSED TENEMENT STATEMENT:				
BLDG. NO.	TENEMENT LESS THAN 35 SQ.M.	TENEMENT 35 TO 50 SQ.M.	ABOVE 50 TO 75 SQ.M.	TOTAL
T	1000	---	---	1000 NO.
A	---	---	72	72 NO.
B	---	---	64	64 NO.
C	---	---	64	64 NO.
D	---	---	67	67 NO.
E	---	---	67	67 NO.
F	---	---	64	64 NO.
G	---	---	64	64 NO.
H	---	---	64	64 NO.
TOTAL	1635 NO.	497 NO.	548 NO.	2780 NO.

PROPOSED PARKING SALES BUILDINGS:				
FLOOR	4 WHEELER	2 WHEELER	TOTAL	RENTAL BUILDING
2ND BASEMENT	136	388	524	250
1ST BASEMENT	97	479	576	265
GROUND FLOOR	349	479	828	206
1ST POOLM	270	---	270	97
2ND POOLM	324	---	324	219
STILT FLOOR	---	---	---	---
TOTAL	1176	876	2052	1087

PARKING AREA STATEMENT RENTAL BUILDING:				
DESCRIPTION	NOS. OF FLAT	UNIT	PARKING REQD.	RENTAL BUILDING
LESS THAN 35 SQ.M.	NIL	NIL	NIL	NIL
35 TO 50 SQ.M. FLATS	407 NOS	2 PARK / 1 FLAT	814 NOS	365 NOS
50 TO 75 SQ.M. FLATS	497 NOS	1 PARK / 1 FLAT	497 NOS	219 NOS
ABOVE 75 SQ.M.	548 NOS	2 PARK / 1 FLAT	1096 NOS	497 NOS
TOTAL	952 NOS	---	2407 NOS	1087 NOS
10% VISITORS	---	---	240 NOS	---
TOTAL WHEELER PARKING REQUIRED FOR DEVELOPER SALE BLDGS. (RES)	---	---	2647 NOS	---
COMMERCIAL AREA = 1713.35 SQ.M.	---	---	69 NOS.	---
TOTAL WHEELER PARKING REQUIRED 1683 + 69 =	---	---	1752 NOS	---

2 WHEELER PARKING REQUIREMENT (1 FLAT 1 PARK) TOTAL NO. OF FLAT = 955 NOS.				
DESCRIPTION	NOS. OF FLAT	UNIT	PARKING REQD.	RENTAL BUILDING
LESS THAN 35 SQ.M.	NIL	NIL	NIL	NIL
35 TO 50 SQ.M. FLATS	407 NOS	1 PARK / 1 FLAT	407 NOS	185 NOS
50 TO 75 SQ.M. FLATS	497 NOS	1 PARK / 1 FLAT	497 NOS	219 NOS
ABOVE 75 SQ.M.	548 NOS	2 PARK / 1 FLAT	1096 NOS	497 NOS
TOTAL	952 NOS	---	2000 NOS	901 NOS
10% VISITORS	---	---	200 NOS	---
TOTAL WHEELER PARKING REQUIRED FOR DEVELOPER SALE BLDGS. (RES)	---	---	2200 NOS	---
COMMERCIAL AREA (SALE-1713.35) = 1713.35 / 20 = 85 NOS.	---	---	85 NOS.	---
TOTAL WHEELER PARKING REQUIRED (85+85) =	---	---	170 NOS	---

PLOT AREA CALCULATION:				
S.NO.	C.T.S. NO.	AS PER POLYLINE	AS PER P.S. PLAN	DIFFERENCE
1	1892	4493.81	4493.81	0.00
2	1893	382.33	382.33	0.00
3	1894	393.41	393.41	0.00
4	1895	29.34	29.34	0.00
5	1896	34.83	34.83	0.00
6	1897	44.96	44.96	0.00
7	1898	17.45	17.45	0.00
8	1899	16.72	16.72	0.00
9	1900	18.54	18.54	0.00
10	1901	23.35	23.35	0.00
11	1902	21.25	21.25	0.00
12	1903	14.56	14.56	0.00
13	1904	18.58	18.58	0.00
14	1905	23.25	23.25	0.00
15	1906	25.50	25.50	0.00
16	1907	18.50	18.50	0.00
17	1908	41.87	41.87	0.00
18	1909	61.87	61.87	0.00
19	1910	61.87	61.87	0.00
20	1911	61.87	61.87	0.00
21	1912	6.29	6.29	0.00
22	1913	6.29	6.29	0.00
23	1914	6.29	6.29	0.00
24	1915	6.29	6.29	0.00
25	1916	6.29	6.29	0.00
26	1917	6.29	6.29	0.00
27	1918	6.29	6.29	0.00
28	1919	6.29	6.29	0.00
29	1920	6.29	6.29	0.00
30	1921	6.29	6.29	0.00
31	1922	14.88	14.88	0.00
32	1923	14.88	14.88	0.00
33	1924	14.88	14.88	0.00
34	1925	14.88	14.88	0.00
35	1926	14.88	14.88	0.00
36	1927	14.88	14.88	0.00
37	1928	14.88	14.88	0.00
38	1929	14.88	14.88	0.00
39	1930	14.88	14.88	0.00
40	1931	14.88	14.88	0.00
41	1932	14.88	14.88	0.00
42	1933	14.88	14.88	0.00
43	1934	14.88	14.88	0.00
44	1935	14.88	14.88	0.00
45	1936	14.88	14.88	0.00
46	1937	611.30	611.30	0.00
47	1938	597.52	597.52	0.00
TOTAL		6786.30	6786.30	0.00

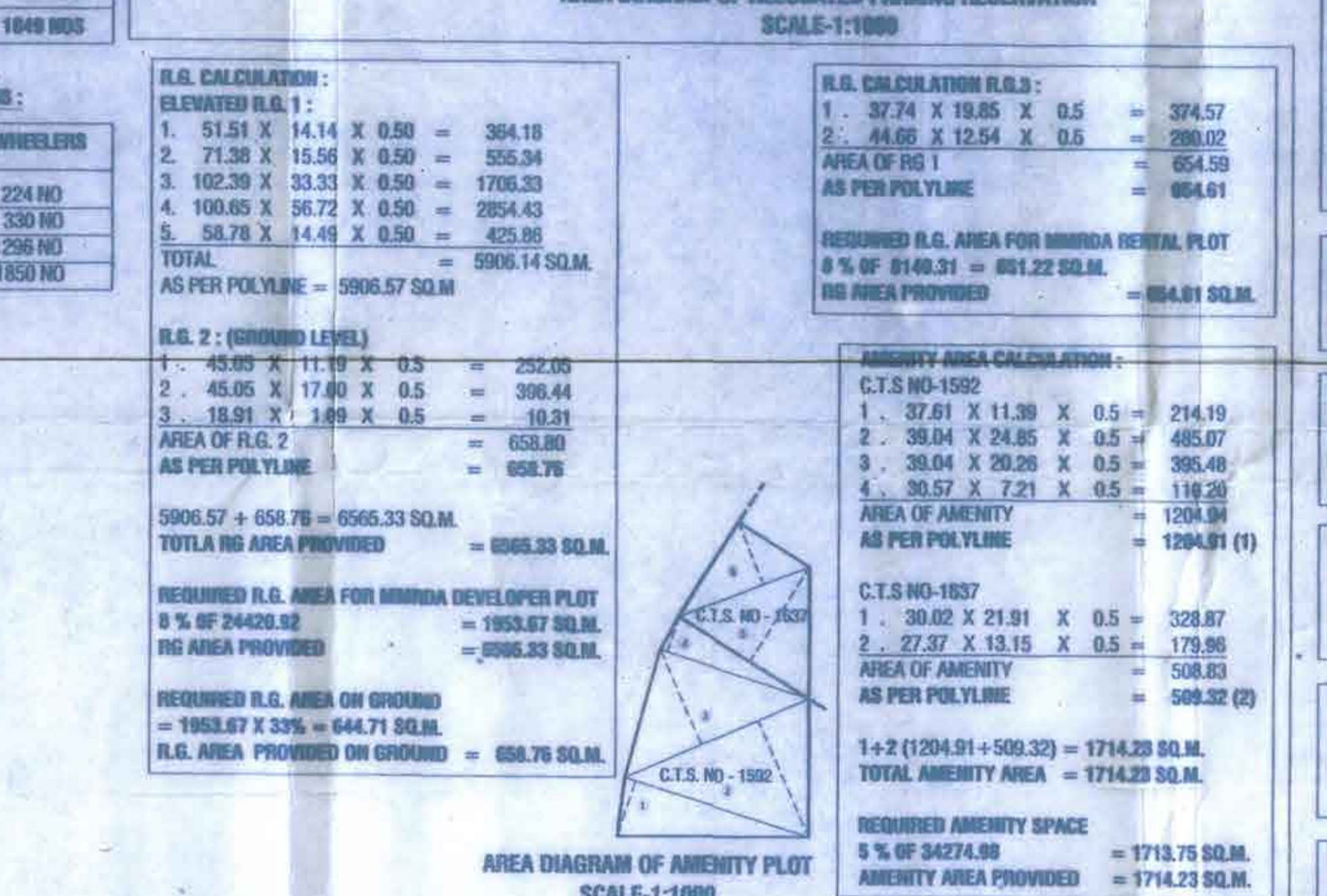
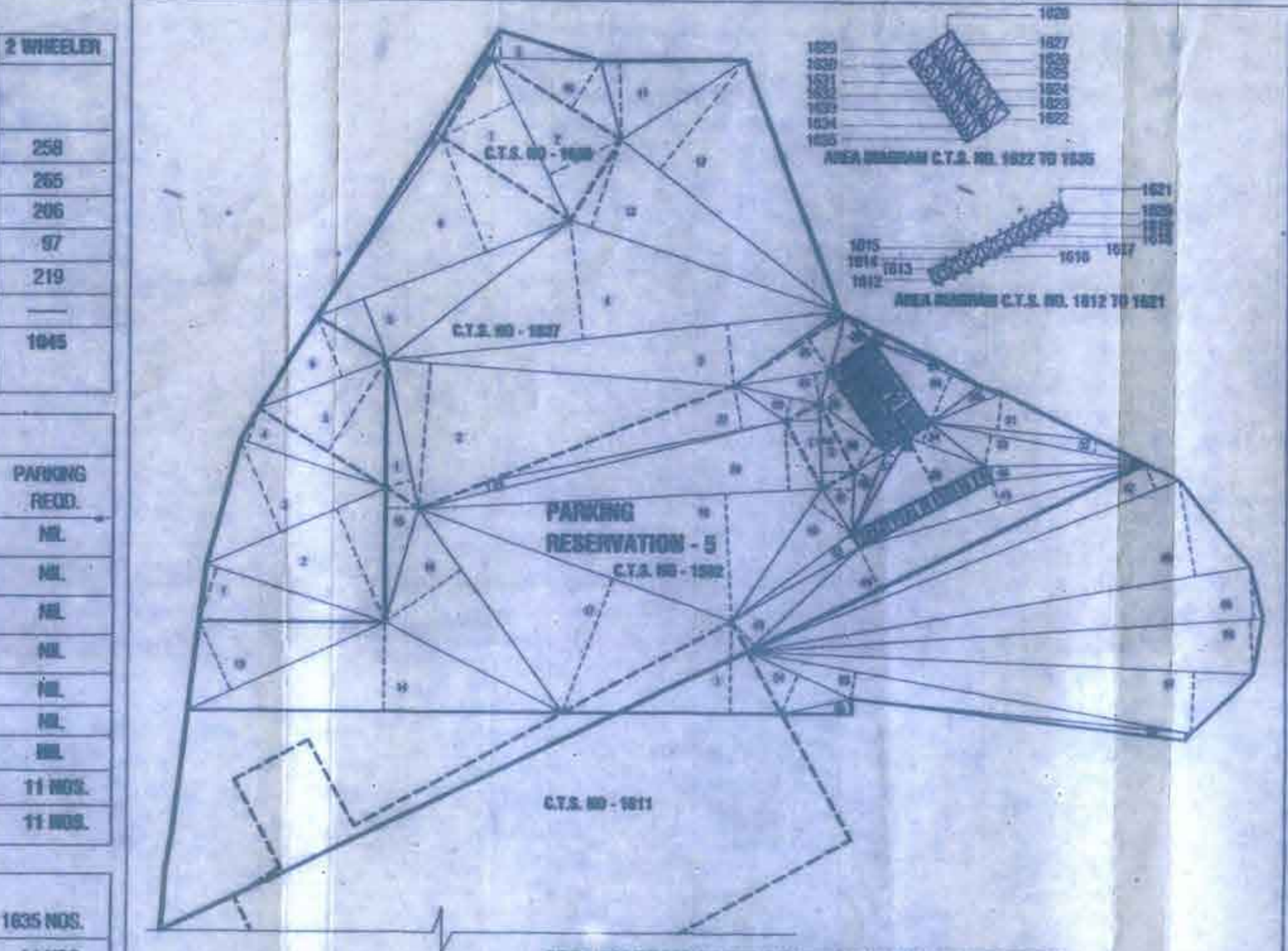

PLOT AREA CALCULATION:											
S.NO.	C.T.S. NO.	AS PER POLYLINE	AS PER P.S. PLAN	AREA UNDER 4000 WHEEL P.P. REQD.	AREA UNDER 14.88 WHEEL P.P. REQD.	PARKING RESERVATION - 1	R.2000	SUB PLOT C	SUB PLOT D	TOTAL BUILT UP AREA (SQ.M.)	DENSITY
1	1892	4493.81	4493.81	3066.63	1708.68	9212.04	2967.00	246.93	184.34		
2	1893	382.33	382.33	---	---	---	---	---	---		
3	1894	393.41	393.41	---	---	---	---	---	---		
4	1895	29.34	29.34	---	---	---	---	---	---		
5	1896	34.83	34.83	---	---	---	---	---	---		
6	1897	44.96	44.96	---	---	---	---	---	---		
7	1898	17.45	17.45	---	---	---	---	---	---		
8	1899	16.72	16.72	---	---	---	---	---	---		
9	1900	18.54	18.54	---	---	---	---	---	---		
10	1901	23.35	23.35	---	---	---	---	---	---		
11	1902	21.25	21.25	---	---	---	---	---	---		
12	1903	14.56	14.56	---	---	---	---	---	---		
13	1904	18.58	18.58	---	---	---	---	---	---		
14	1905	23.25	23.25	---	---	---	---	---	---		
15	1906	25.50	25.50	---	---	---	---	---	---		
16	1907	18.50	18.50	---	---	---	---	---	---		
17	1908	41.87	41.87	---	---	---	---	---	---		
18	1909	61.87	61.87	---	---	---	---	---	---		
19	1910	61.87	61.87	---	---	---	---	---	---		
20	1911	61.87	61.87	---	---	---	---	---	---		
21	1912	6.29	6.29	---	---	---	---	---	---		
22	1913	6.29	6.29	---	---	---	---	---	---		
23	1914	6.29	6.29	---	---	---	---	---	---		
24	1915	6.29	6.29	---	---	---	---	---	---		
25	1916	6.29	6.29	---	---	---	---	---	---		
26	1917	6.29	6.29	---	---	---	---	---	---		
27	1918	6.29	6.29	---	---	---	---	---	---		
28	1919	6.29	6.29	---	---	---	---	---	---		
29	1920	6.29	6.29	---	---	---	---	---	---		
30	1921	6.29	6.29	---	---	---	---	---	---		
31	1922	14.88	14.88	---	---	---	---	---	---		
32	1923	14.88	14.88	---	---	---	---	---	---		
33	1924	14.88	14.88	---	---	---	---	---	---		
34	1925	14.88	14.88	---	---	---	---	---	---		
35	1926	14.88	14.88	---	---	---	---	---	---		
36	1927	14.88	14.88	---	---	---	---	---	---		
37	1928	14.88	14.88	---	---	---	---	---	---		
38	1929	14.88	14.88	---	---	---	---	---	---		
39	1930	14.88	14.88	---	---	---	---	---	---		
40	1931	14.88	14.88	---	---	---	---	---	---		
41	1932	14.88	14.88	---	---	---	---	---	---		
42	1933	14.88	14.88	---	---	---	---	---	---		
43	1934	14.88	14.88	---	---	---	---	---	---		
44	1935	14.88	14.88	---	---	---	---	---	---		
45	1936	14.88	14.88	---	---	---	---	---	---		
46	1937	611.30	611.30	---	---	---	---	---	---		
47	1938										