

TOTAL PROPOSED BUILT UP AREA STATEMENT

BLDG. NO.	GR. FL.	1ST. FLR.	2ND. FLR.	3RD. FLR.	4TH. FLR.	5TH. FLR.	6TH. FLR.	7TH. FLR.	8TH. FLR.	9TH. FLR.	TOTAL
1		172.53									172.53
2	STILT	172.53	172.53	172.53	172.53	172.53	172.53	139.75	172.53		1519.99
4	STILT	170.25									170.25
5	60.22										69.22
											1931.99

EXISTING BUILT UP AREA STATEMENT

BLDG. NO.	GR. FL.	1ST. FLR.	2ND. FLR.	3RD. FLR.	4TH. FLR.	5TH. FLR.	6TH. FLR.	7TH. FLR.	TOTAL
3		206.74	206.74	206.74	206.74	206.74	206.74	206.74	1447.18

TOTAL PARKING AREA STATEMENT

BLDG. NO.	NO. OF FLAT EXISTING	NO. OF FLAT PROPOSED	PARKING REQUIRE D	PARKING PROVIDED
1	-	148	148	148
2	-	35	35	35
3	48	02	50	50
4	-	06	06	06

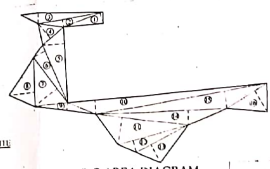
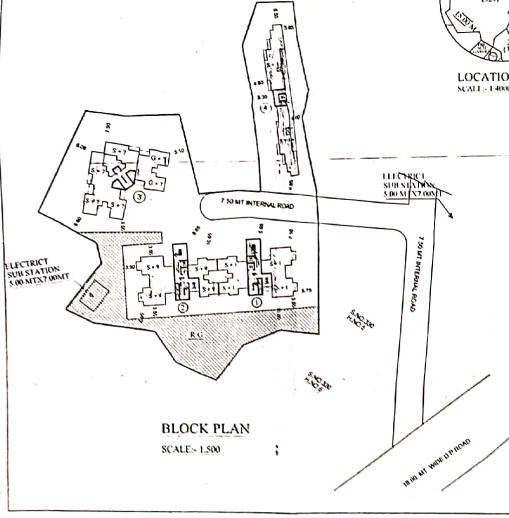

R.G AREA CALCULATION

1	11.55 x 2.08 x 0.5	= 12.17 sq.m
2	11.14 x 1.92 x 0.5	= 10.76 sq.m
3	21.15 x 2.93 x 0.5	= 30.91 sq.m
4	4.80 x 3.23 x 0.5	= 7.76 sq.m
5	21.85 x 4.05 x 0.5	= 43.80 sq.m
6	12.15 x 1.69 x 0.5	= 10.24 sq.m
7	18.83 x 2.89 x 0.5	= 27.24 sq.m
8	18.27 x 2.42 x 0.5	= 22.13 sq.m
9	12.26 x 2.13 x 0.5	= 12.93 sq.m
10	16.11 x 1.87 x 0.5	= 15.14 sq.m
11	22.27 x 1.52 x 0.5	= 16.91 sq.m
12	12.48 x 1.79 x 0.5	= 11.07 sq.m
13	17.58 x 2.83 x 0.5	= 24.85 sq.m
14	11.42 x 1.90 x 0.5	= 10.83 sq.m
15	40.49 x 4.76 x 0.5	= 96.92 sq.m
16	15.51 x 6.70 x 0.5	= 51.67 sq.m
TOTAL R.G.F.F.R.O.		= 614.49 sq.m
R.G.F.F.R.O.		= 604.00 sq.m

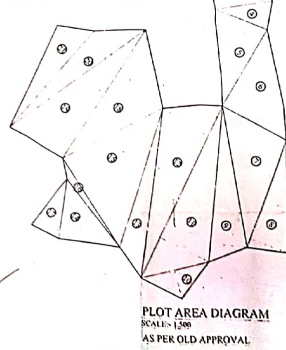

PLOT AREA CALCULATION AS PER APPROVAL

1	28.00 x 10.00 x 0.5	= 140.00 sq.m
2	28.00 x 10.00 x 0.5	= 140.00 sq.m
3	25.00 x 8.00 x 0.5	= 100.00 sq.m
4	15.00 x 8.00 x 0.5	= 60.00 sq.m
5	25.00 x 13.00 x 0.5	= 162.50 sq.m
6	25.00 x 10.00 x 0.5	= 125.00 sq.m
7	18.00 x 18.00 x 0.5	= 162.00 sq.m
8	17.00 x 10.00 x 0.5	= 85.00 sq.m
9	42.00 x 10.00 x 0.5	= 210.00 sq.m
10	20.00 x 8.00 x 0.5	= 80.00 sq.m
11	48.00 x 13.00 x 0.5	= 312.00 sq.m
12	48.00 x 11.00 x 0.5	= 264.00 sq.m
13	48.00 x 8.00 x 0.5	= 192.00 sq.m
14	32.00 x 12.00 x 0.5	= 192.00 sq.m
15	30.00 x 22.00 x 0.5	= 330.00 sq.m
16	20.00 x 12.00 x 0.5	= 120.00 sq.m
17	12.00 x 8.00 x 0.5	= 48.00 sq.m
18	42.00 x 14.00 x 0.5	= 294.00 sq.m
19	38.00 x 14.00 x 0.5	= 266.00 sq.m
20	45.00 x 8.00 x 0.5	= 180.00 sq.m
21	24.00 x 7.00 x 0.5	= 84.00 sq.m
TOTAL		= 4387.71 sq.m

—संशोधन—
मि. अशोक चव्हाण
अथवा
मि. अशोक चव्हाण
अथवा
मि. अशोक चव्हाण

श्री. अशोक चव्हाण, पिनकोड, अशोक चव्हाण
मि. अशोक चव्हाण, पिनकोड, अशोक चव्हाण
मि. अशोक चव्हाण, पिनकोड, अशोक चव्हाण



FORM I

CONTENTS OF SHEET
THIS PLAN IS THE RESULT OF AREA CALCULATION
THIS PLAN AND THE AREA STATEMENT

STAMP OF DATE OF RECEIPT OF PLANS **STAMP OF APPROVAL OF PLANS**

REVISION	DESCRIPTION	DATE	SIGNATURE

CERTIFICATE OF AREA
I HEREBY CERTIFY THAT THE AREA CALCULATION OF THE ABOVE PLANS AND THE AREA STATEMENT IS CORRECT AND ACCURATE AND THAT THE AREA CALCULATION IS IN ACCORDANCE WITH THE RULES AND REGULATIONS OF THE MUNICIPAL CORPORATION, PUNE.

NAME OF THE OWNER
M/S. ANISH & ASSOCIATES
101, PLOT NO. 101, PLOT NO. 101, PLOT NO. 101

DATE **SCALE** **DRAWN BY** **CHECKED BY**
10/10/2019 1:500 P. P. P. P. P. P.

ANISH & ASSOCIATES
PLOT NO. 101, PLOT NO. 101, PLOT NO. 101
PLOT NO. 101, PLOT NO. 101, PLOT NO. 101