

**PROFORMA - B**

**CONTENTS OF SHEET**

STILT / GROUND FLOOR PLAN 23 MAY 2016

STAMP OF DATE OF RECEIPT OF PLAN

THIS CANCELS APPROVAL OF THE PREVIOUS PLANS SANCTIONED UNDER NOS. CHE/A-583/BJWS/AR DATE 4-11-2015

CHE A-583/BJWS/AR APPROVED SUBJECT TO THE CONDITION MENTIONED IN THE ACCOMPANYING OFFICE LETTER J-03

EXECUTIVE ENGINEER BLDG. PROPOSAL (W.S.R.) BHIMAN MURGAI MAHANAGAR PALIKA

124 MAY 2016

S.E.B.P.(R/N)

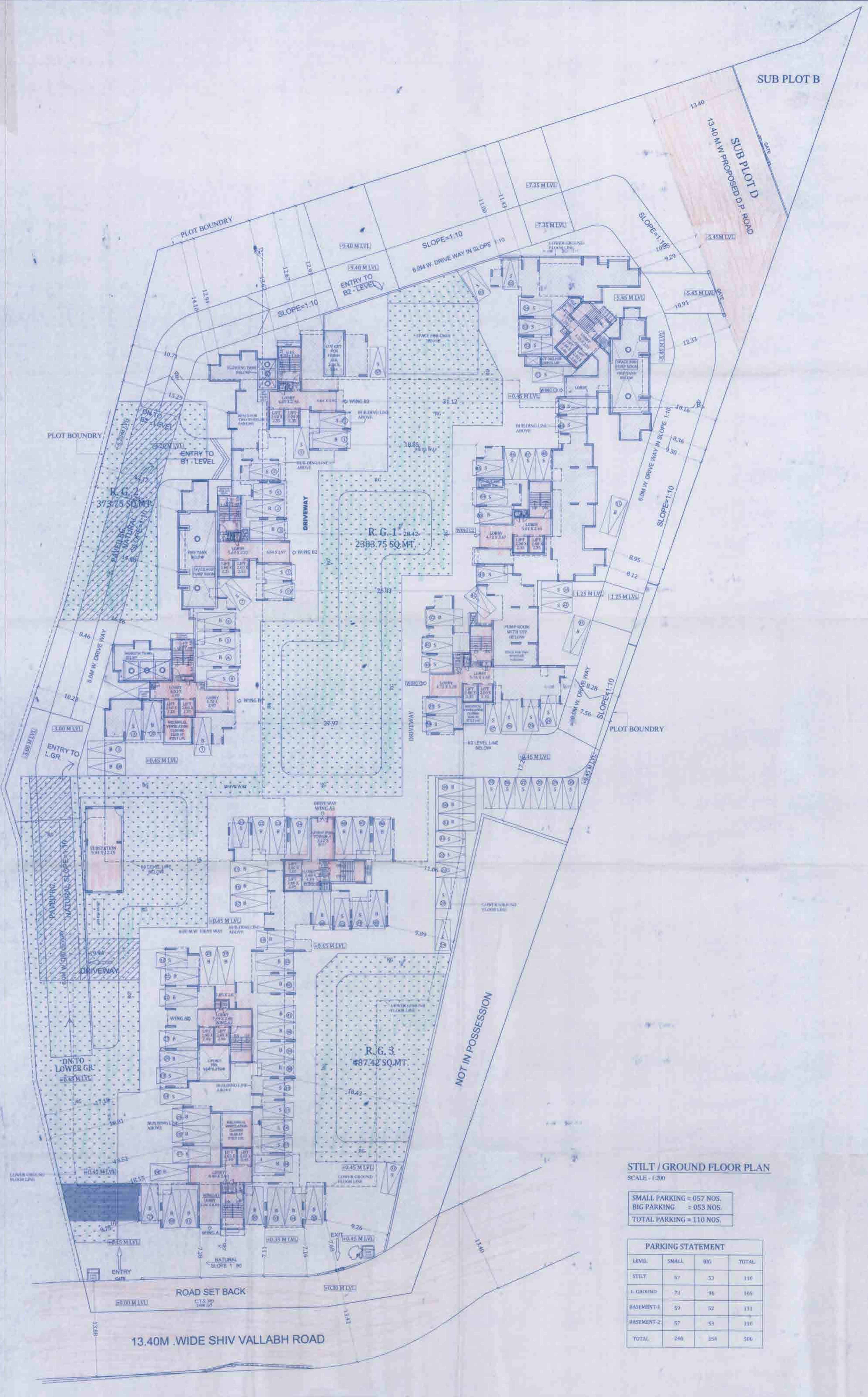

**STILT / GROUND FLOOR PLAN**  
SCALE - 1:200

SMALL PARKING = 057 NOS.  
BIG PARKING = 053 NOS.  
TOTAL PARKING = 110 NOS.

PARKING STATEMENT			
LEVEL	SMALL	BIG	TOTAL
STILT	57	53	110
I. GROUND	73	96	169
BASEMENT-1	59	52	111
BASEMENT-2	57	53	110
TOTAL	246	254	500

STAMP OF DATE OF APPROVAL OF PLAN

**DESCRIPTION OF PROPOSAL & PROPERTY**

PROPOSED RESIDENTIAL BLDG. ON PLOT BEARING CTS NO. 2400/7E IN VILLAGE DALHISAR, TAL. BOBROWALI IN R. WARD MUMBAI - 400059

NORTH	JOB. NO.	DRG. NO.	DRAWN BY
		0215	
	SCALE	DATE	CHECKED BY
	1:200		

REVISIONS DESCRIPTION:

NAME OF THE OWNER: MA. SHRETI INFRAWORLD PVT. LTD. SIGNATURE: [Signature]

NAME & ADDRESS OF LICENSED SURVEYOR (L.S.): SIGNATURE: [Signature]

SPACE ARCHITECTS  
11-10A, Netaji Building,  
Mumbai Corporate Link Road  
Mumbai (W), Mumbai - 400 080

PRODUCED BY AN AUTODESK EDUCATIONAL PRODUCT

PRODUCED BY AN AUTODESK EDUCATIONAL PRODUCT







THIS CANCELS APPROVAL OF THE PREVIOUS PLANS SANCTIONED UNDER CASE CHUB P-502/B/SADAR DATE 5-11-2015

APPROVED SUBJECT TO THE CONDITIONS MENTIONED IN THE APPROVAL OFFICE LETTER

PROPOSAL FOR THE PROJECT: REHMAN MUMBAI SAHANAGAR PALKA

DATE 12-4 MAY 2016  
S.E.P.(R/N)

STAMP OF DATE OF APPROVAL OF PLAN

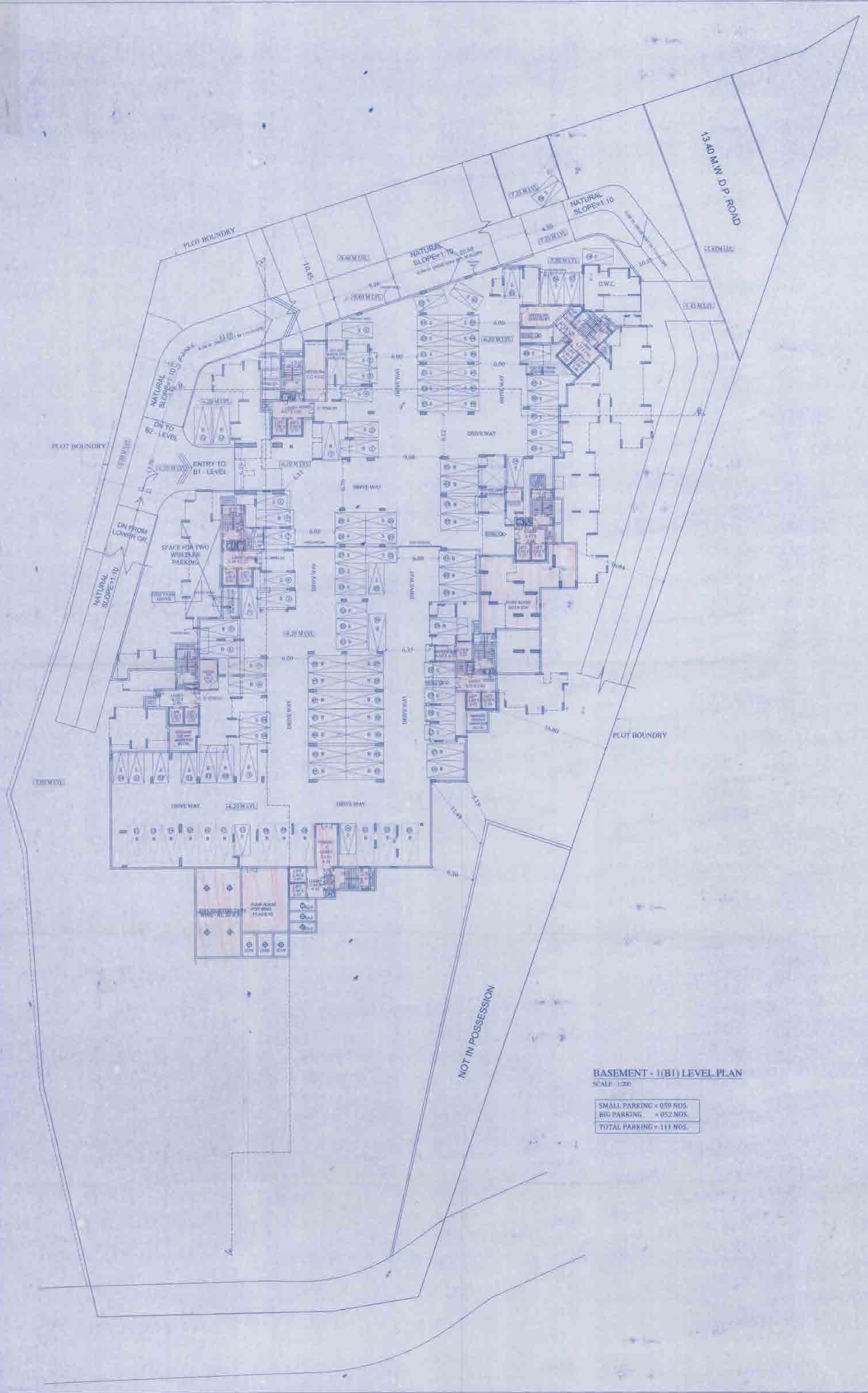

**BASEMENT - 1 (B1) LEVEL PLAN**  
SCALE: 1:200

SMALL PARKING = 059 NOS.  
BIG PARKING = 052 NOS.  
TOTAL PARKING = 111 NOS.

DESCRIPTION OF PROPOSAL & PROPERTY

PROPOSED RECONSTRUCTION WORK ON PLOT NO. 100, 101, 102, 103, 104, 105, 106, 107, 108, 109, 110, 111, 112, 113, 114, 115, 116, 117, 118, 119, 120, 121, 122, 123, 124, 125, 126, 127, 128, 129, 130, 131, 132, 133, 134, 135, 136, 137, 138, 139, 140, 141, 142, 143, 144, 145, 146, 147, 148, 149, 150, 151, 152, 153, 154, 155, 156, 157, 158, 159, 160, 161, 162, 163, 164, 165, 166, 167, 168, 169, 170, 171, 172, 173, 174, 175, 176, 177, 178, 179, 180, 181, 182, 183, 184, 185, 186, 187, 188, 189, 190, 191, 192, 193, 194, 195, 196, 197, 198, 199, 200, 201, 202, 203, 204, 205, 206, 207, 208, 209, 210, 211, 212, 213, 214, 215, 216, 217, 218, 219, 220, 221, 222, 223, 224, 225, 226, 227, 228, 229, 230, 231, 232, 233, 234, 235, 236, 237, 238, 239, 240, 241, 242, 243, 244, 245, 246, 247, 248, 249, 250, 251, 252, 253, 254, 255, 256, 257, 258, 259, 260, 261, 262, 263, 264, 265, 266, 267, 268, 269, 270, 271, 272, 273, 274, 275, 276, 277, 278, 279, 280, 281, 282, 283, 284, 285, 286, 287, 288, 289, 290, 291, 292, 293, 294, 295, 296, 297, 298, 299, 300, 301, 302, 303, 304, 305, 306, 307, 308, 309, 310, 311, 312, 313, 314, 315, 316, 317, 318, 319, 320, 321, 322, 323, 324, 325, 326, 327, 328, 329, 330, 331, 332, 333, 334, 335, 336, 337, 338, 339, 340, 341, 342, 343, 344, 345, 346, 347, 348, 349, 350, 351, 352, 353, 354, 355, 356, 357, 358, 359, 360, 361, 362, 363, 364, 365, 366, 367, 368, 369, 370, 371, 372, 373, 374, 375, 376, 377, 378, 379, 380, 381, 382, 383, 384, 385, 386, 387, 388, 389, 390, 391, 392, 393, 394, 395, 396, 397, 398, 399, 400, 401, 402, 403, 404, 405, 406, 407, 408, 409, 410, 411, 412, 413, 414, 415, 416, 417, 418, 419, 420, 421, 422, 423, 424, 425, 426, 427, 428, 429, 430, 431, 432, 433, 434, 435, 436, 437, 438, 439, 440, 441, 442, 443, 444, 445, 446, 447, 448, 449, 450, 451, 452, 453, 454, 455, 456, 457, 458, 459, 460, 461, 462, 463, 464, 465, 466, 467, 468, 469, 470, 471, 472, 473, 474, 475, 476, 477, 478, 479, 480, 481, 482, 483, 484, 485, 486, 487, 488, 489, 490, 491, 492, 493, 494, 495, 496, 497, 498, 499, 500, 501, 502, 503, 504, 505, 506, 507, 508, 509, 510, 511, 512, 513, 514, 515, 516, 517, 518, 519, 520, 521, 522, 523, 524, 525, 526, 527, 528, 529, 530, 531, 532, 533, 534, 535, 536, 537, 538, 539, 540, 541, 542, 543, 544, 545, 546, 547, 548, 549, 550, 551, 552, 553, 554, 555, 556, 557, 558, 559, 560, 561, 562, 563, 564, 565, 566, 567, 568, 569, 570, 571, 572, 573, 574, 575, 576, 577, 578, 579, 580, 581, 582, 583, 584, 585, 586, 587, 588, 589, 590, 591, 592, 593, 594, 595, 596, 597, 598, 599, 600, 601, 602, 603, 604, 605, 606, 607, 608, 609, 610, 611, 612, 613, 614, 615, 616, 617, 618, 619, 620, 621, 622, 623, 624, 625, 626, 627, 628, 629, 630, 631, 632, 633, 634, 635, 636, 637, 638, 639, 640, 641, 642, 643, 644, 645, 646, 647, 648, 649, 650, 651, 652, 653, 654, 655, 656, 657, 658, 659, 660, 661, 662, 663, 664, 665, 666, 667, 668, 669, 670, 671, 672, 673, 674, 675, 676, 677, 678, 679, 680, 681, 682, 683, 684, 685, 686, 687, 688, 689, 690, 691, 692, 693, 694, 695, 696, 697, 698, 699, 700, 701, 702, 703, 704, 705, 706, 707, 708, 709, 710, 711, 712, 713, 714, 715, 716, 717, 718, 719, 720, 721, 722, 723, 724, 725, 726, 727, 728, 729, 730, 731, 732, 733, 734, 735, 736, 737, 738, 739, 740, 741, 742, 743, 744, 745, 746, 747, 748, 749, 750, 751, 752, 753, 754, 755, 756, 757, 758, 759, 760, 761, 762, 763, 764, 765, 766, 767, 768, 769, 770, 771, 772, 773, 774, 775, 776, 777, 778, 779, 780, 781, 782, 783, 784, 785, 786, 787, 788, 789, 790, 791, 792, 793, 794, 795, 796, 797, 798, 799, 800, 801, 802, 803, 804, 805, 806, 807, 808, 809, 810, 811, 812, 813, 814, 815, 816, 817, 818, 819, 820, 821, 822, 823, 824, 825, 826, 827, 828, 829, 830, 831, 832, 833, 834, 835, 836, 837, 838, 839, 840, 841, 842, 843, 844, 845, 846, 847, 848, 849, 850, 851, 852, 853, 854, 855, 856, 857, 858, 859, 860, 861, 862, 863, 864, 865, 866, 867, 868, 869, 870, 871, 872, 873, 874, 875, 876, 877, 878, 879, 880, 881, 882, 883, 884, 885, 886, 887, 888, 889, 890, 891, 892, 893, 894, 895, 896, 897, 898, 899, 900, 901, 902, 903, 904, 905, 906, 907, 908, 909, 910, 911, 912, 913, 914, 915, 916, 917, 918, 919, 920, 921, 922, 923, 924, 925, 926, 927, 928, 929, 930, 931, 932, 933, 934, 935, 936, 937, 938, 939, 940, 941, 942, 943, 944, 945, 946, 947, 948, 949, 950, 951, 952, 953, 954, 955, 956, 957, 958, 959, 960, 961, 962, 963, 964, 965, 966, 967, 968, 969, 970, 971, 972, 973, 974, 975, 976, 977, 978, 979, 980, 981, 982, 983, 984, 985, 986, 987, 988, 989, 990, 991, 992, 993, 994, 995, 996, 997, 998, 999, 1000

NORTH	JOB NO.	DRG. NO.	DRAWN BY
N	SCALE	DATE	CHECKED BY
	1:200		

REVISIONS: DESCRIPTION

NAME OF THE OWNER  
M/S. BHEEMDRAWAL PVT. LTD.

NAME & ADDRESS OF LICENSED SURVEYOR (L.S.)  
M/S. BHEEMDRAWAL PVT. LTD.



PRODUCED BY AN AUTODESK EDUCATIONAL PRODUCT

PRODUCED BY AN AUTODESK EDUCATIONAL PRODUCT



PROFORMA - B  
 CONTENTS OF SHEET  
 BASEMENT - 2(B2) LEVEL PLAN  
 STAMP OF DATE OF RECEIPT OF PLANS  
 THIS CANCELS APPROVAL OF THE PREVIOUS PLANS SANCTIONED UNDER NO. CHB/A/5183/2016/10/15  
 DATE 24-11-2016  
 CHB/A-5183/2016/10/15  
 APPROVED SUBJECT TO THE CONDITION MENTIONED IN THE ACCOMPANYING LETTER  
 EXECUTIVE ENGINEER (R/O), PROPOSAL  
 RAJAN KUMAR JAIN  
 24 MAY 2016  
 S.E.P.(R/N)

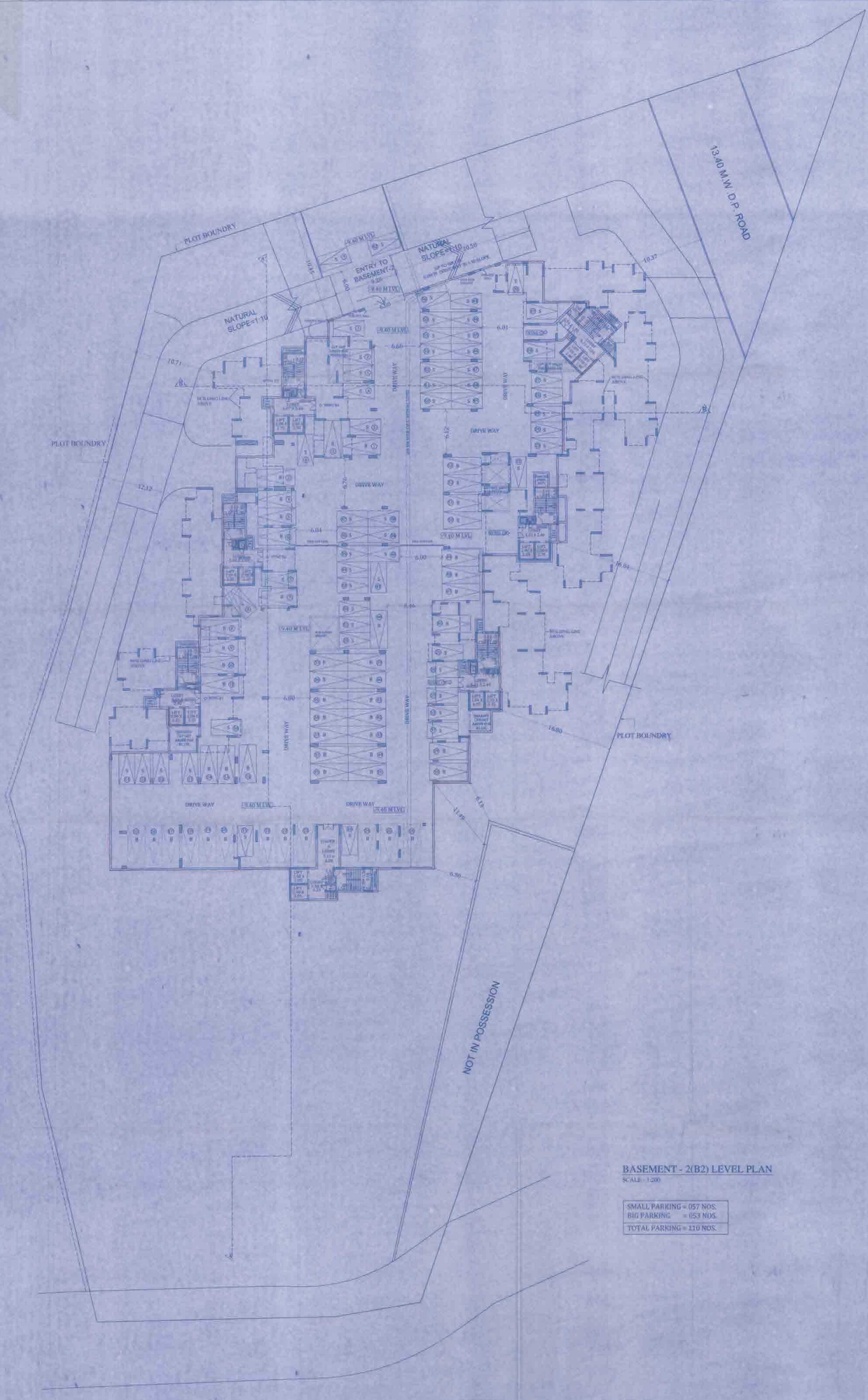

**BASEMENT - 2(B2) LEVEL PLAN**  
 SCALE - 1:200

SMALL PARKING = 057 NOS.  
 BIG PARKING = 053 NOS.  
 TOTAL PARKING = 110 NOS.

STAMP OF DATE OF APPROVAL OF PLAN

DESCRIPTION OF PROPOSAL & PROPERTY			
PROPOSED RESIDENTIAL BLOCK ON PLOT BEARING CTY NO. 740/20 IN VILLAGE DARGA TAL. BHOWALI IN R/WARD BHARAT-400014			
NORTH	JOB NO.	DRG. NO.	DRAWN BY
	SCALE	DATE	CHECKED BY
	1:200		
REVISIONS / DESCRIPTION			
NAME OF THE OWNER			SIGNATURE
M/s. BIRTH INFRAWORLD PVT. LTD.			
NAME & ADDRESS OF LICENSED SURVEYOR (I.S.)			SIGNATURE
 8-246, 1st Floor Building Midland Complex, Link Road Malviya (S) Village, Barmer - 341001			

PRODUCED BY AN AUTODESK EDUCATIONAL PRODUCT

PRODUCED BY AN AUTODESK EDUCATIONAL PRODUCT