

P. H. HOTWANI
 License No. 12703
 State of Maharashtra
 Professional Engineer

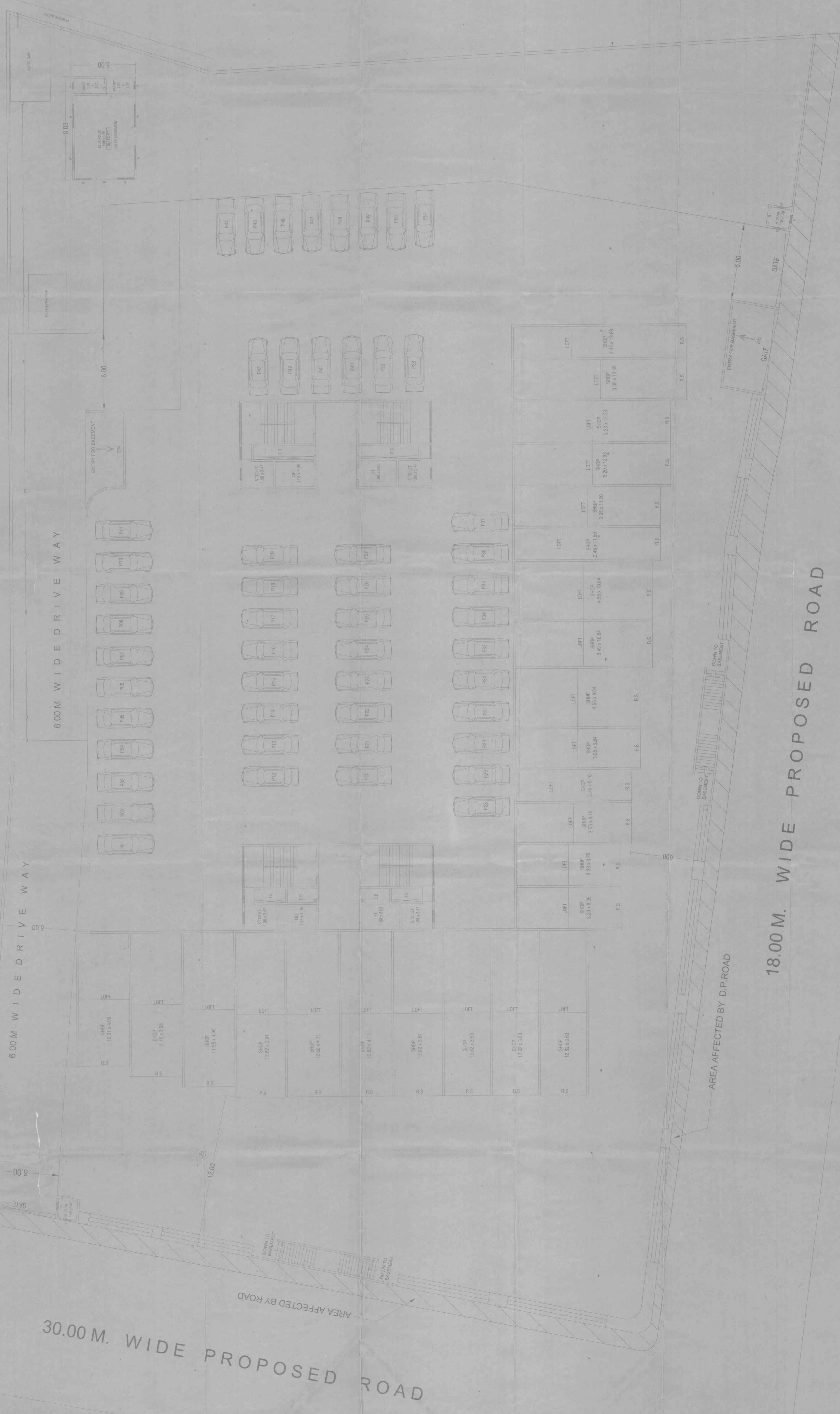

CONTENTS OF SHEET

BASEMENT PLAN

NAME OF OWNER

SHRI GURUDAYAL SINGH PRITAMSINGH
 SHRI GURUBACHAN SINGH CHIAMANSINGH
 SHRI INDERAL DWARKAKADAS MATHANI
 SHRI AJITSINGH CHIAMANSINGH

REVISION

DESCRIPTION

DATE

SIGNATURE

CERTIFICATE OF AREA
 NOTED THAT THE BLUE LINES REFERRED TO ARE SHOWN BY THE
 AND THE DIMENSIONS OF THE SIZES ETC. OF THE PLANT ENTIRE ON THE PLANS ARE AS
 INDICATED THEREON AND THE AREA IS NOT TO BE TAKEN INTO ACCOUNT IN THE
 CALCULATION OF THE TOTAL AREA OF THE PROPERTY.

DESCRIPTION OF PROPOSAL & PROPERTY

P. H. HOTWANI
 License No. 12703
 PROPOSED CONSTRUCTION ON U. NO. 11 & 12, SHEET NO. 31-40
 ULHASNAGAR - 4

JOB No. DATE SCALE AS GIVEN DRAWN BY SHIBANA CHECKED BY

P. H. HOTWANI
 License No. 12703
 HOTWANI & ASSOCIATES
 Civil Engineers
 12703

BASEMENT PLAN
 SCALE 1:100

KITCHEN
 6'6" x 8'6"
 BEDROOM
 11'0" x 9'0"
 BEDROOM
 11'0" x 9'0"
 TERRACE 6'0"