

PLOT AREA STATEMENT AS PER V.P. NO. 91140/2C

Table with 14 columns: S.NO., NAME OF VILLAGE, S.NO., AREA AS PER 7/12 EXTRACT (SQ.MT.), AREA AS PER U.C. ORDER (SQ.MT.), AREA UNDER CONSIDERATION (SQ.MT.), AREA UNDER 40.00 M D.P. ROAD (EAST - WEST) (SQ.MT.), AREA UNDER 40.00 M D.P. ROAD (NORTH - SOUTH) (SQ.MT.), AREA UNDER 25.00 M D.P. ROAD (SQ.MT.), AREA UNDER PLOT "A" (SQ.MT.), AREA UNDER PLOT "B" (SQ.MT.), AREA UNDER PLOT "C" (SQ.MT.), AREA UNDER UNBUILDABLE PLOT (SQ.MT.), and a column for area under consideration.

Table with 11 columns: S.NO., PLOT AREA AS PER TRIANGULATION METHOD (SQ.MT.), PLOT AREA AS PER 7/12 EXTRACT (SQ.MT.), PLOT AREA AS PER U.C. ORDER (SQ.MT.), PLOT AREA UNDER CONSIDERATION (SQ.MT.), GARDEN RESERV. NO. & AREA UNDER PLOT "A", PLOT AREA UNDER CONSIDERATION (SQ.MT.), PLOT AREA UNDER CONSIDERATION (SQ.MT.), PLOT AREA UNDER CONSIDERATION (SQ.MT.), PLOT AREA UNDER CONSIDERATION (SQ.MT.), PLOT AREA UNDER CONSIDERATION (SQ.MT.), and PLOT AREA UNDER CONSIDERATION (SQ.MT.).

PLOT AREA STATEMENT FOR UNBUILDABLE PLOT. Table with 3 columns: S. NO., SURVEY NO., PLOT AREA UNDER PLOT 'A' (SQ.MT.), MAXIMUM AREA OF PLOT 'A' TO BE CONSIDERED (SQ.MT.).

PARKING AS PER REG. DATED 28-08-09

PARKING STATEMENT BLDG-NO. 11, 12, 13, 14, 15 & 16

Table detailing parking requirements for BLDG-NO. 11, 12, 13, 14, 15 & 16. Columns include SR. NO., NAME OF VILLAGE, S.NO., AREA AS PER 7/12 EXTRACT (SQ.MT.), AREA AS PER U.C. ORDER (SQ.MT.), AREA UNDER CONSIDERATION (SQ.MT.), AREA UNDER 40.00 M D.P. ROAD (EAST - WEST) (SQ.MT.), AREA UNDER 40.00 M D.P. ROAD (NORTH - SOUTH) (SQ.MT.), AREA UNDER 25.00 M D.P. ROAD (SQ.MT.), AREA UNDER PLOT "A" (SQ.MT.), AREA UNDER PLOT "B" (SQ.MT.), AREA UNDER PLOT "C" (SQ.MT.), AREA UNDER UNBUILDABLE PLOT (SQ.MT.), and a column for area under consideration.

PLOT AREA STATEMENT AS PER V.P. NO. 2004/27

Table with 7 columns: S. NO., SURVEY NO., PLOT AREA AS PER TRIANGULATION METHOD (SQ.MT.), PLOT AREA AS PER 7/12 EXTRACT (SQ.MT.), PLOT AREA AS PER U.C. ORDER (SQ.MT.), AREA UNDER 25.00 M D.P. ROAD (IN SQ.MT.), AREA UNDER 40.00 M D.P. ROAD (IN SQ.MT.), and PLOT AREA UNDER CONSIDERATION (IN SQ.MT.).

AREA STATEMENT FOR AMENITY SPACE. Table with 2 columns: S. NO. and AREA STATEMENT FOR AMENITY SPACE. Includes items like 1. REQUIRED AMENITY SPACE AREA, 2. ALREADY PROVIDED AMENITY SPACE, etc.

AREA CALC. FOR PROPOSED AMENITY SPACE FOR 5.5 R. Table with 6 columns: No. of cars, Size (m x m), Area (sq. m), No. of cars, Size (m x m), Area (sq. m).

PARKING STATEMENT (FOR O.C. OBTAINED BLDGS)

Table with 4 columns: PLOT - A, PLOT - B, PLOT - C, PLOT - D. Columns include NO. OF TENEMENTS, NO. OF CAR PARKING REQUIRED, NO. OF CAR PARKING PROVIDED, and NO. OF VISITORS PARKING.

PROPOSED TENEMENT & PARKING STATEMENT

Table with 6 columns: SR. NO., BLDG. NO., NO. OF TENEMENTS, NO. OF CAR PARKING PROVIDED, NO. OF VISITORS PARKING, and AREA OF PARKING (sq.m).

AREA UNDER CONSIDERATION = 37150.00 SQ.MT AS PER V.P. NO. 2004/27. 9404.125. 4-W PARKING 349 NORS.

AREA STATEMENT FOR T.D.R.

Table with 7 columns: SR. NO., NAME OF VILLAGE, SECTOR NO., S. NO./J. NO., RES. NO., RESERVATION NAME, AREA OF TDR APPROVED, CERTIFICATE NO., AREA UTILIZATION, and SECTOR NO.

AREA STATEMENT FOR MHADA AS PER CIRCULAR DT. 08-11-13

Table with 4 columns: SR. NO., NAME OF VILLAGE, SECTOR NO., S. NO./J. NO., RES. NO., RESERVATION NAME, AREA OF TDR APPROVED, CERTIFICATE NO., AREA UTILIZATION, and SECTOR NO.

AREA UNDER CONSIDERATION - PLOT - B

AREA UNDER CONSIDERATION - PLOT - B = 29726.875 SQ.MT AS PER V.P. NO. 91140/2C

AREA UNDER CONSIDERATION - PLOT - A

AREA UNDER CONSIDERATION - PLOT - A = 29726.875 + 37150.00 + 37590.00 = 1,04,466.875 SQ.MT

AREA UNDER CONSIDERATION - PLOT - C

AREA UNDER CONSIDERATION - PLOT - C = 29726.875 + 37150.00 + 37590.00 = 1,04,466.875 SQ.MT

AREA UNDER CONSIDERATION - PLOT - D

AREA UNDER CONSIDERATION - PLOT - D = 29726.875 + 37150.00 + 37590.00 = 1,04,466.875 SQ.MT

AREA UNDER CONSIDERATION - PLOT - E

AREA UNDER CONSIDERATION - PLOT - E = 29726.875 + 37150.00 + 37590.00 = 1,04,466.875 SQ.MT

AREA UNDER CONSIDERATION - PLOT - F

AREA UNDER CONSIDERATION - PLOT - F = 29726.875 + 37150.00 + 37590.00 = 1,04,466.875 SQ.MT

AREA UNDER CONSIDERATION - PLOT - G

AREA UNDER CONSIDERATION - PLOT - G = 29726.875 + 37150.00 + 37590.00 = 1,04,466.875 SQ.MT

AREA UNDER CONSIDERATION - PLOT - H

AREA UNDER CONSIDERATION - PLOT - H = 29726.875 + 37150.00 + 37590.00 = 1,04,466.875 SQ.MT

AREA UNDER CONSIDERATION - PLOT - I

AREA UNDER CONSIDERATION - PLOT - I = 29726.875 + 37150.00 + 37590.00 = 1,04,466.875 SQ.MT

AREA UNDER CONSIDERATION - PLOT - J

AREA UNDER CONSIDERATION - PLOT - J = 29726.875 + 37150.00 + 37590.00 = 1,04,466.875 SQ.MT

AREA UNDER CONSIDERATION - PLOT - K

AREA UNDER CONSIDERATION - PLOT - K = 29726.875 + 37150.00 + 37590.00 = 1,04,466.875 SQ.MT

AREA UNDER CONSIDERATION - PLOT - L

AREA UNDER CONSIDERATION - PLOT - L = 29726.875 + 37150.00 + 37590.00 = 1,04,466.875 SQ.MT

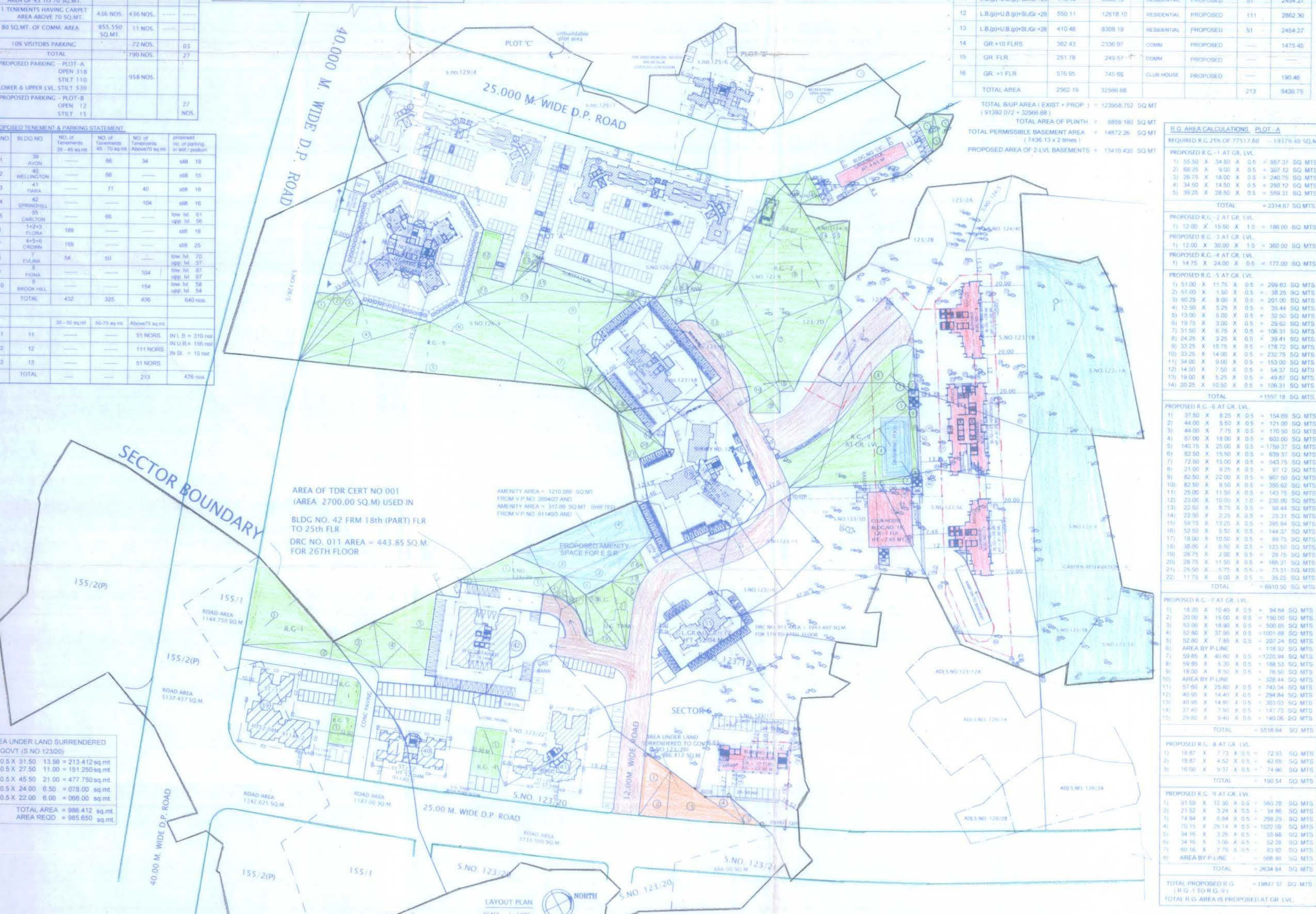

BUILT-UP AREA STATEMENT FOR PLOT 'A'

Table with 9 columns: SR. NO., BLDG. NO., FLOORS, PLINTH AREA (SQ.MT.), TOTAL B.U. AREA (SQ.MT.), USE, STATUS, NO. OF TENEMENTS, STAIRCASE AREA (SQ.MT.).

BUILT-UP AREA OF NEWLY PROPOSED BLDGS

Table with 9 columns: BLDG. NO., FLOORS, PLINTH AREA (SQ.MT.), TOTAL B.U. AREA (SQ.MT.), USE, STATUS, NO. OF TENEMENTS, STAIRCASE AREA (SQ.MT.).

B.G. AREA CALCULATIONS - PLOT - A

Table with 2 columns: B.G. AREA CALCULATIONS (SQ.MT.) and PLOT - A. Lists various calculations for plot area.

PROPOSED B.G. - 6 AT GR. LVL

Table with 2 columns: B.G. AREA CALCULATIONS (SQ.MT.) and PLOT - A. Lists various calculations for plot area.

PROPOSED B.G. - 8 AT GR. LVL

Table with 2 columns: B.G. AREA CALCULATIONS (SQ.MT.) and PLOT - A. Lists various calculations for plot area.

PROPOSED B.G. - 9 AT GR. LVL

Table with 2 columns: B.G. AREA CALCULATIONS (SQ.MT.) and PLOT - A. Lists various calculations for plot area.

PROFORMA - A

PROFORMA - B

Table with 2 columns: AREA STATEMENT and SQ.MTS. Includes items like AREA OF PLOT, DEDUCTIONS FOR ROAD, etc.

Table with 2 columns: AREA OF CERTIFICATE NO. 001, V.P. NO. 91140/2C. Includes items like AREA OF CERTIFICATE NO. 001, etc.

Table with 2 columns: AREA OF CERTIFICATE NO. 010, V.P. NO. 2004/27. Includes items like AREA OF CERTIFICATE NO. 010, etc.

Table with 2 columns: AREA OF CERTIFICATE NO. 197 (Reservation). Includes items like AREA OF CERTIFICATE NO. 197, etc.

Table with 2 columns: AREA OF CERTIFICATE NO. 011, V.P. NO. 91140/2C. Includes items like AREA OF CERTIFICATE NO. 011, etc.

Table with 2 columns: AREA OF CERTIFICATE NO. 012, V.P. NO. 2004/27. Includes items like AREA OF CERTIFICATE NO. 012, etc.

Table with 2 columns: AREA OF CERTIFICATE NO. 197 (Reservation). Includes items like AREA OF CERTIFICATE NO. 197, etc.

Table with 2 columns: AREA OF CERTIFICATE NO. 011, V.P. NO. 91140/2C. Includes items like AREA OF CERTIFICATE NO. 011, etc.

Table with 2 columns: AREA OF CERTIFICATE NO. 012, V.P. NO. 2004/27. Includes items like AREA OF CERTIFICATE NO. 012, etc.

Table with 2 columns: AREA OF CERTIFICATE NO. 197 (Reservation). Includes items like AREA OF CERTIFICATE NO. 197, etc.

Table with 2 columns: AREA OF CERTIFICATE NO. 011, V.P. NO. 91140/2C. Includes items like AREA OF CERTIFICATE NO. 011, etc.

CONTENTS OF SHEET

Table with 2 columns: AREA STATEMENT, SQ.MTS. Includes items like AREA OF PLOT, DEDUCTIONS FOR ROAD, etc.

Table with 2 columns: AREA OF CERTIFICATE NO. 001, V.P. NO. 91140/2C. Includes items like AREA OF CERTIFICATE NO. 001, etc.

Table with 2 columns: AREA OF CERTIFICATE NO. 010, V.P. NO. 2004/27. Includes items like AREA OF CERTIFICATE NO. 010, etc.

Table with 2 columns: AREA OF CERTIFICATE NO. 197 (Reservation). Includes items like AREA OF CERTIFICATE NO. 197, etc.

Table with 2 columns: AREA OF CERTIFICATE NO. 011, V.P. NO. 91140/2C. Includes items like AREA OF CERTIFICATE NO. 011, etc.

Table with 2 columns: AREA OF CERTIFICATE NO. 012, V.P. NO. 2004/27. Includes items like AREA OF CERTIFICATE NO. 012, etc.

Table with 2 columns: AREA OF CERTIFICATE NO. 197 (Reservation). Includes items like AREA OF CERTIFICATE NO. 197, etc.

Table with 2 columns: AREA OF CERTIFICATE NO. 011, V.P. NO. 91140/2C. Includes items like AREA OF CERTIFICATE NO. 011, etc.

Table with 2 columns: AREA OF CERTIFICATE NO. 012, V.P. NO. 2004/27. Includes items like AREA OF CERTIFICATE NO. 012, etc.

Table with 2 columns: AREA OF CERTIFICATE NO. 197 (Reservation). Includes items like AREA OF CERTIFICATE NO. 197, etc.

Table with 2 columns: AREA OF CERTIFICATE NO. 011, V.P. NO. 91140/2C. Includes items like AREA OF CERTIFICATE NO. 011, etc.



PROFORMA - A. Title block for the planning application form.

PROFORMA - B. Title block for the planning application form.

PROFORMA - C. Title block for the planning application form.

PROFORMA - D. Title block for the planning application form.

PROFORMA - E. Title block for the planning application form.

PROFORMA - F. Title block for the planning application form.

PROFORMA - G. Title block for the planning application form.